

**APR1400**  
**DESIGN CONTROL DOCUMENT TIER 2**

**CHAPTER 3**  
**DESIGN OF STRUCTURES, SYSTEMS,**  
**COMPONENTS, AND EQUIPMENT**

**APR1400-K-X-FS-13002**  
**REVISION 0**  
**SEPTEMBER 2013**

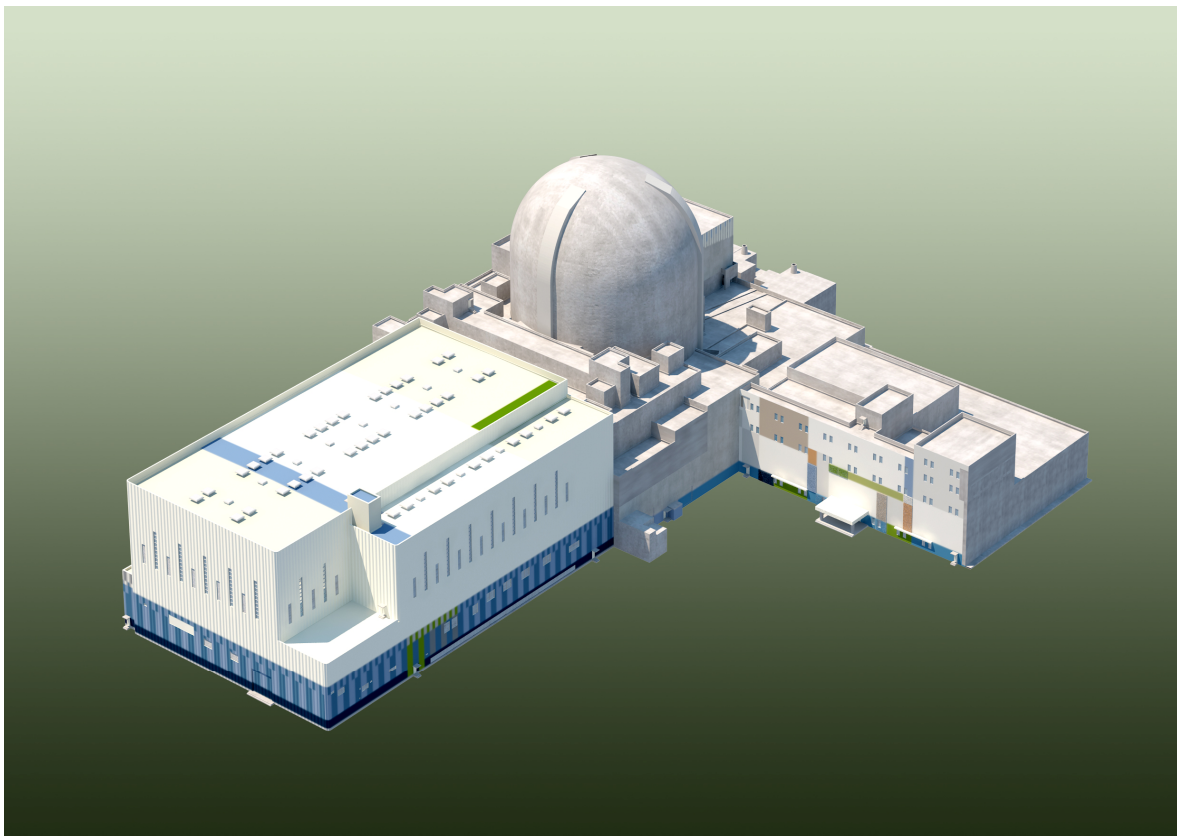

© 2013

KEPCO and KHNP

All Rights Reserved

This document was prepared for the design certification application to the U.S. Nuclear Regulatory Commission and contains technological information that constitutes intellectual property.

Copying, using, or distributing the information in this document in whole or in part is permitted only by the U.S. Nuclear Regulatory Commission and its contractors for the purpose of reviewing design certification application materials. Other uses are strictly prohibited without the written permission of Korea Electric Power Corporation and Korea Hydro & Nuclear Power Co., Ltd.

**CHAPTER 3 – DESIGN OF STRUCTURES, SYSTEMS,  
COMPONENTS, AND EQUIPMENT**

**TABLE OF CONTENTS**

<u>NUMBER</u>	<u>TITLE</u>	<u>PAGE</u>
<b>CHAPTER 3 – DESIGN OF STRUCTURES, SYSTEMS, COMPONENTS, AND EQUIPMENT .....</b>		<b>3.1-1</b>
<b>3.1 Conformance with Nuclear Regulatory Commission General Design Criteria.....</b>		<b>3.1-1</b>
3.1.1	Criterion 1 – Quality Standards and Records .....	3.1-1
3.1.2	Criterion 2 – Design Bases for Protection Against Natural Phenomena .....	3.1-2
3.1.3	Criterion 3 – Fire Protection.....	3.1-2
3.1.4	Criterion 4 – Environmental and Dynamic Effects Design Bases .....	3.1-3
3.1.5	Criterion 5 – Sharing of Structures, Systems, and Components .....	3.1-4
3.1.6	Criterion 10 – Reactor Design.....	3.1-4
3.1.7	Criterion 11 – Reactor Inherent Protection .....	3.1-5
3.1.8	Criterion 12 – Suppression of Reactor Power Oscillations .....	3.1-5
3.1.9	Criterion 13 – Instrumentation and Control .....	3.1-6
3.1.10	Criterion 14 – Reactor Coolant Pressure Boundary .....	3.1-8
3.1.11	Criterion 15 – Reactor Coolant System Design .....	3.1-9
3.1.12	Criterion 16 – Containment Design.....	3.1-10
3.1.13	Criterion 17 – Electrical Power Systems.....	3.1-11
3.1.14	Criterion 18 – Inspection and Testing of Electrical Power Systems.....	3.1-12
3.1.15	Criterion 19 – Control Room.....	3.1-13
3.1.16	Criterion 20 – Protection System Functions.....	3.1-14
3.1.17	Criterion 21 – Protection System Reliability and Testability.....	3.1-16
3.1.18	Criterion 22 – Protection System Independence .....	3.1-16
3.1.19	Criterion 23 – Protection System Failure Modes .....	3.1-18
3.1.20	Criterion 24 – Separation of Protection and Control Systems .....	3.1-18
3.1.21	Criterion 25 – Protection System Requirements for Reactivity Control Malfunctions .....	3.1-19

## APR1400 DCD TIER 2

3.1.22	Criterion 26 – Reactivity Control System Redundancy and Capability .....	3.1-20
3.1.23	Criterion 27 – Combined Reactivity Control Systems Capability .....	3.1-21
3.1.24	Criterion 28 – Reactivity Limits.....	3.1-21
3.1.25	Criterion 29 – Protection Against Anticipated Operational Occurrences .....	3.1-22
3.1.26	Criterion 30 – Quality of Reactor Coolant Pressure Boundary .....	3.1-23
3.1.27	Criterion 31 – Fracture Prevention of Reactor Coolant Pressure Boundary .....	3.1-23
3.1.28	Criterion 32 – Inspection of Reactor Coolant Pressure Boundary .....	3.1-25
3.1.29	Criterion 33 – Reactor Coolant Makeup .....	3.1-25
3.1.30	Criterion 34 – Residual Heat Removal.....	3.1-26
3.1.31	Criterion 35 – Emergency Core Cooling.....	3.1-27
3.1.32	Criterion 36 – Inspection of Emergency Core Cooling System.....	3.1-29
3.1.33	Criterion 37 – Testing of Emergency Core Cooling System.....	3.1-29
3.1.34	Criterion 38 – Containment Heat Removal .....	3.1-30
3.1.35	Criterion 39 – Inspection of Containment Heat Removal System .....	3.1-31
3.1.36	Criterion 40 – Testing of Containment Heat Removal System.....	3.1-31
3.1.37	Criterion 41 – Containment Atmosphere Cleanup .....	3.1-32
3.1.38	Criterion 42 – Inspection of Containment Atmosphere Cleanup Systems.....	3.1-33
3.1.39	Criterion 43 – Testing of Containment Atmosphere Cleanup Systems.....	3.1-34
3.1.40	Criterion 44 – Cooling Water .....	3.1-35
3.1.41	Criterion 45 – Inspection of Cooling Water System .....	3.1-35
3.1.42	Criterion 46 – Testing of Cooling Water System.....	3.1-36
3.1.43	Criterion 50 – Containment Design Basis.....	3.1-37
3.1.44	Criterion 51 – Fracture Prevention of Containment Pressure Boundary .....	3.1-38
3.1.45	Criterion 52 – Capability for Containment Leakage Rate Testing.....	3.1-38
3.1.46	Criterion 53 – Provisions for Containment Testing and Inspection.....	3.1-39
3.1.47	Criterion 54 – Piping Systems Penetrating Containment.....	3.1-39
3.1.48	Criterion 55 – Reactor Coolant Pressure Boundary Penetrating Containment .....	3.1-40

## APR1400 DCD TIER 2

3.1.49	Criterion 56 – Primary Containment Isolation .....	3.1-41
3.1.50	Criterion 57 – Closed System Isolation Valves.....	3.1-42
3.1.51	Criterion 60 – Control of Releases of Radioactive Material to the Environment .....	3.1-43
3.1.52	Criterion 61 – Fuel Storage and Handling and Radioactivity Control.....	3.1-43
3.1.53	Criterion 62 – Prevention of Criticality in Fuel Storage and Handling .....	3.1-44
3.1.54	Criterion 63 – Monitoring Fuel and Waste Storage .....	3.1-45
3.1.55	Criterion 64 – Monitoring Radioactivity Releases.....	3.1-46
3.1.56	Combined License Information.....	3.1-47
3.1.57	References .....	3.1-47
<b>3.2</b>	<b>Classification of Structures, Systems, and Components .....</b>	<b>3.2-1</b>
3.2.1	Seismic Classification .....	3.2-2
3.2.2	System Quality Group Classification .....	3.2-5
3.2.3	Safety Class .....	3.2-9
3.2.4	Classification Listings .....	3.2-13
3.2.5	Combined License Information.....	3.2-13
3.2.6	References .....	3.2-13
<b>3.3</b>	<b>Wind and Tornado Loadings.....</b>	<b>3.3-1</b>
3.3.1	Wind Loadings .....	3.3-1
3.3.1.1	Design Wind Velocity and Recurrence Interval.....	3.3-1
3.3.1.2	Determination of Applied Forces .....	3.3-1
3.3.2	Tornado Loadings.....	3.3-2
3.3.2.1	Applicable Design Parameters .....	3.3-2
3.3.2.2	Determination of Forces on Structures.....	3.3-3
3.3.2.3	Effect of Failure of Structures or Components Not Designed for Extreme Wind Loads .....	3.3-4
3.3.3	Combined License Information.....	3.3-5
3.3.4	References .....	3.3-5
<b>3.4</b>	<b>Water Level (Flood) Design .....</b>	<b>3.4-1</b>
3.4.1	Flood Protection and Evaluation .....	3.4-1

## APR1400 DCD TIER 2

3.4.1.1	Design Bases .....	3.4-1
3.4.1.2	Flood Protection from External Sources .....	3.4-1
3.4.1.3	Flood Protection from Internal Sources .....	3.4-3
3.4.1.4	Evaluation of External Flooding .....	3.4-5
3.4.1.5	Evaluation of Internal Flooding .....	3.4-5
3.4.2	Analysis Procedures .....	3.4-16
3.4.3	Combined License Information.....	3.4-16
3.4.4	References .....	3.4-17
<b>3.5</b>	<b>Missile Protection.....</b>	<b>3.5-1</b>
3.5.1	Missile Selection and Description.....	3.5-1
3.5.1.1	Internally Generated Missiles (Outside the Containment) .....	3.5-2
3.5.1.2	Internally Generated Missiles (Inside Containment).....	3.5-7
3.5.1.3	Turbine Missiles .....	3.5-10
3.5.1.4	Missiles Generated by Tornadoes and Extreme Winds.....	3.5-12
3.5.1.5	Site Proximity Missiles (Except Aircraft).....	3.5-13
3.5.1.6	Aircraft Hazards .....	3.5-13
3.5.2	Structures, Systems, and Components to be Protected from Externally Generated Missiles.....	3.5-14
3.5.3	Barrier Design Procedures.....	3.5-14
3.5.3.1	Evaluation of Local Structural Effects .....	3.5-14
3.5.3.2	Overall Damage Prediction .....	3.5-19
3.5.4	Combined License Information.....	3.5-19
3.5.5	References .....	3.5-20
<b>3.6</b>	<b>Protection against Dynamic Effects Associated with the Postulated Rupture of Piping .....</b>	<b>3.6-1</b>
3.6.1	Plant Design for Protection against Postulated Piping Failures in Fluid Systems Inside and Outside the Containment.....	3.6-2
3.6.1.1	Design Basis .....	3.6-2
3.6.1.2	Safety Evaluation .....	3.6-6
3.6.1.3	Postulated Failures Associated with Site-Specific Piping.....	3.6-8

## APR1400 DCD TIER 2

3.6.2	Determination of Break Locations and Dynamic Effects Associated with the Postulated Rupture of Piping .....	3.6-9
3.6.2.1	Criteria Used to Define Rupture Locations and Configurations .....	3.6-9
3.6.2.2	Guard Pipe Assembly Design Criteria .....	3.6-18
3.6.2.3	Analytical Methods to Define Forcing Functions and Response Models.....	3.6-19
3.6.2.4	Dynamic Analysis Methods to Verify Integrity and Operability.....	3.6-22
3.6.2.5	Implementation of Criteria Dealing with Special Features .....	3.6-26
3.6.3	Leak-Before-Break Evaluation Procedure .....	3.6-26
3.6.3.1	Applicability of Leak-Before-Break .....	3.6-27
3.6.3.2	Leakage Crack Location.....	3.6-33
3.6.3.3	Leak Detection .....	3.6-34
3.6.3.4	Material Properties .....	3.6-35
3.6.3.5	Leakage Crack Length Determination .....	3.6-36
3.6.3.6	Finite Element Model Description .....	3.6-36
3.6.3.7	Stability Evaluation .....	3.6-37
3.6.3.8	Piping Evaluation Diagram .....	3.6-39
3.6.3.9	Results .....	3.6-41
3.6.4	Combined License Information.....	3.6-43
3.6.5	References .....	3.6-43
<b>3.7</b>	<b>Seismic Design .....</b>	<b>3.7-1</b>
3.7.1	Seismic Design Parameters .....	3.7-1
3.7.1.1	Design Ground Motion.....	3.7-2
3.7.1.2	Percentage of Critical Damping Values .....	3.7-7
3.7.1.3	Supporting Media for Seismic Category I Structures .....	3.7-8
3.7.2	Seismic System Analysis.....	3.7-8
3.7.2.1	Seismic Analysis Methods .....	3.7-9
3.7.2.2	Natural Frequencies and Responses .....	3.7-13
3.7.2.3	Procedures Used for Analytical Modeling .....	3.7-14
3.7.2.4	Soil-Structure Interaction .....	3.7-18

## APR1400 DCD TIER 2

3.7.2.5	Development of In-structure Response Spectra .....	3.7-18
3.7.2.6	Three Components of Earthquake Motion .....	3.7-19
3.7.2.7	Combination of Modal Responses .....	3.7-20
3.7.2.8	Interaction of Non-Seismic Category I Structures with Seismic Category I Structures .....	3.7-21
3.7.2.9	Effects of Parameter Variations on Floor Response Spectra .....	3.7-22
3.7.2.10	Use of Constant Vertical Static Factors .....	3.7-22
3.7.2.11	Methods Used To Account for Torsional Effects .....	3.7-23
3.7.2.12	Comparison of Responses .....	3.7-23
3.7.2.13	Methods for Seismic Analysis of Dams .....	3.7-23
3.7.2.14	Determination of Dynamic Stability of Seismic Category I Structures .....	3.7-23
3.7.2.15	Analysis Procedure for Damping .....	3.7-24
3.7.3	Seismic Subsystem Analysis .....	3.7-25
3.7.3.1	Seismic Analysis Methods .....	3.7-25
3.7.3.2	Procedure Used for Analytical Modeling.....	3.7-26
3.7.3.3	Analysis Procedures for Damping.....	3.7-26
3.7.3.4	Three Components of Earthquake Motion .....	3.7-26
3.7.3.5	Combination of Modal Responses .....	3.7-26
3.7.3.6	Use of Constant Vertical Static Factors .....	3.7-27
3.7.3.7	Buried Seismic Category I Piping, Conduits, and Tunnels .....	3.7-27
3.7.3.8	Methods for Seismic Analysis of Category I Concrete Dams.....	3.7-28
3.7.3.9	Methods for Seismic Analysis of Above-ground Tanks .....	3.7-28
3.7.4	Seismic Instrumentation .....	3.7-29
3.7.4.1	Comparison with NRC RG 1.12 .....	3.7-29
3.7.4.2	Location and Description of Instrumentation.....	3.7-29
3.7.4.3	Main Control Room Operator Notification .....	3.7-30
3.7.4.4	Comparison of NRC RG 1.166 .....	3.7-30
3.7.4.5	Instrument Surveillance.....	3.7-30



## APR1400 DCD TIER 2

3.7.4.6	Program Implementation .....	3.7-31
3.7.5	Combined License Information .....	3.7-31
3.7.6	References .....	3.7-32

### **APPENDIX 3.7A - Soil-Structure Interaction Analysis Methodology and Results .....3.7A-1**

### **APPENDIX 3.7B - Evaluation for High Frequency Seismic Input..... 3.7B-1**

### **3.8 Design of Category I Structures .....3.8-1**

3.8.1	Concrete Containment .....	3.8-1
3.8.1.1	Description of the Containment .....	3.8-1
3.8.1.2	Applicable Codes, Standards, and Specifications .....	3.8-5
3.8.1.3	Loads and Load Combinations.....	3.8-6
3.8.1.4	Design and Analysis Procedures .....	3.8-13
3.8.1.5	Structural Acceptance Criteria .....	3.8-20
3.8.1.6	Materials, Quality Control, and Special Construction Techniques.....	3.8-31
3.8.1.7	Testing and Inservice Inspection Requirements.....	3.8-34
3.8.2	Steel Containment .....	3.8-38
3.8.2.1	Description of Containment .....	3.8-38
3.8.2.2	Applicable Codes, Standards, and Specifications .....	3.8-41
3.8.2.3	Loads and Load Combinations.....	3.8-41
3.8.2.4	Design and Analysis Procedures .....	3.8-43
3.8.2.5	Structural Acceptance Criteria .....	3.8-43
3.8.2.6	Materials, Quality Control, and Special Construction Techniques.....	3.8-44
3.8.2.7	Testing and Inservice Inspection Requirements.....	3.8-45
3.8.3	Concrete and Steel Internal Structures of Steel or Concrete Containment .....	3.8-45
3.8.3.1	Description of the Internal Structures .....	3.8-45
3.8.3.2	Applicable Codes, Standards, and Specifications .....	3.8-51
3.8.3.3	Loads and Load Combinations.....	3.8-52
3.8.3.4	Design and Analysis Procedures .....	3.8-53
3.8.3.5	Structural Acceptance Criteria .....	3.8-54

## APR1400 DCD TIER 2

3.8.3.6	Materials, Quality Control, and Special Construction Techniques.....	3.8-54
3.8.3.7	Testing and Inservice Inspection Requirements.....	3.8-56
3.8.4	Other Seismic Category I Structures .....	3.8-56
3.8.4.1	Description of the Structures .....	3.8-56
3.8.4.2	Applicable Codes, Standards, and Specifications .....	3.8-59
3.8.4.3	Loads and Load Combinations.....	3.8-60
3.8.4.4	Design and Analysis Procedures .....	3.8-69
3.8.4.5	Structural Acceptance Criteria .....	3.8-73
3.8.4.6	Material, Quality Control, and Special Construction Techniques.....	3.8-74
3.8.4.7	Testing and Inservice Inspection Requirements.....	3.8-79
3.8.5	Foundations .....	3.8-79
3.8.5.1	Description of the Foundations .....	3.8-79
3.8.5.2	Applicable Codes, Standards, and Specifications .....	3.8-80
3.8.5.3	Loads and Load Combinations.....	3.8-80
3.8.5.4	Design and Analysis Procedures .....	3.8-80
3.8.5.5	Structural Acceptance Criteria .....	3.8-82
3.8.5.6	Material, Quality Control, and Special Construction Techniques.....	3.8-84
3.8.5.7	Testing and Inservice Inspection Requirements.....	3.8-85
3.8.6	Combined License Information.....	3.8-85
3.8.7	References .....	3.8-86
<b>APPENDIX 3.8A – Structural Design Summary .....</b>		<b>3.8A-1</b>
<b>3.9</b>	<b>Mechanical Systems and Components.....</b>	<b>3.9-1</b>
3.9.1	Special Topics for Mechanical Components.....	3.9-1
3.9.1.1	Design Transients .....	3.9-1
3.9.1.2	Computer Programs Used in Stress Analyses .....	3.9-22
3.9.1.3	Experimental Stress Analyses .....	3.9-29
3.9.1.4	Consideration for the Evaluation of the Faulted Condition .....	3.9-29

## APR1400 DCD TIER 2

3.9.2	Dynamic Testing and Analysis of Systems, Components, and Equipment .....	3.9-31
3.9.2.1	Piping Vibration, Thermal Expansion, and Dynamic Effects.....	3.9-31
3.9.2.2	Seismic Analysis and Qualification of Seismic Category I Mechanical Equipment.....	3.9-35
3.9.2.3	Dynamic Response Analysis for Reactor Internals under Operational Flow Transients and Steady-State Conditions .....	3.9-38
3.9.2.4	Preoperational Flow Induced Vibration Testing of Reactor Internals.....	3.9-42
3.9.2.5	Dynamic System Analysis of the Reactor Internals under Faulted Conditions .....	3.9-44
3.9.2.6	Correlations of Reactor Internals Vibration Tests with the Analytical Results.....	3.9-51
3.9.2.7	Dynamic System Analysis of the CEDM.....	3.9-51
3.9.3	ASME Code Class 1, 2 and 3 Components, Component Supports and Class CS Core Support Structures .....	3.9-52
3.9.3.1	Loading Combinations, Design Transients, and Stress Limits.....	3.9-54
3.9.3.2	Design and Installation of Pressure-Relief Devices .....	3.9-59
3.9.3.3	Pump and Valve Operability Assurance .....	3.9-61
3.9.3.4	Component Supports .....	3.9-67
3.9.4	Control Element Drive Mechanisms .....	3.9-69
3.9.4.1	Descriptive Information of Control Element Drive Mechanism .....	3.9-69
3.9.4.2	Applicable CEDM Design Specifications .....	3.9-74
3.9.4.3	Design Loads, Stress Limits and Allowable Deformations .....	3.9-74
3.9.4.4	CEDM Operability Assurance Program.....	3.9-75
3.9.5	Reactor Pressure Vessel Internals .....	3.9-77
3.9.5.1	Design Arrangements .....	3.9-77
3.9.5.2	Loading Conditions .....	3.9-83
3.9.5.3	Design Bases for Reactor Internals .....	3.9-86

## APR1400 DCD TIER 2

3.9.6	Functional Design, Qualification, and Inservice Testing Programs for Pumps, Valves, and Dynamic Restraints.....	3.9-88
3.9.6.1	Functional Design and Qualification of Pumps, Valves, and Dynamic Restraints .....	3.9-88
3.9.6.2	Inservice Testing Program for Pumps .....	3.9-89
3.9.6.3	Inservice Testing Program for Valves.....	3.9-91
3.9.6.4	Inservice Testing Program for Dynamic Restraints .....	3.9-98
3.9.6.5	Relief Requests and Alternative Authorizations to ASME OM Code .....	3.9-99
3.9.7	[Reserved] .....	3.9-99
3.9.8	[Reserved] .....	3.9-100
3.9.9	Combined License Information.....	3.9-100
3.9.10	References .....	3.9-101

### **APPENDIX 3.9A – Supplemental Information on Criteria and Analysis of The APR1400 Distribution Systems .....3.9A-1**

<b>3.10</b>	<b>Seismic and Dynamic Qualification of Mechanical and Electrical Equipment .....</b>	<b>3.10-1</b>
3.10.1	Seismic Qualification Criteria .....	3.10-2
3.10.1.1	Qualification Codes and Standards .....	3.10-3
3.10.1.2	Input Motion.....	3.10-4
3.10.1.3	Selection of Qualification Method .....	3.10-5
3.10.2	Methods and Procedures for Qualifying Mechanical and Electrical Equipment and Instrumentation .....	3.10-6
3.10.2.1	Qualification by Analysis.....	3.10-6
3.10.2.2	Qualification by Test.....	3.10-9
3.10.2.3	Operability of Active Equipment .....	3.10-10
3.10.3	Methods and Procedures of Analysis or Testing of Supports of Mechanical and Electrical Equipment and Instrumentation.....	3.10-13
3.10.4	Test and Analyses Results and Experience Database .....	3.10-14
3.10.4.1	Implementation Program and Milestones.....	3.10-15
3.10.4.2	Experience-based Qualification .....	3.10-15
3.10.5	Combined License Information.....	3.10-15
3.10.6	References .....	3.10-16

## APR1400 DCD TIER 2

<b>3.11</b>	<b>Environmental Qualification of Mechanical and Electrical Equipment.....</b>	<b>3.11-1</b>
3.11.1	Equipment Location and Environmental Conditions .....	3.11-1
3.11.1.1	Equipment Identification and Location .....	3.11-1
3.11.1.2	Definition of Environmental Conditions .....	3.11-2
3.11.1.3	Equipment Operability Times .....	3.11-3
3.11.2	Qualification Tests and Analyses .....	3.11-4
3.11.2.1	Environmental Qualification during Normal Operation .....	3.11-5
3.11.2.2	Environmental Qualification during and after a Design Basis Accident .....	3.11-5
3.11.2.3	Environmental Qualification Method .....	3.11-6
3.11.3	Qualification Test Results .....	3.11-11
3.11.3.1	Electrical and I&C Equipment .....	3.11-11
3.11.3.2	Mechanical Equipment .....	3.11-11
3.11.4	Loss of Ventilation .....	3.11-12
3.11.5	Estimate Chemical and Radiation Environment .....	3.11-13
3.11.5.1	Chemical Environment .....	3.11-13
3.11.5.2	Radiation Environment .....	3.11-13
3.11.6	Qualification of Mechanical Equipment .....	3.11-16
3.11.7	Combined License Information .....	3.11-16
3.11.8	References .....	3.11-16
<b>3.12</b>	<b>Piping Design Review .....</b>	<b>3.12-1</b>
3.12.1	Introduction .....	3.12-1
3.12.2	Codes and Standards .....	3.12-1
3.12.2.1	ASME Boiler and Pressure Vessel Code .....	3.12-1
3.12.2.2	ASME Code Cases .....	3.12-2
3.12.2.3	Piping System Design Specification and Design Report .....	3.12-2
3.12.3	Piping Analysis Methods .....	3.12-3
3.12.3.1	Experimental Stress Analysis Method .....	3.12-3
3.12.3.2	Modal Response Spectrum Method .....	3.12-3
3.12.3.3	Independent Support Motion Method .....	3.12-6

## APR1400 DCD TIER 2

3.12.3.4	Time-History Method.....	3.12-7
3.12.3.5	Inelastic Analysis Method .....	3.12-8
3.12.3.6	Small-Bore Piping System Method .....	3.12-8
3.12.3.7	Non-seismic/Seismic Interaction (II/I).....	3.12-8
3.12.3.8	Seismic Category I Buried Piping .....	3.12-9
3.12.4	Piping Modeling Technique .....	3.12-9
3.12.4.1	Computer Codes .....	3.12-9
3.12.4.2	Dynamic Piping Model .....	3.12-11
3.12.4.3	Piping Benchmark Program .....	3.12-12
3.12.4.4	Decoupling Criteria .....	3.12-12
3.12.5	Piping Stress Analysis Criteria.....	3.12-13
3.12.5.1	Seismic Input Envelope vs. Site-Specific Spectra.....	3.12-13
3.12.5.2	Design Transients .....	3.12-13
3.12.5.3	Loadings and Load Combination .....	3.12-13
3.12.5.4	Damping Values .....	3.12-16
3.12.5.5	Combination of Modal Responses .....	3.12-17
3.12.5.6	High-Frequency Modes .....	3.12-17
3.12.5.7	Fatigue Evaluation of ASME Code Class 1 Piping.....	3.12-17
3.12.5.8	Fatigue Evaluation of ASME Code Class 2 and 3 Piping.....	3.12-17
3.12.5.9	Thermal Oscillations in Piping Connected to the Reactor Coolant System .....	3.12-18
3.12.5.10	Thermal Stratification.....	3.12-20
3.12.5.11	Safety Relief Valve Design, Installation, and Testing .....	3.12-21
3.12.5.12	Functional Capability .....	3.12-22
3.12.5.13	Combination of Inertial and Seismic Anchor Motion Effects.....	3.12-22
3.12.5.14	Operating Basis Earthquake as a Design Load .....	3.12-22
3.12.5.15	Welded Attachments .....	3.12-22
3.12.5.16	Modal Damping for Composite Structures .....	3.12-22
3.12.5.17	Minimum Temperature for Thermal Analyses.....	3.12-23
3.12.5.18	Intersystem Loss-of-Coolant Accident.....	3.12-23
3.12.5.19	Effects of Environment on Fatigue Design .....	3.12-23

## APR1400 DCD TIER 2

3.12.6	Piping Support Design Criteria .....	3.12-23
3.12.6.1	Applicable Codes .....	3.12-23
3.12.6.2	Jurisdictional Boundaries .....	3.12-24
3.12.6.3	Loads and Load Combinations.....	3.12-24
3.12.6.4	Pipe Support Baseplate and Anchor Bolt Design.....	3.12-25
3.12.6.5	Use of Energy Absorbers and Limit Stops.....	3.12-25
3.12.6.6	Use of Snubbers.....	3.12-25
3.12.6.7	Pipe Support Stiffness .....	3.12-25
3.12.6.8	Seismic Self-Weight Excitation .....	3.12-26
3.12.6.9	Design of Supplementary Steel .....	3.12-26
3.12.6.10	Consideration of Friction Forces.....	3.12-26
3.12.6.11	Pipe Support Gaps and Clearances.....	3.12-27
3.12.6.12	Instrumentation Line Support Criteria .....	3.12-27
3.12.6.13	Pipe Deflection Limits.....	3.12-27
3.12.7	Combined License Information.....	3.12-27
3.12.8	References .....	3.12-28
<b>3.13</b>	<b>Threaded Fasteners (ASME Section III Class 1, 2, and 3) .....</b>	<b>3.13-1</b>
3.13.1	Design Considerations.....	3.13-1
3.13.1.1	Materials Selection .....	3.13-1
3.13.1.2	Special Materials Fabrication Processes and Special Controls .....	3.13-1
3.13.1.3	Fracture Toughness Requirements for Threaded Fasteners Made of Ferritic Materials.....	3.13-3
3.13.1.4	[Reserved] .....	3.13-3
3.13.1.5	Certified Material Test Reports.....	3.13-3
3.13.2	Inservice Inspection Requirements .....	3.13-4
3.13.3	Combined License Information.....	3.13-4
3.13.4	References .....	3.13-4
<b>APPENDIX 3A – Reactor Coolant System Analysis.....</b>		<b>3A-1</b>

**LIST OF TABLES**

<u>NUMBER</u>	<u>TITLE</u>	<u>PAGE</u>
Table 3.2-1	Classification of Structures, Systems, and Components .....	3.2-16
Table 3.2-2	Classification System Relationship.....	3.2-102
Table 3.4-1	Reactor Containment Building Components Protected From Internal Flooding.....	3.4-18
Table 3.4-2	Auxiliary Building Components Protected from Internal Flooding .....	3.4-21
Table 3.5-1	Kinetic Energy of Potential Missiles.....	3.5-22
Table 3.5-2	Design Basis Missiles .....	3.5-24
Table 3.5-3	Minimum Acceptable Barrier Thickness Requirements for Local Damage Prediction against Missiles Generated by Natural Phenomena .....	3.5-25
Table 3.5-4	Major Systems and Components To Be Protected from Externally Generated Missiles .....	3.5-26
Table 3.6-1	High- and Moderate-Energy Fluid Systems.....	3.6-46
Table 3.6-2	Material Constants .....	3.6-47
Table 3.6-3	Design Parameters Used in LBB Evaluations (Main Coolant Loop and Surge Line).....	3.6-49
Table 3.6-4	Design Parameters Used In LBB Evaluation (Direct Vessel Injection and Shutdown Cooling Line) .....	3.6-50
Table 3.6-5	Parameters on J-R Curves .....	3.6-51
Table 3.7-1	Spectral Amplitude of CSDRS for Control Points.....	3.7-35
Table 3.7-2	Comparison of Ratios $V/A$ and $AD/V^2$ .....	3.7-36
Table 3.7-3	Target PSD Compatible with Horizontal CSDRS .....	3.7-37
Table 3.7-4	Comparison of Ratios for HRHF Seismic Input Motions $V/A$ and $AD/V^2$ .....	3.7-38
Table 3.7-5	Target PSD Compatible with Horizontal HRHF Seismic Input Motions .....	3.7-39
Table 3.7-6	Target PSD Compatible with Vertical HRHF Seismic Input Motions .....	3.7-40



## APR1400 DCD TIER 2

Table 3.7-7	Damping Values.....	3.7-41
Table 3.7-8	Foundation Embedment Depth, Foundation Size, and Total Height of Seismic Category I Structures.....	3.7-43
Table 3.7-9	Summary of Models and Analysis Methods .....	3.7-44
Table 3.7-10	Summary of Modal Properties of Reactor Containment Building Containment Structure .....	3.7-46
Table 3.7-11	Summary of Modal Properties of Reactor Containment Building Internal Structure.....	3.7-47
Table 3.7-12	Summary of Modal Properties of Auxiliary Building.....	3.7-48
Table 3.7-13	Summary of Modal Properties of Emergency Diesel Generator Building EDG Building.....	3.7-49
Table 3.7-14	Maximum Response Accelerations of Reactor Containment Building Containment Structure .....	3.7-50
Table 3.7-15	Maximum Relative Displacements of Reactor Containment Building Containment Structure .....	3.7-51
Table 3.7-16	Maximum Member Forces of Reactor Containment Building Containment Structure .....	3.7-52
Table 3.7-17	Maximum Response Accelerations of Reactor Containment Building Internal Structure.....	3.7-53
Table 3.7-18	Maximum Relative Displacements of Reactor Containment Building Internal Structure.....	3.7-54
Table 3.7-19	Maximum Member Forces of Reactor Containment Building Internal Structure.....	3.7-55
Table 3.7-20	Maximum Response Accelerations of Auxiliary Building .....	3.7-56
Table 3.7-21	Maximum Relative Displacements of Auxiliary Building.....	3.7-57
Table 3.7-22	Maximum Member Forces of Auxiliary Building .....	3.7-58
Table 3.7-23	Maximum Response Accelerations of EDG Building .....	3.7-59
Table 3.7-24	Maximum Relative Displacements of EDG Building.....	3.7-60
Table 3.7-25	Maximum Member Forces of EDG Building .....	3.7-61
Table 3.8-1	Codes, Standards, Specifications, and Regulations .....	3.8-90
Table 3.8-2	Seismic Category I Structure Load Combination for the Reactor Containment Building.....	3.8-92

## APR1400 DCD TIER 2

Table 3.8-3	Load Definitions and Load Combinations for ASME Class MC Containment Components .....	3.8-93
Table 3.8-4	Load Combinations for Penetration Sleeves and Head Fittings.....	3.8-94
Table 3.8-5	Allowable Stresses for Penetration Sleeves and Head Fittings.....	3.8-95
Table 3.8-6	Physical Properties for Materials to be Used for Pressure Parts or Attachment to Pressure Part ASME Code Class MC Components.....	3.8-96
Table 3.8-7	Design Loads for Nuclear Island Category I Structures .....	3.8-97
Table 3.8-8	Types and Applicable Loading Conditions for Dead Loads and Live Loads.....	3.8-98
Table 3.8-9A	Seismic Category I Structures Excluding Containment Structure Reinforced Concrete – Ultimate Strength Design Load Combination Table.....	3.8-99
Table 3.8-9B	Seismic Category I Structures Structural Steel – Elastic Design Load Combination Table.....	3.8-100
Table 3.8-9C	Spent Fuel Storage Rack – Design Loading Combination Table .....	3.8-102
Table 3.8-10	Acceptance Criteria for Overturning, Sliding, and Flotation .....	3.8-103
Table 3.9-1	Transients Used in Stress Analysis of Code Class 1 and CS Components.....	3.9-107
Table 3.9-2	Loading Combinations for ASME Code Class 1, 2, and 3 Components and Component Supports.....	3.9-110
Table 3.9-3	Stress Limits for ASME Code Class 1 Components, Piping, and Component Supports .....	3.9-111
Table 3.9-4	Seismic Category I Active Valves .....	3.9-112
Table 3.9-5	Stress Criteria for Safety-Related ASME Section III Class 2 and Class 3 Vessels .....	3.9-132
Table 3.9-6	Stress Criteria for ASME Section III Class 2 and Class 3 Inactive Pumps .....	3.9-133
Table 3.9-7	Stress Criteria for ASME Section III Class 2 and Class 3 Active Pumps .....	3.9-134
Table 3.9-8	Stress Criteria for Safety-Related ASME Section III Class 2 and Class 3 Non-active Valves .....	3.9-135

## APR1400 DCD TIER 2

Table 3.9-9	Stress Criteria for ASME Section III Class 2 and Class 3 Active Valves .....	3.9-136
Table 3.9-10	Loading Conditions and Load Combinations Requirements for ASME Section III Class 1, 2, and 3 Piping Supports.....	3.9-137
Table 3.9-11	Stress Limits for CEDM Pressure Housings .....	3.9-138
Table 3.9-12	Stress Limits for Reactor Internals Design and Service Loads.....	3.9-139
Table 3.9-13	Inservice Testing of Safety-Related Pumps and Valves .....	3.9-140
Table 3.9-14	RCS Pressure Isolation Valves Associated with the Reactor Coolant System .....	3.9-230
Table 3.9-15	Arrangement Comparison of Reactor Internals .....	3.9-231
Table 3.9-16	Nominal Dimensional Comparison of Reactor Internals .....	3.9-233
Table 3.9-17	Comparison of Operating Condition for Reactor Internals.....	3.9-234
Table 3.9-18	List of Active Pumps.....	3.9-235
Table 3.11-1	Ventilation Areas .....	3.11-20
Table 3.11-2	Environmental Data .....	3.11-21
Table 3.11-3	Environmental Qualification Equipment List .....	3.11-26
Table 3.12-1	Loading Combinations and Acceptance Criteria for ASME Section III, Class 1 Piping.....	3.12-31
Table 3.12-2	Loading Combinations for Acceptance Criteria for ASME Section III Class 2 and 3 Piping.....	3.12-35
Table 3.13-1	ASME Section III Criteria for Selection and Testing of Bolting Materials.....	3.13-6
Table 3.13-2	ASME Section XI Examination Categories for Inservice Inspections of Mechanical Joints in ASME Code Class 1, 2, and 3 Systems Secured by Threaded Fasteners.....	3.13-7

**LIST OF FIGURES**

<u>NUMBER</u>	<u>TITLE</u>	<u>PAGE</u>
Figure 3.4-1	Location of Watertight doors and Flood Barrier Plan View Elevation 55'-0" .....	3.4-37
Figure 3.4-2	Location of Watertight doors and Flood Barrier Plan View Elevation 78'-0" .....	3.4-38
Figure 3.4-3	Location of Watertight doors and Flood Barrier Plan View Elevation 100'-0" .....	3.4-39
Figure 3.4-4	Location of Watertight doors and Flood Barrier Plan View Elevation 120'-0" .....	3.4-40
Figure 3.4-5	Location of Watertight doors and Flood Barrier Plan View Elevation 137'-6" .....	3.4-41
Figure 3.4-6	Location of Watertight doors and Flood Barrier Plan View Elevation 156'-0" .....	3.4-42
Figure 3.4-7	Location of Watertight doors and Flood Barrier Plan View Elevation 174'-0" .....	3.4-43
Figure 3.5-1	Turbine Missile Strike Zone .....	3.5-29
Figure 3.6-1	Typical Pipe Whip Restraint Configuration .....	3.6-52
Figure 3.6-2	Stress-Strain Curve for Hot Leg and Cold Leg, Fit to Intermediate Strain.....	3.6-53
Figure 3.6-3	Stress-Strain Curve for Surge Line, Fit to Intermediate Strain .....	3.6-54
Figure 3.6-4	Stress-Strain Curve for DVI (Group 1), Fit to Intermediate Strain ...	3.6-55
Figure 3.6-5	Stress-Strain Curve for DVI/SC (Group 2 & 3), Fit to Intermediate Strain.....	3.6-56
Figure 3.6-6	Stress-Strain Curve for Hot Leg and Cold Leg .....	3.6-57
Figure 3.6-7	Stress-Strain Curve for Surge Line.....	3.6-58
Figure 3.6-8	Stress-Strain Curve for DVI (Group 1) .....	3.6-59
Figure 3.6-9	Stress-Strain Curve for DVI/SC (Group 2 & 3) .....	3.6-60
Figure 3.6-10	J-R Curve for Hot Leg and Cold Leg .....	3.6-61
Figure 3.6-11	J-R Curve for Surge Line.....	3.6-62
Figure 3.6-12	J-R Curve for DVI (Group 1) .....	3.6-63
Figure 3.6-13	J-R Curve for DVI/SC (Group 2 & 3) .....	3.6-64

## APR1400 DCD TIER 2

Figure 3.6-14	Moment vs. Crack Length for Surge Line .....	3.6-65
Figure 3.6-15	Moment vs. Crack Length for Cold Leg.....	3.6-66
Figure 3.6-16	Moment vs. Crack Length for Hot Leg .....	3.6-67
Figure 3.6-17	Moment vs. Crack Length for DVI (Group 1).....	3.6-68
Figure 3.6-18	Moment vs. Crack Length for DVI (Group 2) Power Operation .....	3.6-69
Figure 3.6-19	Moment vs. Crack Length for DVI (Group 2) Heatup Condition .....	3.6-70
Figure 3.6-20	Moment vs. Crack Length for SC (Group 3).....	3.6-71
Figure 3.6-21	Overall Finite Element Model .....	3.6-72
Figure 3.6-22	Crack Area Close-up of Finite Element Model .....	3.6-73
Figure 3.6-23	Different Crack Length Used to Calculate Derivative .....	3.6-74
Figure 3.6-24	Development of a Stability Evaluation Diagram.....	3.6-75
Figure 3.6-25	LBB Piping Evaluation Diagram.....	3.6-76
Figure 3.6-26	Use of the LBB Piping Evaluation Diagram .....	3.6-77
Figure 3.6-27	LBB Piping Evaluation Diagram (Hot Leg).....	3.6-78
Figure 3.6-28	LBB Piping Evaluation Diagram (Cold Leg) .....	3.6-79
Figure 3.6-29	LBB Piping Evaluation Diagram (Surge Line, SSE Load) .....	3.6-80
Figure 3.6-30	LBB Piping Evaluation Diagram (Surge Line, Stratified Flow Load).....	3.6-81
Figure 3.6-31	LBB Piping Evaluation Diagram (DVI Group 1).....	3.6-82
Figure 3.6-32	LBB Piping Evaluation Diagram (DVI Group 2).....	3.6-83
Figure 3.6-33	LBB Piping Evaluation Diagram (DVI Group 2, Stratified Flow Load).....	3.6-84
Figure 3.6-34	LBB Piping Evaluation Diagram (SC Group 3) .....	3.6-85
Figure 3.7-1	Horizontal CSDRS.....	3.7-62
Figure 3.7-2	Vertical CSDRS.....	3.7-63
Figure 3.7-3	Acceleration, Velocity, and Displacement of H1 Design Ground Motion.....	3.7-64
Figure 3.7-4	Acceleration, Velocity, and Displacement of H2 Design Ground Motion.....	3.7-65
Figure 3.7-5	Acceleration, Velocity, and Displacement of VT Design Ground Motion.....	3.7-66

## APR1400 DCD TIER 2

Figure 3.7-6	Comparison of Response Spectra of H1 Design Ground Motion and CSDRS.....	3.7-67
Figure 3.7-7	Comparison of Response Spectra of H2 Design Ground Motion and CSDRS.....	3.7-68
Figure 3.7-8	Comparison of Response Spectra of VT Design Ground Motion and CSDRS.....	3.7-69
Figure 3.7-9	Comparison of PSD of H1 Design Ground Motion and Target PSD and Minimum Required PSD.....	3.7-70
Figure 3.7-10	Comparison of PSD of H2 Design Ground Motion and Target PSD and Minimum Required PSD.....	3.7-71
Figure 3.7-11	Comparison of PSD of VT Design Ground Motion and Target PSD and Minimum Required PSD.....	3.7-72
Figure 3.7-12	HRHF Horizontal Target Response Spectra.....	3.7-73
Figure 3.7-13	HRHF Vertical Target Response Spectra.....	3.7-74
Figure 3.7-14	Acceleration, Velocity, and Displacement of H1H for HRHF .....	3.7-75
Figure 3.7-15	Acceleration, Velocity, and Displacement of H2H for HRHF .....	3.7-76
Figure 3.7-16	Acceleration, Velocity, and Displacement of VTH for HRHF .....	3.7-77
Figure 3.7-17	Comparison of Response Spectra of H1H and HRHF Horizontal Target Design Spectra.....	3.7-78
Figure 3.7-18	Comparison of Response Spectra of H2H and HRHF Horizontal Target Design Spectra.....	3.7-79
Figure 3.7-19	Comparison of Response Spectra of VTH and HRHF Vertical Target Design Spectra.....	3.7-80
Figure 3.7-20	Comparison of PSD of H1H and HRHF Target PSD and Minimum Required PSD .....	3.7-81
Figure 3.7-21	Comparison of PSD of H2H and HRHF Target PSD and Minimum Required PSD .....	3.7-82
Figure 3.7-22	Comparison of PSD of VTH and HRHF Target PSD and Minimum Required PSD .....	3.7-83
Figure 3.7-23	Generic Soil Profiles Proposed for APR1400 Standard Design.....	3.7-84
Figure 3.7-24	Finite Element Model of Reactor Containment Building Containment Structure.....	3.7-85
Figure 3.7-25	Finite Element Model of Reactor Containment Building Internal Structures .....	3.7-86

## APR1400 DCD TIER 2

Figure 3.7-26	Finite Element Model of Auxiliary Building.....	3.7-87
Figure 3.7-27	Finite Element Model of Diesel Generator Building.....	3.7-88
Figure 3.7-28	First Major X-mode Shape of Reactor Containment Building Containment Structure .....	3.7-89
Figure 3.7-29	First Major Y-mode Shape of Reactor Containment Building Containment Structure .....	3.7-90
Figure 3.7-30	First Major Z-mode Shape of Reactor Containment Building Containment Structure .....	3.7-91
Figure 3.7-31	First Major X-mode Shape of Reactor Containment Building Internal Structures.....	3.7-92
Figure 3.7-32	First Major Y-mode Shape of Reactor Containment Building Internal Structures.....	3.7-93
Figure 3.7-33	First Major Z-mode Shape of Reactor Containment Building Internal Structures.....	3.7-94
Figure 3.7-34	First Major X-mode Shape of Auxiliary Building.....	3.7-95
Figure 3.7-35	First Major Y-mode Shape of Auxiliary Building.....	3.7-96
Figure 3.7-36	First Major Z-mode Shape of Auxiliary Building .....	3.7-97
Figure 3.7-37	First Major X-mode Shape of Emergency Diesel Generator Building .....	3.7-98
Figure 3.7-38	First Major Y-mode Shape of Emergency Diesel Generator Building .....	3.7-99
Figure 3.7-39	First Major Z-mode Shape of Emergency Diesel Generator Building .....	3.7-100
Figure 3.7-40	Finite Element Model of Turbine Generator Building .....	3.7-101
Figure 3.7-41	Finite Element Model of Compound Building .....	3.7-102
Figure 3.8-1	Typical Section of Containment Structures (Looking North) .....	3.8-104
Figure 3.8-2	Typical Section of Containment Structures (Looking East).....	3.8-105
Figure 3.8-3	Local Area around Large Penetrations .....	3.8-106
Figure 3.8-4	Arrangement of Containment Post-Tensioning System .....	3.8-107
Figure 3.8-5	Liner Plate and Anchorage System.....	3.8-108
Figure 3.8-6	Typical Penetration Assembly System .....	3.8-109
Figure 3.8-7	Typical Electrical Penetration Assembly.....	3.8-110
Figure 3.8-8	Containment Shell and Dome Analysis Model .....	3.8-111

## APR1400 DCD TIER 2

Figure 3.8-9	Finite Element Model for Auxiliary Building Global Structural Analysis .....	3.8-112
Figure 3.8-10	Equipment Hatch .....	3.8-113
Figure 3.8-11	Personnel Airlock .....	3.8-114
Figure 3.8-12	Reactor Vessel Supports .....	3.8-115
Figure 3.8-13	Steam Generator Supports .....	3.8-117
Figure 3.8-14	Reactor Coolant Pump Supports.....	3.8-119
Figure 3.8-15	Pressurizer Supports .....	3.8-120
Figure 3.8-16	Reactor Containment Building Section in N-S Direction.....	3.8-121
Figure 3.8-17	Reactor Containment Building Section in E-W Direction .....	3.8-122
Figure 3.9-1	Reactor Coolant System Supports Diagram .....	3.9-237
Figure 3.9-2	Summary of Analytical Methodology .....	3.9-238
Figure 3.9-3	ASHSD Finite Element Model of the Core Support Barrel .....	3.9-239
Figure 3.9-4	Inner Barrel Assembly of Finite Element Model .....	3.9-240
Figure 3.9-5	Finite Element Model of the CEA Guide Tubes .....	3.9-241
Figure 3.9-6	Lower Support Structure / In-Core Instrumentation Nozzle Assembly Finite Element Model .....	3.9-242
Figure 3.9-7	Control Element Drive Mechanism .....	3.9-243
Figure 3.9-8	Reactor Internals Arrangement.....	3.9-244
Figure 3.9-9	Core Support Barrel Assembly .....	3.9-245
Figure 3.9-10	Reactor Vessel /Core Support Barrel Snubber Assembly .....	3.9-246
Figure 3.9-11	Lower Support Structure /ICI Nozzle Assembly .....	3.9-247
Figure 3.9-12	Core Shroud .....	3.9-248
Figure 3.9-13	Upper Guide Structure Assembly .....	3.9-249
Figure 3.9-14	In-Core Instrumentation Support System .....	3.9-250
Figure 3.9-15	Typical Inservice Testing Connections .....	3.9-251
Figure 3.9-16	Reactor Internals Horizontal Seismic Analysis Model.....	3.9-260
Figure 3.9-17	Core Seismic Analysis Model - One Row of 17 Fuel Assemblies .....	3.9-261
Figure 3.9-18	Reactor Internals Vertical SSE and Pipe Break Analysis Model ....	3.9-262
Figure 3.9-19	Reactor Internals Horizontal Pipe Break Analysis Model.....	3.9-263



**ACRONYM AND ABBREVIATION LIST**

AAC	Alternate Alternating Current
AB	Auxiliary Building
AC	Alternating Current
ACI	American Concrete Institute
ACU	Air Cleaning Unit
AFW	Auxiliary Feedwater
AFWS	Auxiliary Feedwater System
AHU	Air Handling Unit
AISC	American Institute of Steel Construction
AISI	American Iron and Steel Institute
ANS	American Nuclear Society
ANSI	American National Standards Institute
AOO	Anticipated Operational Occurrence
APR	Advanced Power Reactor
ASCE	American Society of Civil Engineers
ASME	American Society of Mechanical Engineers
ASTM	American Society of Testing And Materials
ATWS	Anticipated Transient Without Scram
BAST	Boric Acid Storage Tank
BLPB	Branch Line Pipe Break
BOP	Balance Of Plant
BRL	Ballistic Research Laboratory
CCW	Component Cooling Water
CCWS	Component Cooling Water System
CEA	Control Element Assembly
CEDM	Control Element Drive Mechanism
CFR	Code of Federal Regulations
CIAS	Containment Isolation Actuation Signal
CIV	Containment Isolation Valve

**APR1400 DCD TIER 2**

COL	Combined License
COLA	Combined License Application
CS	1) Containment Spray 2) Core Support
CSB	Core Support Barrel
CSDRS	Certified Seismic Design Response Spectra
CSS	Containment Spray System
CVAP	Comprehensive Vibration Assessment Program
CVCS	Chemical and Volume Control System
CWS	Circulating Water System
DAC	Design Acceptance Criteria
DBE	Design Basis Event
DBFL	Design Basis Flooding Level
DBPB	Design Basis Pipe Break
DCD	Design Control Document
DFOT	Diesel Fuel Oil Tank
DFL	Dynamic Fluid Loads
DIF	Dynamic Impact Factor
DLF	Dynamic Load Factor
DN	Nominal Diameter
DNBR	Departure from Nucleate Boiling Ratio
DVI	Direct Vessel Injection
EAB	Exclusion Area Boundary
ECCS	Emergency Core Cooling System
EDG	Emergency Diesel Generator
EPRI	Electric Power Research Institute
ESA	Extension Shaft Assembly
ESF	Engineered Safety Features
ESFAS	Engineered Safety Features Actuation System (or Signal)
ESWS	Essential Service Water System
FEM	Finite Element Model

**APR1400 DCD TIER 2**

FHA	Fuel Handling Area
FIV	Flow Induced Vibration
FWLB	Feedwater Line Break
FTC	Fuel Temperature Coefficient
FW	Feed Water
FWLB	Feedwater Line Break
FWPB	Feedwater Pipe Break
GDC	General Design Criteria (of 10 CFR 50, Appendix A)
GL	Generic Letter
GMRS	Ground Motion Response Spectra
GTAW	Gas Tungsten Arc Weld
HELB	High Energy Line Break
HIS	Hydraulic Institute Standard
HJTC	Heated Junction Thermocouple
HRHF	Hard Rock High Frequency
HSB	Hot Standby
HSD	Hot Shutdown
HVAC	Heating, Ventilation, and Air Conditioning
HVT	Holdup Volume Tank
HX	Heat Exchanger
I&C	Instrumentation And Control
IBA	Inner Barrel Assembly
ICI	In-Core Instrumentation
ID	Inner Diameter
IEEE	Institute of Electrical and Electronics Engineers
IHA	Integrated Head Assembly
IRWST	In-Containment Refueling Water Storage Tank
ISI	Inservice Inspection
ISM	Independent Support Motion
ISRS	In-structure Response Spectra
IST	Inservice Testing

**APR1400 DCD TIER 2**

ITAAC	Inspections, Tests, Analyses, and Acceptance Criteria
J-R	J-Resistance
JOG	Joint Owner Group
KNPP	Korean Nuclear Power Plant
LBB	Leak Before Break
LCO	Limiting Conditions for Operation
LOCA	Loss Of Coolant Accident
LOOP	Loss Of Offsite Power
LOF	Left-Out-Force
LPD	Local Power Density
LPZ	Low Population Zone
LSS	Lower Support Structure
LSSS	Limiting Safety System Setting
LTOP	Low Temperature Overpressure Protection
LWR	Light Water Reactor
MCC	Motor Control Center
MCL	Main Coolant Loop
MCR	Main Control Room
MFS	Main Feedwater System
MMC	Missing Mass Correction
MOV	Motor-Operated Valve
MS	Main Steam
MSE	Main Steam Enclosure
MSIS	Main Steam Isolation Signal
MSIV	Main Steam Isolation Valve
MSLB	Main Steam Line Break
MSS	Main Steam System
MSSV	Main Steam Safety Valve
MSV	Main Steam Valve
MSVH	Main Steam Valve House
MTC	Moderator Temperature Coefficient

**APR1400 DCD TIER 2**

NDRC	National Defense Research Council
NDTT	Nil Ductility Transition Temperature
NI	Nuclear Island
NNS	Non-Nuclear Safety
NO	Normal Operation
NOP	Normal Operating Procedure
NPP	Nuclear Power Plant
NPSH	Net Positive Suction Head
NPSHA	Net Positive Suction Head Available
NPSHR	Net Positive Suction Head Required
NS	Non-Seismic
NSSS	Nuclear Steam Supply System
NUREG	U.S. Nuclear Regulatory Commission Regulation
OBE	1) Operating Basis Earthquake 2) Operating Basis Event
OD	Outside Diameter
P&ID	Piping and Instrumentation Diagram
PED	Piping Evaluation Diagram
PGA	Peak Ground Acceleration
PIV	Pressure Isolation Valve
PMF	Probable Maximum Flood
PMP	Probable Maximum Precipitation
POSRV	Pilot Operated Safety Relief Valve
POV	Power-Operated Valve
PPS	1) Plant Protection System 2) Preferred Power Supply
PSD	Power Spectra Density
PSW	Primary Shield Wall
PWR	Pressurized Water Reactor
PZR	Pressurizer
RAP	Reliability Assurance Program

## APR1400 DCD TIER 2

RC	Reactor Coolant
RCB	Reactor Containment Building
RCGVS	Reactor Coolant Gas Vent System
RCL	Reactor Coolant Loop
RCP	Reactor Coolant Pump
RCPB	Reactor Coolant Pressure Boundary
RCS	Reactor Coolant System
RHR	Residual Heat Removal
RPS	Reactor Protection System
RRS	Required Response Spectra
RSPT	Reed Switch Position Transmitter
RTD	Resistance Temperature Detector
RTNDT	Reference Temperature Nil-Ductility Transition
RTSS	Reactor Trip Switchgear System
RTSS	Reactor Trip Switchgear System
RV	Reactor Vessel
RVI	Reactor Vessel Internals
SAFDL	Specified Acceptable Fuel Design Limit
SAM	Seismic Anchor Movement Motion
SC	1) Shutdown Cooling 2) Safety Console
SCP	Shutdown Cooling Pump
SCS	Shutdown Cooling System
SDVS	Safety Depressurization and Vent System
SECY	Office of the Secretary of the Commission
SFP	Spent Fuel Pool
SG	Steam Generator
SGBDS	Steam Generator Blowdown System
SGTR	Steam Generator Tube Rupture
SI	Safety Injection
SIF	Stress Intensification Factor

**APR1400 DCD TIER 2**

SIP	Safety Injection Pump
SIS	Safety Injection System
SIT	1) Safety Injection Tank 2) Structural Integrity Test
SLB	Steam Line Break
SMAW	Shielded Metal Arc Weld
SOV	Solenoid-Operated Valve
SQSDS	Seismic Qualification Summary Data Sheet
SRI	Stanford Research Institute
SRP	Standard Review Plan
SRSS	Square Root of the Sum of the Squares
SRV	Safety Relief Valve
SSC	Structures, Systems, and Components
SSE	Safe Shutdown Earthquake
SSI	Soil Structure Interaction
SSW	Secondary Shield Wall
TEDE	Total Effective Dose Equivalent
TGB	Turbine Generator Building
TIV	Temperature Isolation Valve
TLOFW	Total Loss Of Feedwater
UGS	Upper Guide Structure
UHS	Ultimate Heat Sink
UPC	Ultimate Pressure Capacity
URS	Uniform Response Spectrum
USH	Uniform Support Motion
USNRC	United States Nuclear Regulatory Commission
VCT	Volume Control Tank
ZPA	Zero Period Acceleration