

DEVELOPER / OWNER

PPL BELL BEND, LLC
38 BUNDY LANE
SUITE 2
BERWICK, PA 18603

REFERENCES

1. LUZERNE COUNTY TAX ASSESSMENT MAP 2004

04 B00A L004 04S2 B001 L013 04S2 B001 L124 04 B00A L41A
04 B00A L054 04S2 B001 L014 04S2 B001 L012 04 B00A L41B
04 B00A L006 04S2 B001 L144 04S1 B001 L000 04 B00A L41C
04 B00A L068 04S2 B001 L016 04S2 B001 L014 04 B00A L095
04 B00A L064 04S2 B001 L017 04 B00A L066 04 B00A L33P
04 B00A L007 04S2 B001 L018 04 B00A L064 04 B00A L330
04 B00A L008 04S2 B001 L020 04 B00A L063 04 B00A L34
04 B00A L088 04S2 B001 L025 04 B00A L100 04 B00A L096
04 B00A L084 04S2 B001 L019 04 B00A L063 04 B00A L097
04 B00A L051 04S2 B001 L022 04 B00A L508 04 B00A L97C
04 B001 L0234 04S2 B001 L023 04 B00A L003
04S1 B001 L000 04S2 B001 L024 04 B00A L041

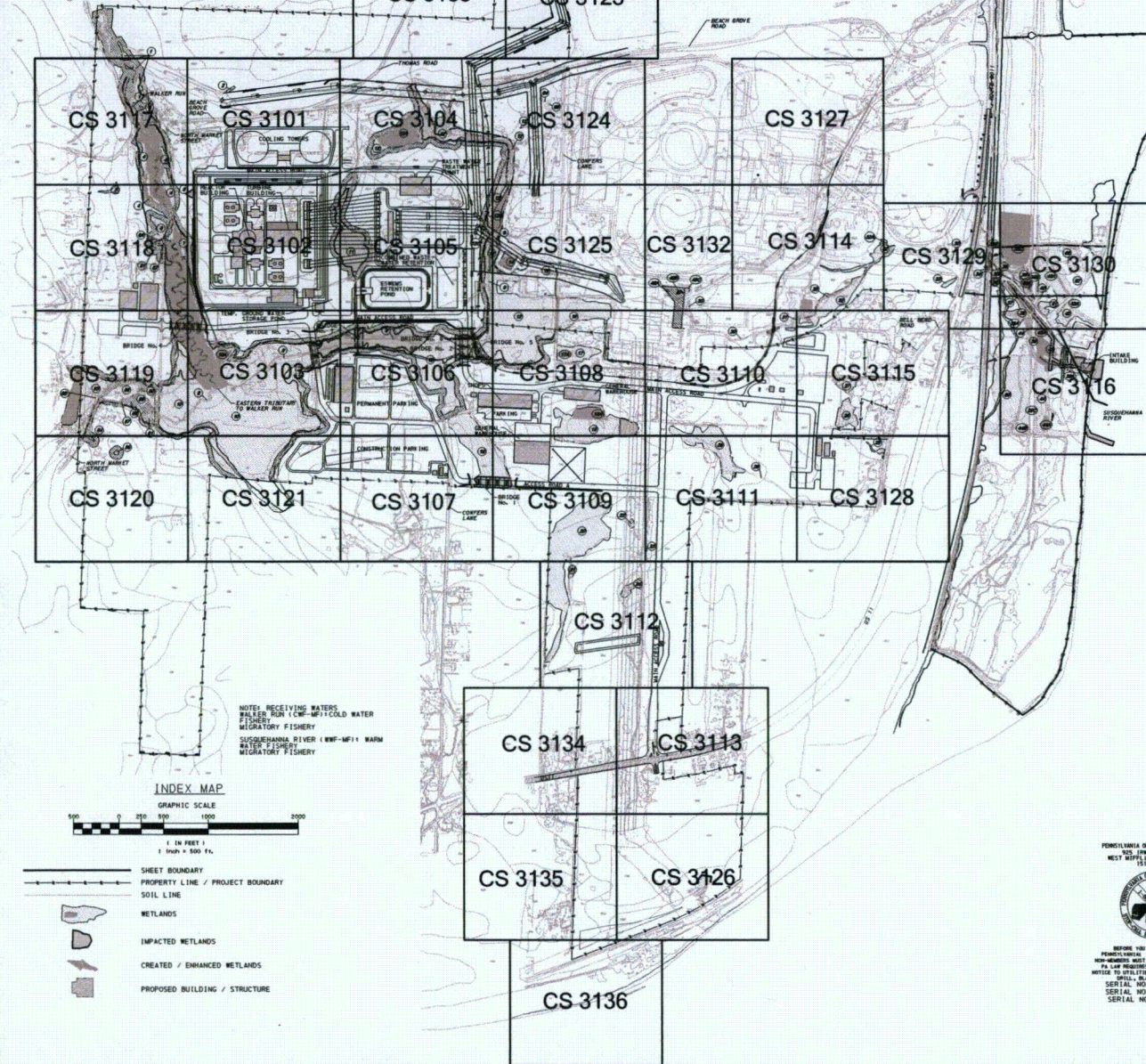

NOTE: RECEIVING WATERS
WALKER RUN (CWP-MP1) COLD WATER
FISHERY
MIGRATORY FISHERY
SUSQUEHANNA RIVER (RWP-MP1) WARM
WATER FISHERY
MIGRATORY FISHERY

INDEX MAP

GRAPHIC SCALE
1 INCH = 500 FEET

SHEET BOUNDARY
PROPERTY LINE / PROJECT BOUNDARY
SOIL LINE
WETLANDS
IMPACTED WETLANDS
CREATED / ENHANCED WETLANDS
PROPOSED BUILDING / STRUCTURE



PENNSYLVANIA DE GRASS, INC.
1000 PENNSYLVANIA AVE.
WEST CHESTER, PENNSYLVANIA 19380
SERIAL NO. 20102950158
SERIAL NO. 20102950158
SERIAL NO. 20102950158



LOCATION MAP
BERWICK QUADRANGLE
SCALE: 1"=2000'

GENERAL NOTES

1. BOUNDARY INFORMATION SHOWN HEREON WAS OBTAINED BY A BOUNDARY SURVEY PERFORMED BY PENNONI ASSOCIATES, INC., WHICH TOOK PLACE DURING MAY 2010 AND AUGUST 2010.
2. PENNONI ASSOCIATES, INC. DOES NOT GUARANTEE THE LOCATION OF SUB-SURFACE STRUCTURES OR SURFACE STRUCTURES THAT ARE NOT VISIBLE AT THE TIME OF THE SURVEY.
3. CONTOUR INTERVAL SHOWN IS 2' AND IS BASED ON NAVD83 DATUM.
4. TOPOGRAPHIC AND PLANTIMETRIC INFORMATION SHOWN IS FROM A SURVEY PERFORMED BY AEROCON PHOTOGRAMMETRIC SERVICES, INC. IN NOVEMBER 2007, JANUARY 2008 AND 2010. ADDITIONAL TOPOGRAPHIC INFORMATION PROVIDED BY PETERS CONSULTANTS.
5. IMPROVEMENTS SHOWN ON THIS PLAN ARE SUBJECT TO THE RULES AND REGULATIONS CONTAINED IN THE SALEM TOWNSHIP ZONING ORDINANCE.
6. HIGHWAY OCCUPANCY PERMITS FOR ACCESS TO TOWNSHIP ROADS ARE UNDER THE JURISDICTION OF SALEM TOWNSHIP.
7. EXISTING 500 YR. FLOOD PLAIN MAPPING INFORMATION SHOWN HEREON WAS OBTAINED FROM FEMA MAP PANEL 420502020B, EFFECTIVE DATE MARCH 18, 1980. EXISTING AND PROPOSED 100 YR. FLOODPLAIN LINES ARE BASED ON THE SUSQUEHANNA RIVER FLOOD STUDY REPORT, REVISION 3, AUGUST 2011 AND THE WALKER RUN FLOOD STUDY REPORT, REVISION 2, SEPTEMBER 2011 PROVIDED BY LANDSTUDIES, INC.
8. LOCATION OF WETLANDS, STREAMS, WATERBODIES, AND AREAS WERE OBTAINED FROM BBNPP USACE THIRD PRELIMINARY JD MAPPING OCTOBER 2011.
9. A 50 FOOT BUFFER WAS PROVIDED FOR ALL EV WETLANDS, WHEREVER POSSIBLE, IN AN EFFORT TO PROTECT THESE AREAS FROM INDIRECT IMPACTS. GRADING AND CLEARING OF VEGETATION IS TO BE AVOIDED TO THE GREATEST EXTENT PRACTICABLE, EXCEPT AS SHOWN ON THESE PLANS.
10. WETLANDS ARE TO REMAIN UNDISTURBED UNLESS NOTED ON FIGURES. PROVIDE ORANGE CONSTRUCTION FENCE AROUND ALL WETLANDS OR WETLAND BUFFERS FOR PROTECTION. TO MINIMIZE IMPACTS, ATTACH THE ORANGE CONSTRUCTION FENCE TO EXISTING TREES TO REMAIN WHERE APPLICABLE. IF ORANGE CONSTRUCTION FENCE IS NOT AVAILABLE, CONSTRUCT AN EARTHEN BERM AROUND WETLANDS OR WETLAND BUFFERS.
11. TREE CLEARING AND WETLAND IMPACTS FOR BRIDGES IS ASSUMED TO BE 80 TOTAL FEET OUTSIDE BRIDGE DECK WITH NO LESS THAN 50 FEET ON ONE SIDE. WETLANDS IN THESE AREAS WILL BE MAINTAINED IN AN EMERGENT OR SCRUB/SHRUB CONDITION TO PROTECT THE INTEGRITY OF THE BRIDGE STRUCTURE.
12. TREE CLEARING FOR OVERHEAD ELECTRIC LINES WILL BE THE FULL WIDTH OF THE RIGHT-OF-WAY OR 100 FEET MEASURED HORIZONTALLY FROM THE OUTERMOST TRANSMISSION LINE WHERE NO RIGHT-OF-WAY EXISTS. WETLANDS IN THESE AREAS WILL BE MAINTAINED IN AN EMERGENT OR SCRUB/SHRUB CONDITION TO PROTECT THE INTEGRITY OF THE TRANSMISSION LINES.
13. INTAKE/DRAINAGE LINE TRENCH TEMPORARY IMPACTS SHALL BE THE TRENCH WIDTH PLUS ANY ADDITIONAL WIDTH REQUIRED FOR EQUIPMENT AND SIDE CAST MATERIAL.

DRAWING LIST

CS3001 JOINT PERMIT INDEX PLAN	CS3121 JOINT PERMIT PLAN
CS3002 JOINT PERMIT INDEX PLAN	CS3122 JOINT PERMIT PLAN
CS3101 JOINT PERMIT PLAN	CS3123 JOINT PERMIT PLAN
CS3102 JOINT PERMIT PLAN	CS3124 JOINT PERMIT PLAN
CS3103 JOINT PERMIT PLAN	CS3125 JOINT PERMIT PLAN
CS3104 JOINT PERMIT PLAN	CS3126 JOINT PERMIT PLAN
CS3105 JOINT PERMIT PLAN	CS3127 JOINT PERMIT PLAN
CS3106 JOINT PERMIT PLAN	CS3128 JOINT PERMIT PLAN
CS3107 JOINT PERMIT PLAN	CS3129 JOINT PERMIT PLAN
CS3108 JOINT PERMIT PLAN	CS3130 JOINT PERMIT PLAN
CS3109 JOINT PERMIT PLAN	CS3131 JOINT PERMIT PLAN
CS3110 JOINT PERMIT PLAN	CS3132 JOINT PERMIT PLAN
CS3111 JOINT PERMIT PLAN	CS3133 JOINT PERMIT PLAN
CS3112 JOINT PERMIT PLAN	CS3134 JOINT PERMIT PLAN
CS3113 JOINT PERMIT PLAN	CS3135 JOINT PERMIT PLAN
CS3114 JOINT PERMIT PLAN	CS3136 JOINT PERMIT PLAN
CS3115 JOINT PERMIT PLAN	CS3201 JOINT PERMIT DETAILS
CS3116 JOINT PERMIT PLAN	CS3202 JOINT PERMIT DETAILS
CS3117 JOINT PERMIT PLAN	CS3203 JOINT PERMIT DETAILS
CS3118 JOINT PERMIT PLAN	CS3204 JOINT PERMIT DETAILS
CS3119 JOINT PERMIT PLAN	CS3205 JOINT PERMIT DETAILS
CS3120 JOINT PERMIT PLAN	CS3206 JOINT PERMIT DETAILS

ALSO PLANS

81/2 X 11 JPA PERMIT SUBMISSION
FIGURE 1 - FIGURE 9
STREAM/WETLAND MITIGATION PLANS
WALKER RUN SITE SHEET 1 - SHEET 11
WETLAND MITIGATION PLANS
CONFER LANE SITE SHEET 1 - SHEET 5
RIVERLANDS SITE SHEET 1 - SHEET 9

Engineers • Surveyors • Planners • Landscape Architects



NO.	DATE	BY	CHKD.	APP.
1	06/15/2011	JPM		
2	06/15/2011	JPM		
3	06/15/2011	JPM		
4	06/15/2011	JPM		
5	06/15/2011	JPM		
6	06/15/2011	JPM		
7	06/15/2011	JPM		
8	06/15/2011	JPM		
9	06/15/2011	JPM		
10	06/15/2011	JPM		

ALL DRAWINGS MUST BE REVIEWED BY CONTRACTOR
FOR ACCURACY AND COMPLETION BEFORE PROCEEDING WITH THE WORK

JOE M. MILLER, Surveyor
Walter-Berwick, Pa. 17027 (570) 484-2900

BELL BEND NUCLEAR POWER PLANT
JOINT PERMIT INDEX PLAN
PPL BELL BEND, LLC
38 BUNDY LANE, SUITE 2
BERWICK, PA 18603

Pennoni Associates Inc.

DATE	06/15/2011
TIME	1:00 PM
WEEK	WEEK 1
PROJECT	CS3001
SHEET	1 OF 44

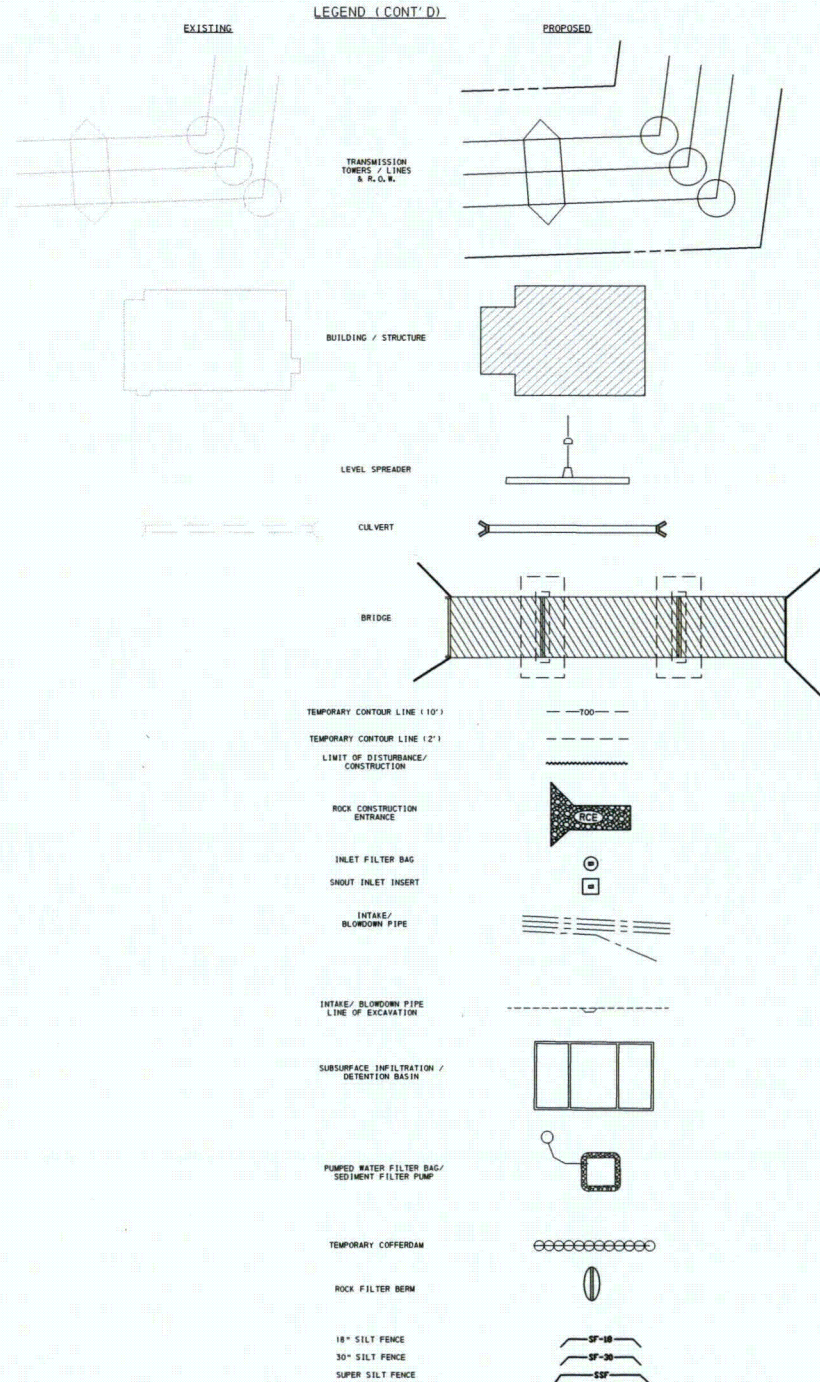
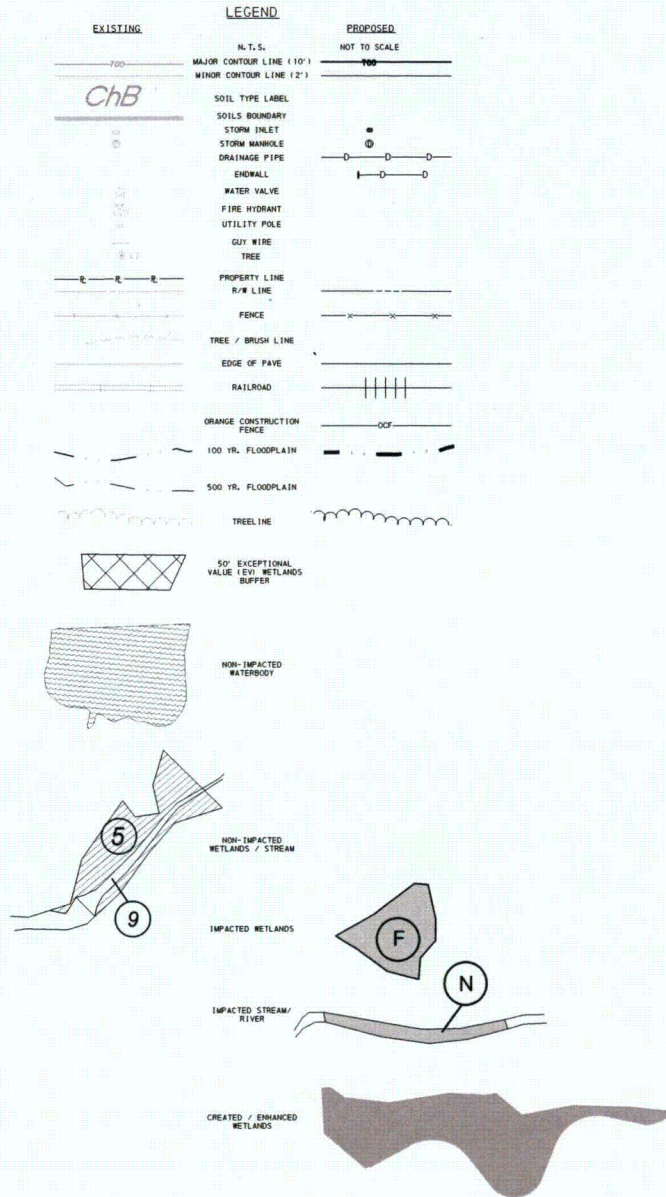

NO.	DATE	BY	CHKD	APP'D
1	06/15/2011	JFM		
2	06/15/2011	JFM		
3	06/15/2011	JFM		

ALL DIMENSIONS MUST BE VERIFIED BY CONSTRUCTION SURVEYOR PRIOR TO CONSTRUCTION.

BELL BEND NUCLEAR POWER PLANT

JOINT PERMIT LEGEND

PPL BELL BEND, LLC

28 BERRY LANE, SUITE 1
BERRY, PA 15603

APP NO.	PPL50902
SHEET	2 OF 44

DATE	06/15/2011
BY	JFM
CHKD	
APP'D	

CS3002

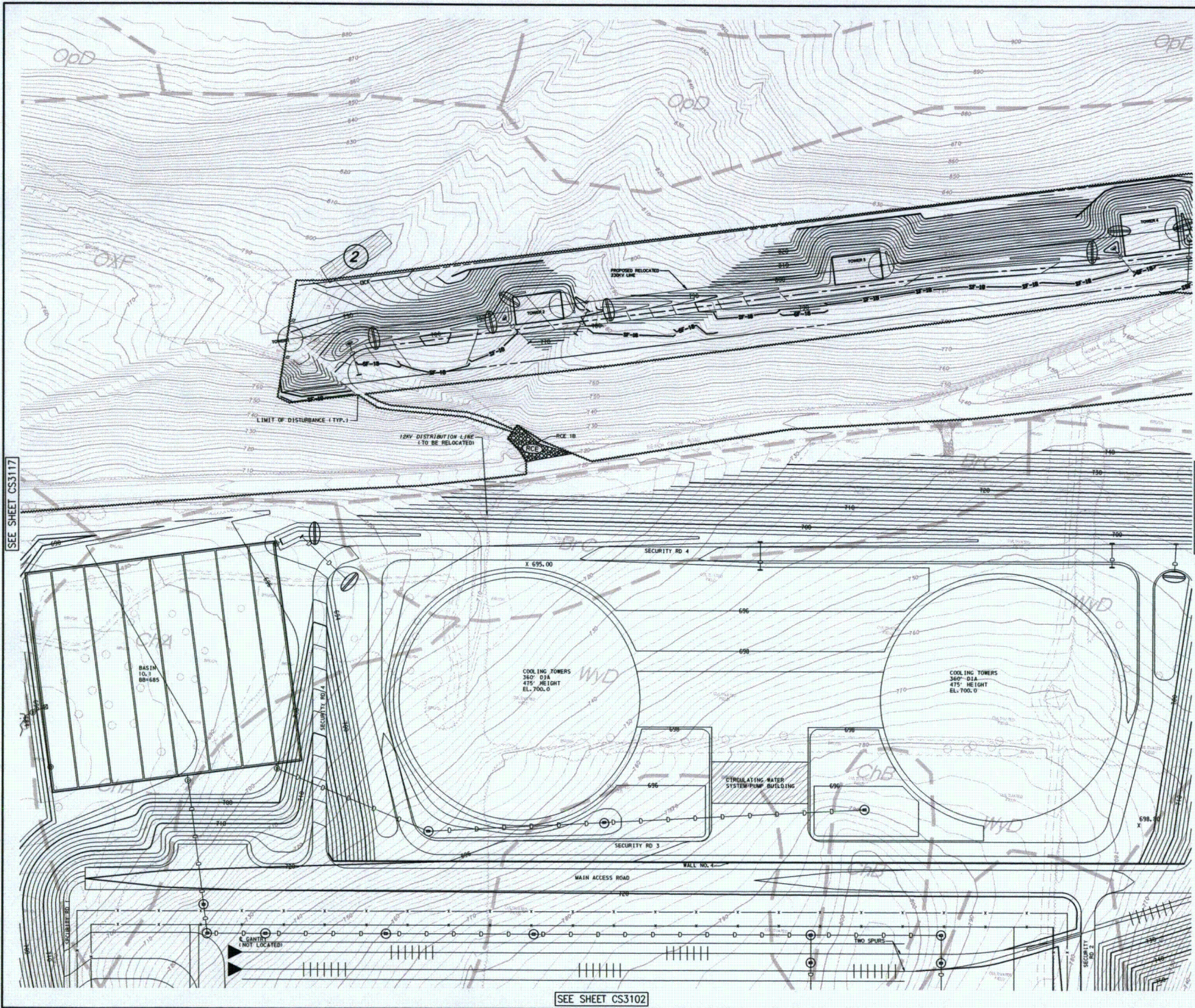

SEE SHEET CS3102

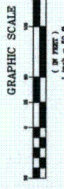

Pennoni Associates Inc.

100 N. Wilson-Berry Boulevard
Wilson-Berry, PA 17107 (717) 864-6800

Engineers • Surveyors • Planners • Landscape Architects

BELL BEND NUCLEAR POWER PLANT

JOINT PERMIT PLANS

PPL BELL BEND, LLC
38 BONDY LANE, SUITE 2
BELL BEND, PA 18011

DATE	11/15/2011	PROJECT NO.	PPL50902
BY	WCH	SHEET	3 OF 44
DATE	06/15/2011	PROJECT NO.	CS3101
APPROVED	JVM		

NO. OF SHEETS	44	DATE	NOV. 15, 2011
NO. OF SHEETS	44	DATE	NOV. 15, 2011
NO. OF SHEETS	44	DATE	NOV. 15, 2011
NO. OF SHEETS	44	DATE	NOV. 15, 2011

ALL DIMENSIONS MUST BE VERIFIED BY CONTRACTOR. DISCREPANCIES SHALL BE RESOLVED BY THE WORK.



SEE SHEET CS3118

SEE SHEET CS3101

SEE SHEET CS3103

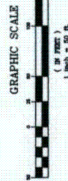
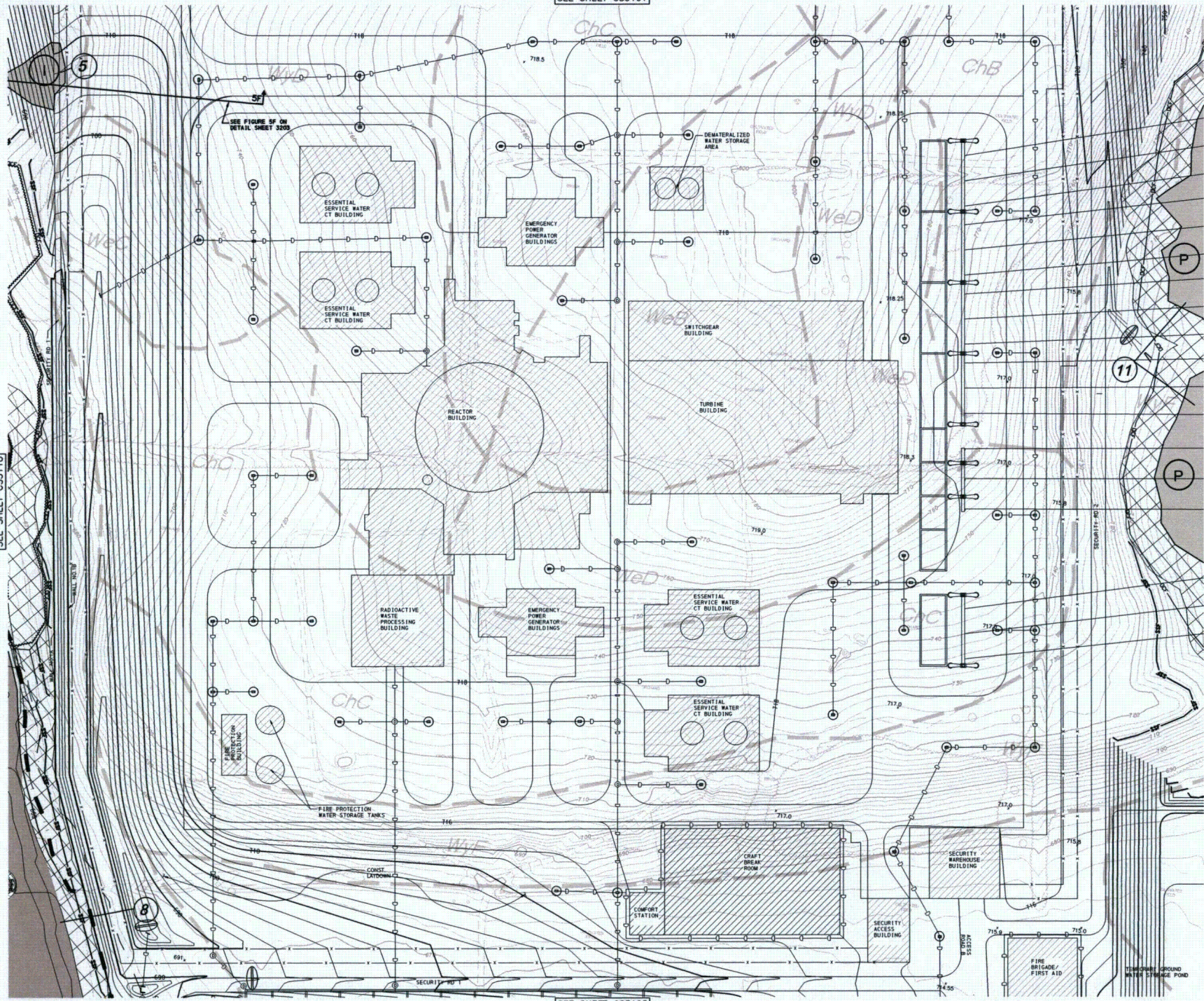

Pennoni Associates Inc.

100 N. Milner-Berry Boulevard
Waterbury, PA 18702 (610) 864-8800

Engineers • Surveyors • Planners • Landscape Architects

BELL BEND NUCLEAR POWER PLANT

JOINT PERMIT PLANS

PPL BELL BEND, LLC

ALL DIMENSIONS SHOWN IN FEET, UNLESS OTHERWISE NOTED.
ALL DIMENSIONS MUST BE VERIFIED BY CONSTRUCTOR.
ALL DIMENSIONS MUST BE VERIFIED BY CONSTRUCTOR.
ALL DIMENSIONS MUST BE VERIFIED BY CONSTRUCTOR.

DATE: 10/15/2011
DRAWN BY: WCK
CHECKED BY: JPH

CS3102
SHEET 4 OF 44



NO.	REVISION	DATE	BY	APP.
1	ISSUED FOR PERMIT	10/15/2011	JPH	
2	REVISED FOR PERMIT	10/15/2011	JPH	
3	REVISED FOR PERMIT	10/15/2011	JPH	
4	REVISED FOR PERMIT	10/15/2011	JPH	

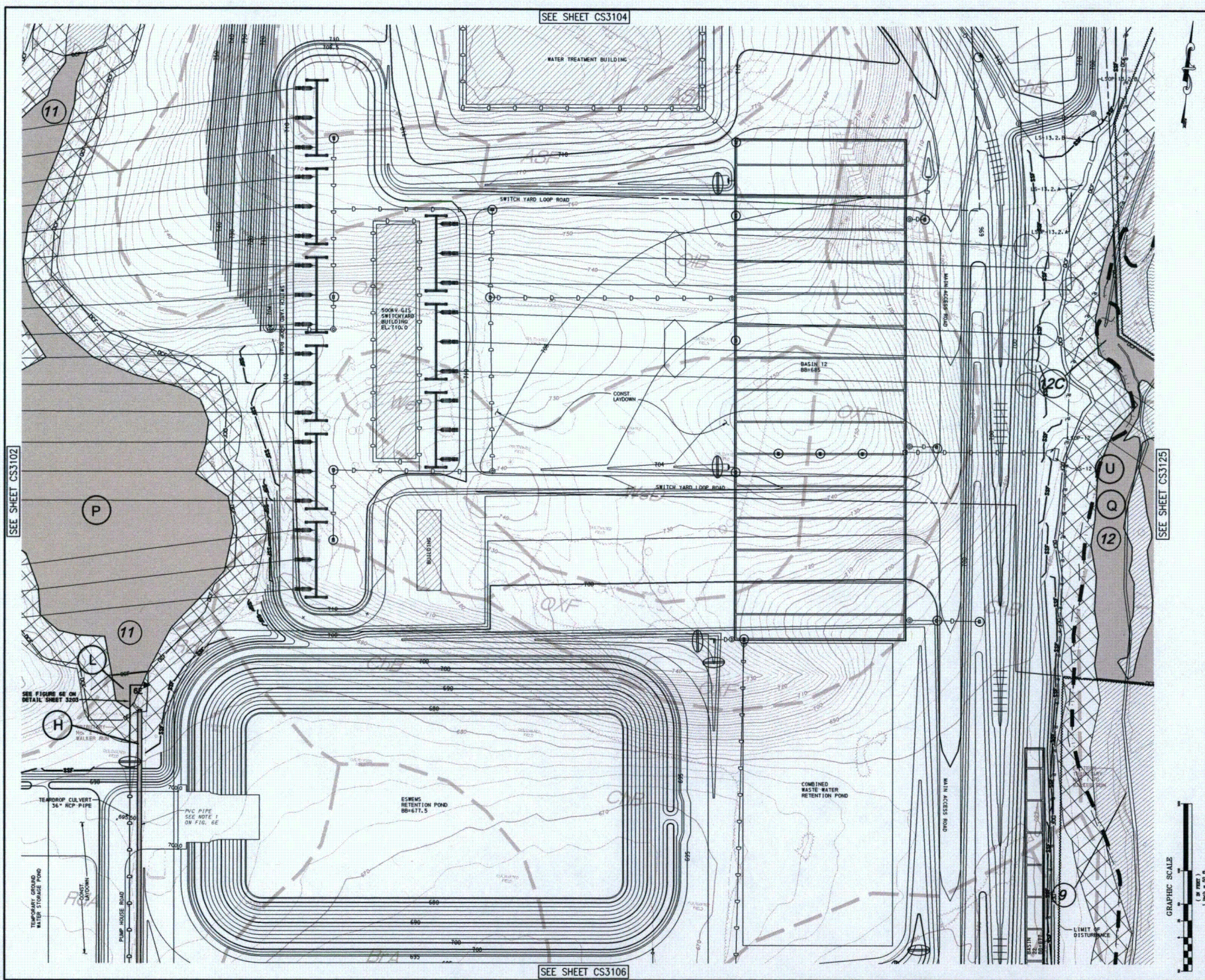

Pennoni Associates Inc.

100 N. Wilkes-Barre Boulevard
Wilkes-Barre, PA 18702 (570) 624-2200

Engineers • Surveyors • Planners • Landscape Architects

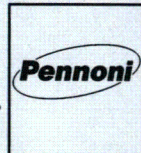

BELL BEND NUCLEAR POWER PLANT

SALEM TOWNSHIP, PENNSYLVANIA
JOINT PERMIT PLANS

PPL BELL BEND, LLC

ALL DOCUMENTS PREPARED BY PENKOW ASSOCIATES ARE
PREPARED IN WHOLE OR IN PART BY THE PRIVATE
PERSONS WHO ARE NOT NEEDED OR INCAPABLE TO BE OBTAINED
FOR REUSE BY OWNER OR OTHERS ON EXTENSIONS OF
THE PROJECT OR ON ANY OTHER PROJECT. ANY REUSE
WITHOUT WRITTEN NOTIFICATION OF ADAPTATION BY PENKOW
ASSOCIATES FOR THE SPECIFIC PURPOSE REPRODUCED WILL BE
AT OWNERS RISK AND WITHOUT LIABILITY ON LOCAL
EXPOSURE TO POLLUTION OR OTHER HAZARDOUS
SUBSTANCES. NO UNLAWFUL PENKOW ASSOCIATES
FROM ALL CLAIMS, DAMAGES, LOSSES AND EXPENSES
ARISING OUT OF OR RESULTING THEREFROM.

	JOB NO. PPLS0902
	SHEET 7 OF 44

SCALE 1"=50'	DRAWING NO. CS3105
DRAWN BY WCK	
DATE 06/15/2011	
APPROVED JFM	

SEE SHEET CS3121

SEE SHEET CS3106

SEE SHEET CS3109

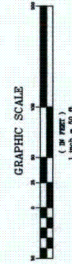

Penloni Associates Inc.

100 N. Millersburg Road
 Millersburg, PA 17058 (717) 864-8000

Engineers • Surveyors • Planners • Landscape Architects

<p>ALL DIMENSIONS MUST BE VERIFIED BY CONTRACTOR BEFORE CONSTRUCTION. ANY DISCREPANCIES MUST BE REPORTED TO THE OWNER.</p>	
<p>100 N. Millersburg Road Millersburg, PA 17058 (717) 864-8000</p>	
<p>BELL BEND NUCLEAR POWER PLANT</p>	
<p>JOINT PERMIT PLANS</p>	
<p>PPL BELL BEND, LLC</p>	
<p>30 BELL BEND LANE, SUITE 1 BELL BEND, PA 17003</p>	
<p>DATE: 06/15/2011</p>	<p>BY: JFM</p>
<p>PROJECT NO.: PPL50992</p>	<p>SHEET 5 OF 44</p>
<p>CS3107</p>	



Pennoni Associates Inc.

100 N. Wilson-Berry Boulevard
Wilson-Berry, PA 17097 610-584-2800

Engineers • Surveyors • Planners • Landscape Architects

DATE	06/15/2011
BY	JFM
CHECKED BY	WDC
DATE	06/15/2011
BY	JFM

BELL BEND NUCLEAR POWER PLANT
JOINT PERMIT PLANS
PPL BELL BEND, LLC
38 ENERGY LANE, SUITE 2
BETHLEHEM, PA 18010

NO.	DATE	BY	REVISION
1	06/15/2011	JFM	ISSUED FOR PERMIT
2	06/15/2011	JFM	ISSUED FOR PERMIT
3	06/15/2011	JFM	ISSUED FOR PERMIT

ALL DIMENSIONS MUST BE VERIFIED BY THE CONTRACTOR BEFORE CONSTRUCTION. ANY DISCREPANCIES MUST BE RESOLVED BEFORE PROCEEDING WITH THE WORK.
--

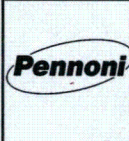

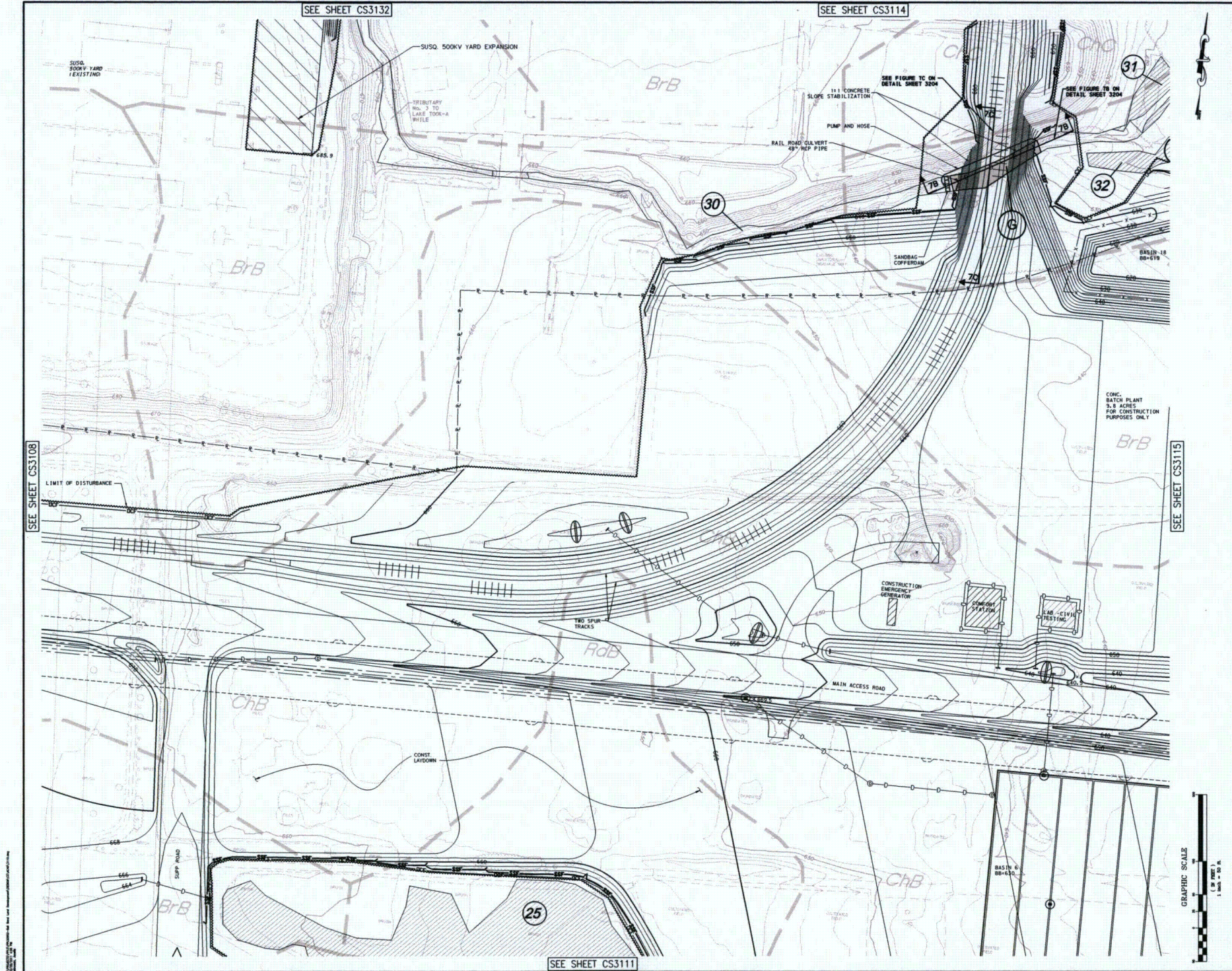

Pennoni

Engineers • Surveyors • Planners • Landscape Architects

100 N. Willow-Berry Boulevard
Warren-Burns, PA 15090 (717) 864-8900

BELL BEND NUCLEAR POWER PLANT

JOINT PERMIT PLANS

PPL BELL BEND, LLC

20 BURNING LANE, SUITE 2
BELL BEND, PA 15003

Pennoni Associates Inc.

ALL DIMENSIONS MUST BE VERIFIED BY CONSTRUCTION TEAM AND FIELD SURVEYORS BEFORE PROCEEDING WITH THE WORK.

DATE: 06/15/2011

PROJECT: PPLS0902

SHEET: 12 OF 44

SCALE: 1"=50'

DATE: 06/15/2011

PROJECT: CS3110

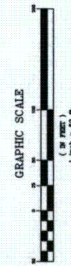
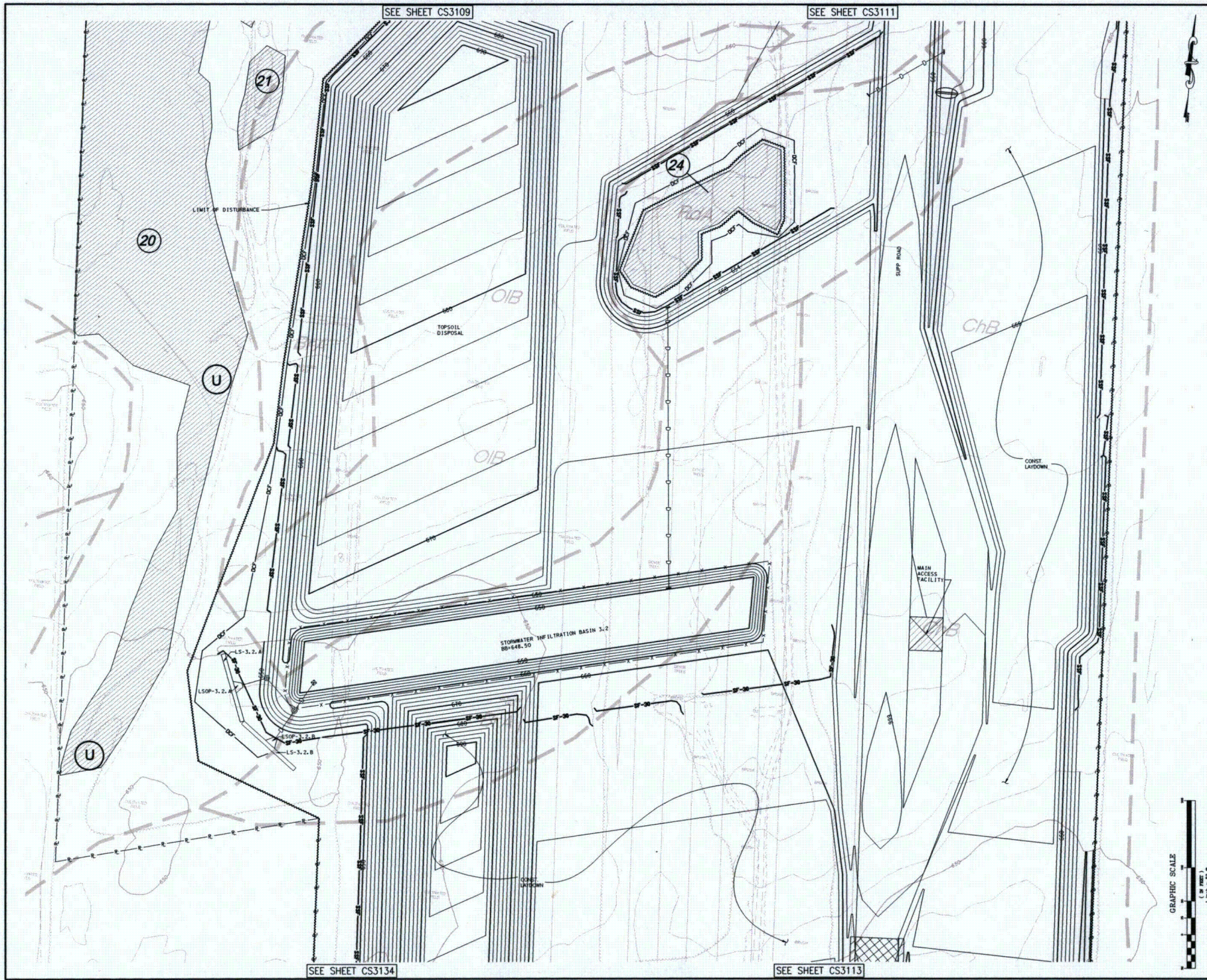

Pennoni Associates Inc.

100 N. Willow-Berry Boulevard
Willsboro, NY 12895 (815) 864-8800

Engineers • Surveyors • Planners • Landscape Architects

DATE	06/15/2011
WEEK	W06
PROJECT	JFM
SHEET	14 OF 44
PROJECT NO.	PPL30902

CS3112

BELL BEND NUCLEAR POWER PLANT

JOINT PERMIT PLANS

PPL BELL BEND, LLC
20 BELL BEND LANE, SUITE 1
BELL BEND, NY 12803

DATE	06/15/2011
WEEK	W06
PROJECT	JFM
SHEET	14 OF 44
PROJECT NO.	PPL30902

ALL DIMENSIONS MUST BE REVIEWED BY CONTRACTOR FOR ACCURACY. ANY DISCREPANCIES MUST BE RESOLVED BEFORE PROCEEDING WITH THE WORK.

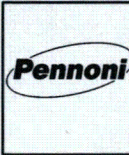



Pennoni Associates Inc.

100 N. Willow-Barry Boulevard
 Willow-Barry, PA 18702 (610) 864-2000

BELL BEND NUCLEAR POWER PLANT

JOINT PERMIT PLANS

PPL BELL BEND, LLC

30 BELL BEND, LLC, 1
 30 BELL BEND, LLC, 1
 30 BELL BEND, LLC, 1

Pennoni

Engineers • Surveyors • Planners • Landscape Architects

DATE	10/15/2011	BY	JFM
DATE	10/15/2011	BY	JFM
DATE	10/15/2011	BY	JFM

ALL DIMENSIONS MUST BE VERIFIED BY CONTRACTOR
 PRIOR TO CONSTRUCTION. ANY DISCREPANCIES
 SHALL BE THE RESPONSIBILITY OF THE CONTRACTOR.

APP NO.
 PPL00992

DATE
 06/15/2011

PROJECT
 CS3114

CS3115.dwg 06/15/2011 10:00 AM

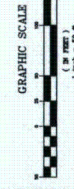

Pennoni Associates Inc.

100 N. Wilson-Berry Boulevard
Willsboro, PA 17092 (717) 864-2800

Engineers • Surveyors • Planners • Landscape Architects

DATE	06/15/2011
APPROVED	JPM
CS3115	

JOB NO.	PPL30902
SHEET	17 OF 44

BELL BEND NUCLEAR POWER PLANT
JOINT PERMIT PLANS
PPL BELL BEND, LLC
38 BROADWAY, SUITE 200
BIRMINGHAM, AL 35203

ALL DIMENSIONS MUST BE VERIFIED BY CONTRACTOR
ON SITE AND RECORDED BEFORE PROCEEDING INTO THE WORK

NO.	DATE	REVISION
1	06/15/11	ISSUED FOR PERMITTING AND BIDDING
2	06/15/11	ISSUED FOR BIDDING
3	06/15/11	ISSUED FOR BIDDING
4	06/15/11	ISSUED FOR BIDDING
5	06/15/11	ISSUED FOR BIDDING

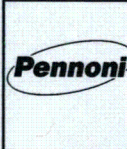

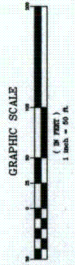
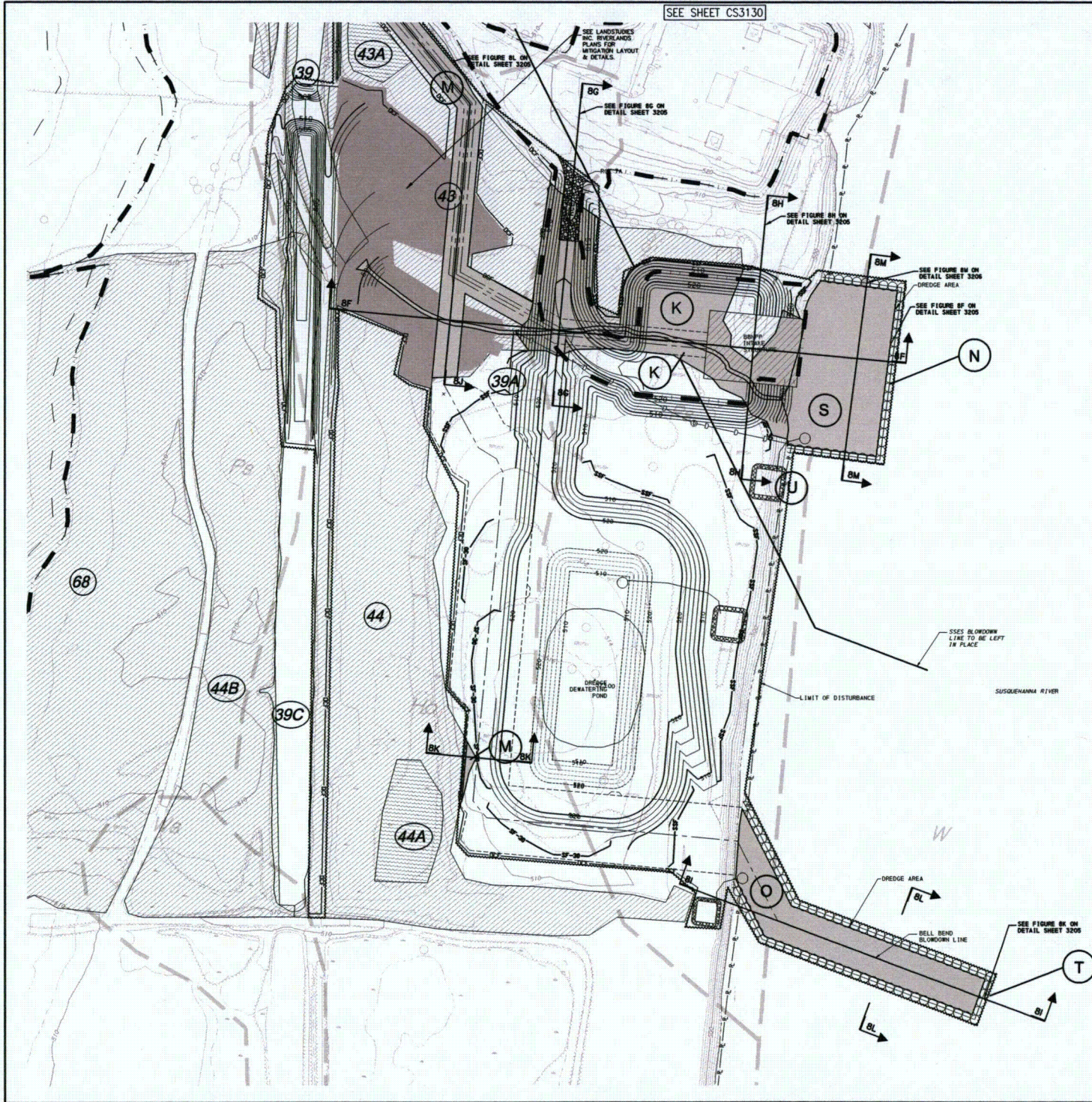

Pennoni Associates Inc.

100 N. Willow-Barry Boulevard
Willow-Barry, PA 19102 (610) 864-8000

Engineers • Surveyors • Planners • Landscape Architects

CS3116

18 OF 44

PPL50992

BELL BEND NUCLEAR POWER PLANT
JOINT PERMIT PLANS
PPL BELL BEND, LLC
SUSQUEHANNA RIVER
BELL BEND, PA 19102

ALL DIMENSIONS MUST BE VERIFIED BY CONTRACTOR
ON SITE PRIOR TO CONSTRUCTION AND RECORDING
IN THE FIELD

DATE	NO.	REVISIONS
11/15/2011	1	REVISION 1: ADD 10' BUFFER
11/15/2011	2	REVISION 2: ADD 10' BUFFER
11/15/2011	3	REVISION 3: ADD 10' BUFFER
11/15/2011	4	REVISION 4: ADD 10' BUFFER
11/15/2011	5	REVISION 5: ADD 10' BUFFER
11/15/2011	6	REVISION 6: ADD 10' BUFFER
11/15/2011	7	REVISION 7: ADD 10' BUFFER
11/15/2011	8	REVISION 8: ADD 10' BUFFER
11/15/2011	9	REVISION 9: ADD 10' BUFFER
11/15/2011	10	REVISION 10: ADD 10' BUFFER

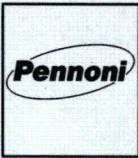

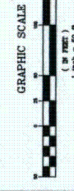

SEE SHEET CS3101

SEE SHEET CS3118

Pennoni Associates Inc.

100 N. Wilson-Burns Boulevard
Willsboro, NY 12895 518-481-2000

Engineers • Surveyors • Planners • Landscape Architects

DATE	06/15/2011
BY	JPM
APPROVED	JPM
CS3117	

BELL BEND NUCLEAR POWER PLANT
JOINT PERMIT PLANS
PPL BELL BEND, LLC
38 ENERGY LANE, SUITE 2
BELL BEND, NY 12813

NO. 1	REVISED	REVISION	DATE
1	REVISED	REVISION	DATE
2	REVISED	REVISION	DATE
3	REVISED	REVISION	DATE
4	REVISED	REVISION	DATE
5	REVISED	REVISION	DATE

ALL DIMENSIONS MUST BE OBTAINED BY CONSTRUCTION SURVEYORS AND MUST BE VERIFIED BY THE CONSTRUCTION SURVEYORS BEFORE PROCEEDING WITH THE WORK	
--	--

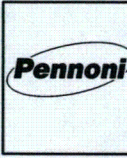

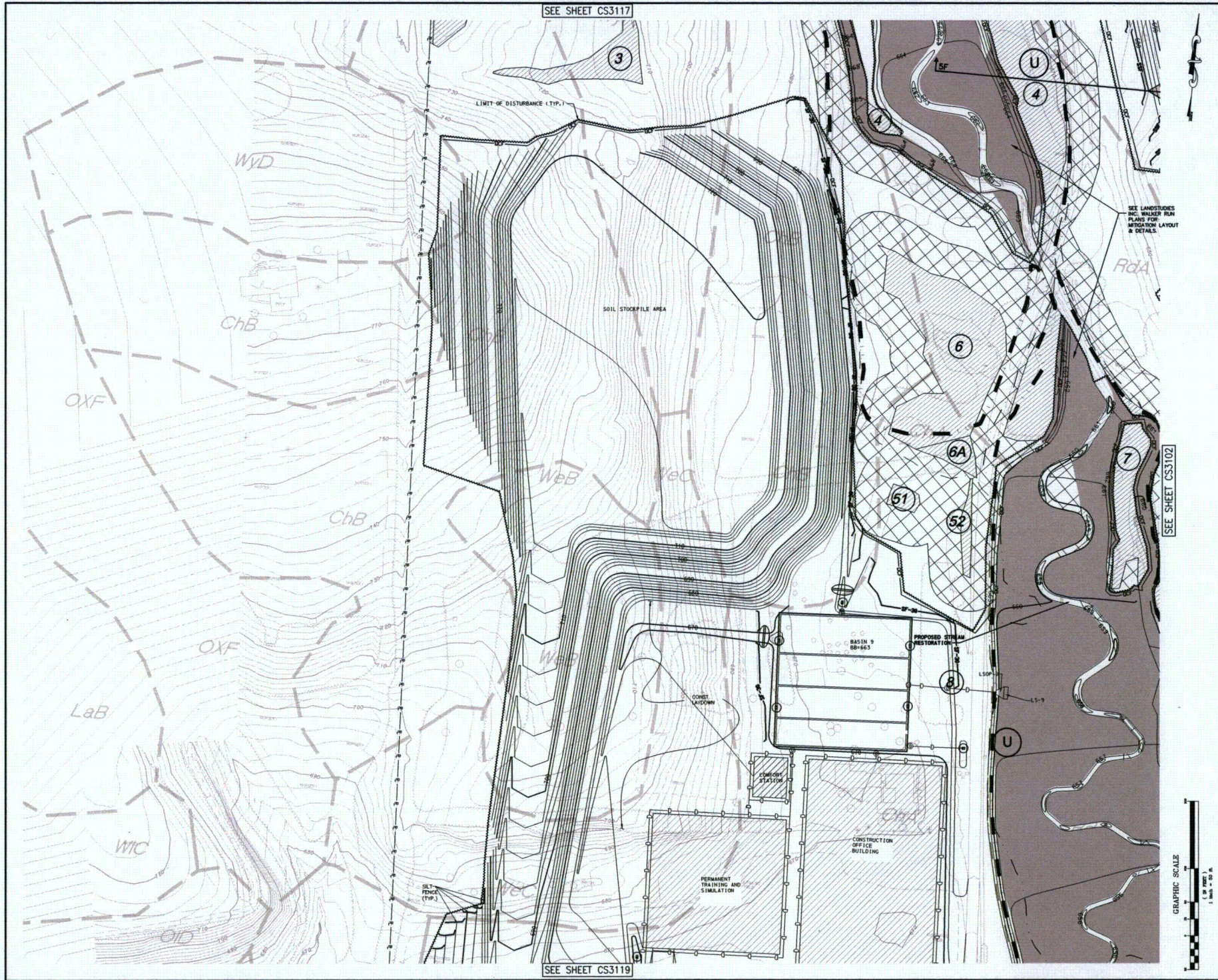

Pennoni Associates Inc. Engineers • Surveyors • Planners • Landscape Architects

BELL BEND NUCLEAR POWER PLANT

JOINT PERMIT PLANS

PPL BELL BEND, LLC

300 N. Wilson-Berry Boulevard
Wilson-Berry, PA 15702 (870) 864-8900

SALVA TERRAZZO, PENNSYLVANIA

DATE: 06/15/2011
BY: WCK
CHECKED: JFM

CS3118

Pennoni

NO.	DATE	DESCRIPTION
1	06/15/2011	ISSUED FOR PERMITTING
2	06/15/2011	ISSUED FOR PERMITTING
3	06/15/2011	ISSUED FOR PERMITTING
4	06/15/2011	ISSUED FOR PERMITTING
5	06/15/2011	ISSUED FOR PERMITTING
6	06/15/2011	ISSUED FOR PERMITTING
7	06/15/2011	ISSUED FOR PERMITTING
8	06/15/2011	ISSUED FOR PERMITTING
9	06/15/2011	ISSUED FOR PERMITTING
10	06/15/2011	ISSUED FOR PERMITTING

ALL DIMENSIONS MUST BE VERIFIED BY CONTRACTOR
AND FIELD SURVEYOR. ANY DISCREPANCIES
MUST BE CORRECTED BEFORE PROCEEDING WITH THE WORK.

DATE: 06/15/2011
BY: WCK
CHECKED: JFM



Penloni Associates Inc.

100 N. Wilson-Berry Boulevard
Wilson-Berry, PA 17252 (717) 841-0000

BELL BEND NUCLEAR POWER PLANT

JOINT PERMIT PLANS

PPL BELL BEND, LLC

38 BOMBAY LANE, SUITE 2
BETHLEHEM, PA 18020

DATE: 06/15/2011

APPROVED: JPM

PROJECT NO: PPLS0902

SHEET: 21 OF 44

SCALE: 1"=50'

DATE: 06/15/2011

APPROVED: JPM

Penloni

Engineers • Surveyors • Planners • Landscape Architects

NO.	REVISION	DATE	BY	CHK
1	REVISED FLOOD AREA AND SHA	06/15/2011	JPM	JPM
2	REVISED FLOOD AREA AND SHA	06/15/2011	JPM	JPM

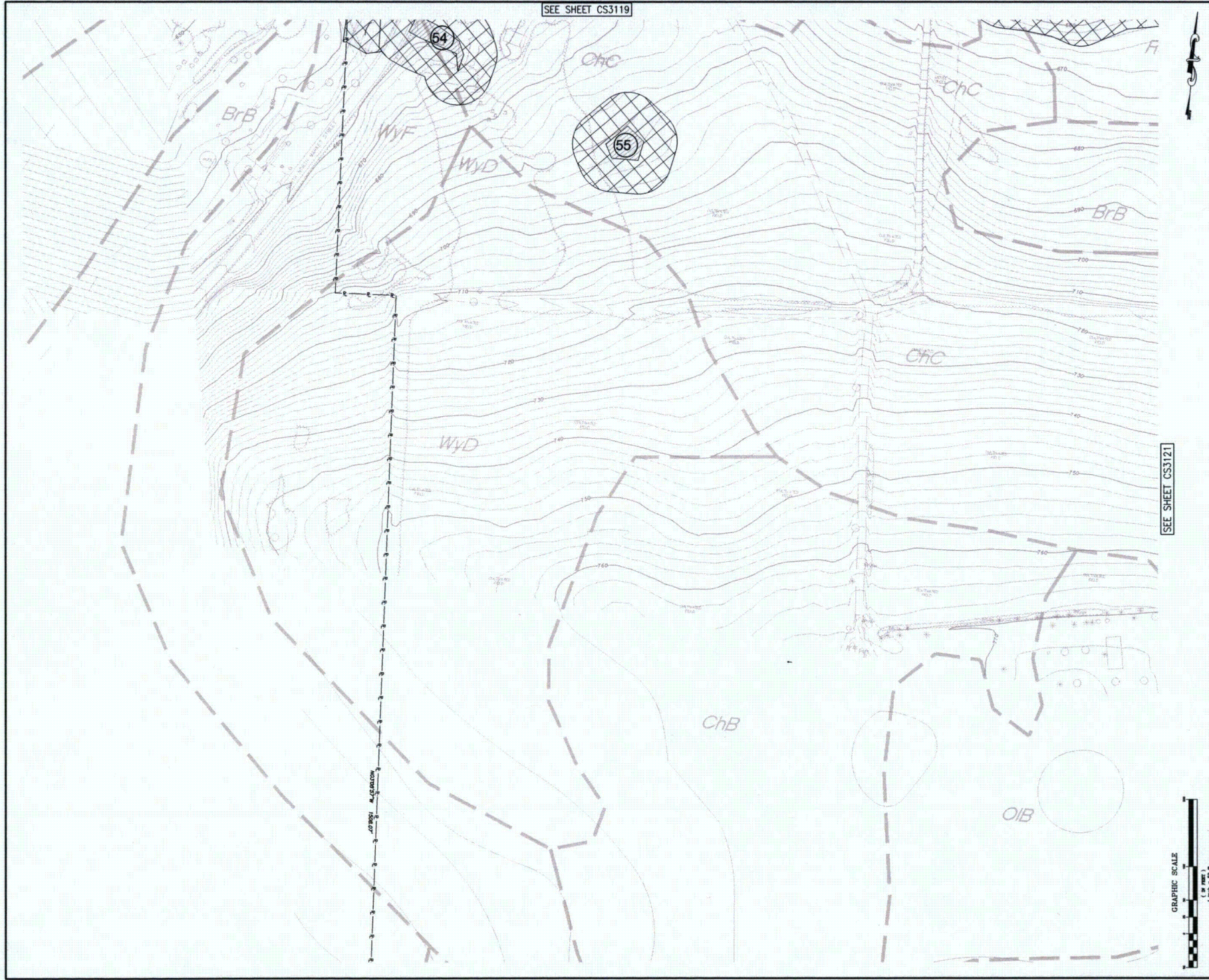

SEE SHEET CS3119

SEE SHEET CS3121

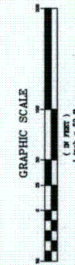

Pennoni Associates Inc.

100 N. Wilson-Snyder Boulevard
Wilson-Snyder, Pa 18702 (570) 864-2800

Engineers • Surveyors • Planners • Landscape Architects

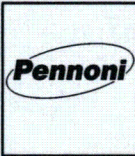

NO.	DATE	BY	CHKD	APP'D
1	06/15/2011	JPM		
2	06/15/2011	JPM		
3	06/15/2011	JPM		

ALL DIMENSIONS MUST BE VERIFIED BY CONSTRUCTION
FIELD SURVEYING. DISCREPANCIES SHALL BE RESOLVED BY THE
ENGINEER. THIS DOCUMENT IS THE PROPERTY OF PENNONI
ASSOCIATES INC. IT IS TO BE USED ONLY FOR THE PROJECT
SPECIFICALLY IDENTIFIED HEREON. IT IS NOT TO BE
REPRODUCED OR TRANSMITTED IN ANY FORM OR BY
ANY MEANS, ELECTRONIC OR MECHANICAL, WITHOUT
THE WRITTEN PERMISSION OF PENNONI ASSOCIATES
INC.

BELL BEND NUCLEAR POWER PLANT
JOINT PERMIT PLANS
PPL BELL BEND, LLC
30 BROADWAY, SUITE 200
BIRMINGHAM, AL 35203

THIS DOCUMENT IS A PRELIMINARY DESIGN AND SHOULD NOT BE USED FOR CONSTRUCTION WITHOUT THE WRITTEN PERMISSION OF PENNONI ASSOCIATES INC. IT IS TO BE USED ONLY FOR THE PROJECT SPECIFICALLY IDENTIFIED HEREON. IT IS NOT TO BE REPRODUCED OR TRANSMITTED IN ANY FORM OR BY ANY MEANS, ELECTRONIC OR MECHANICAL, WITHOUT THE WRITTEN PERMISSION OF PENNONI ASSOCIATES INC.

DATE	06/15/2011	DESIGNED BY	JPM
SCALE	1"=50'	CHECKED BY	JPM
WEEK		APPROVED BY	JPM
SHEET	22 OF 44	PROJECT NO.	CS3120