

T34N, R74W

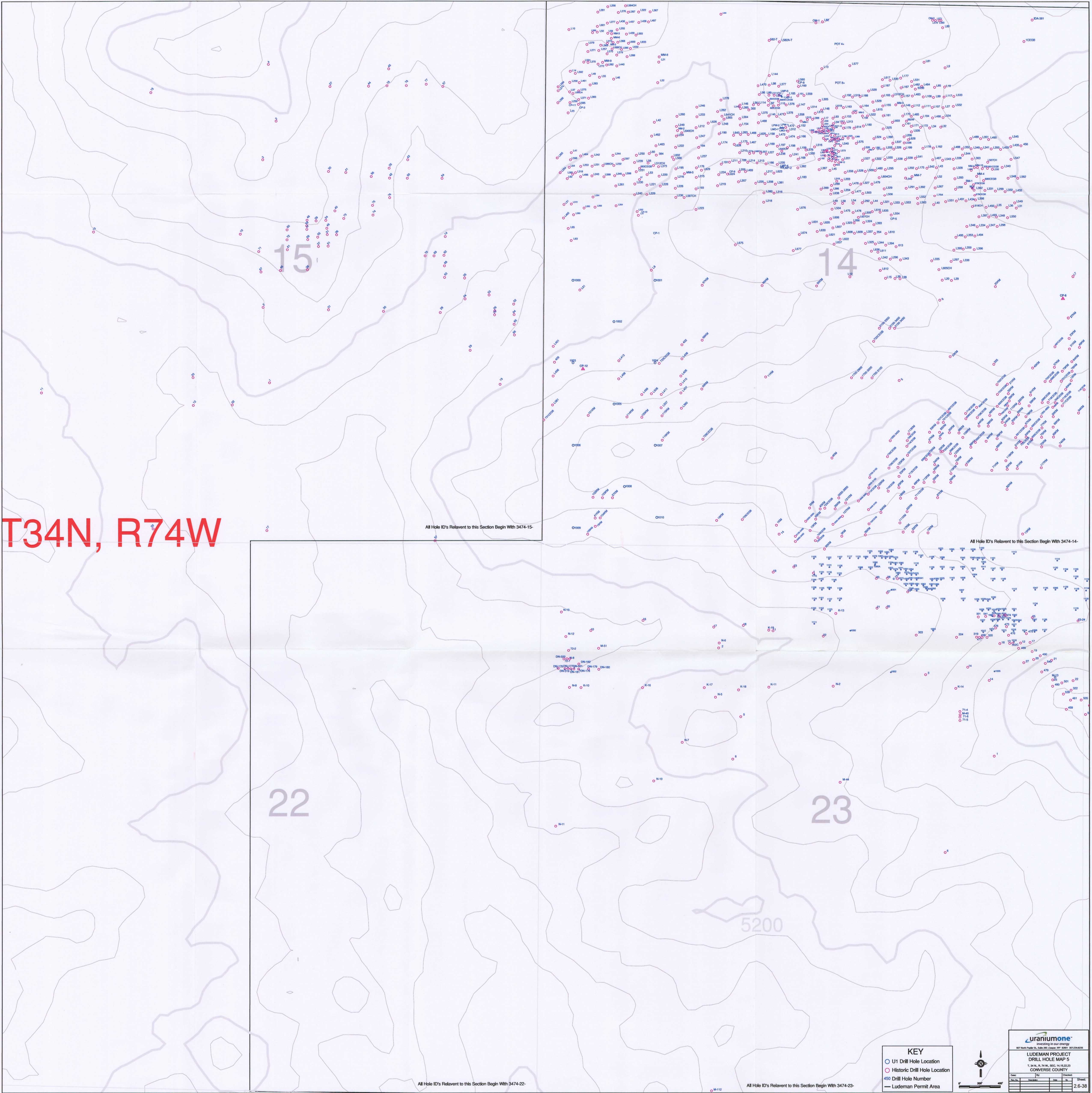

**KEY**

- U1 Drill Hole Location
- Historic Drill Hole Location
- 450 Drill Hole Number
- LUDEMAN PERMIT AREA

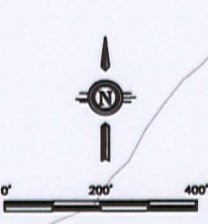

**uraniumone**  
Investing in our energy

**LUDEMAN PROJECT  
DRILL HOLE MAP 5**

T. 34 N., R. 74 W., SEC. 14, 15, 22, 23  
CONVERSE COUNTY

Date	By	Check	Date	By	Check

2.6-38