

Room 1217 Scoping Survey

Contents

Page

2	Floor Plan
3	Drawing of a typical 8-foot fume hood
4	Wipe test data for Hood 4
5	Object wipe results (one freezer)

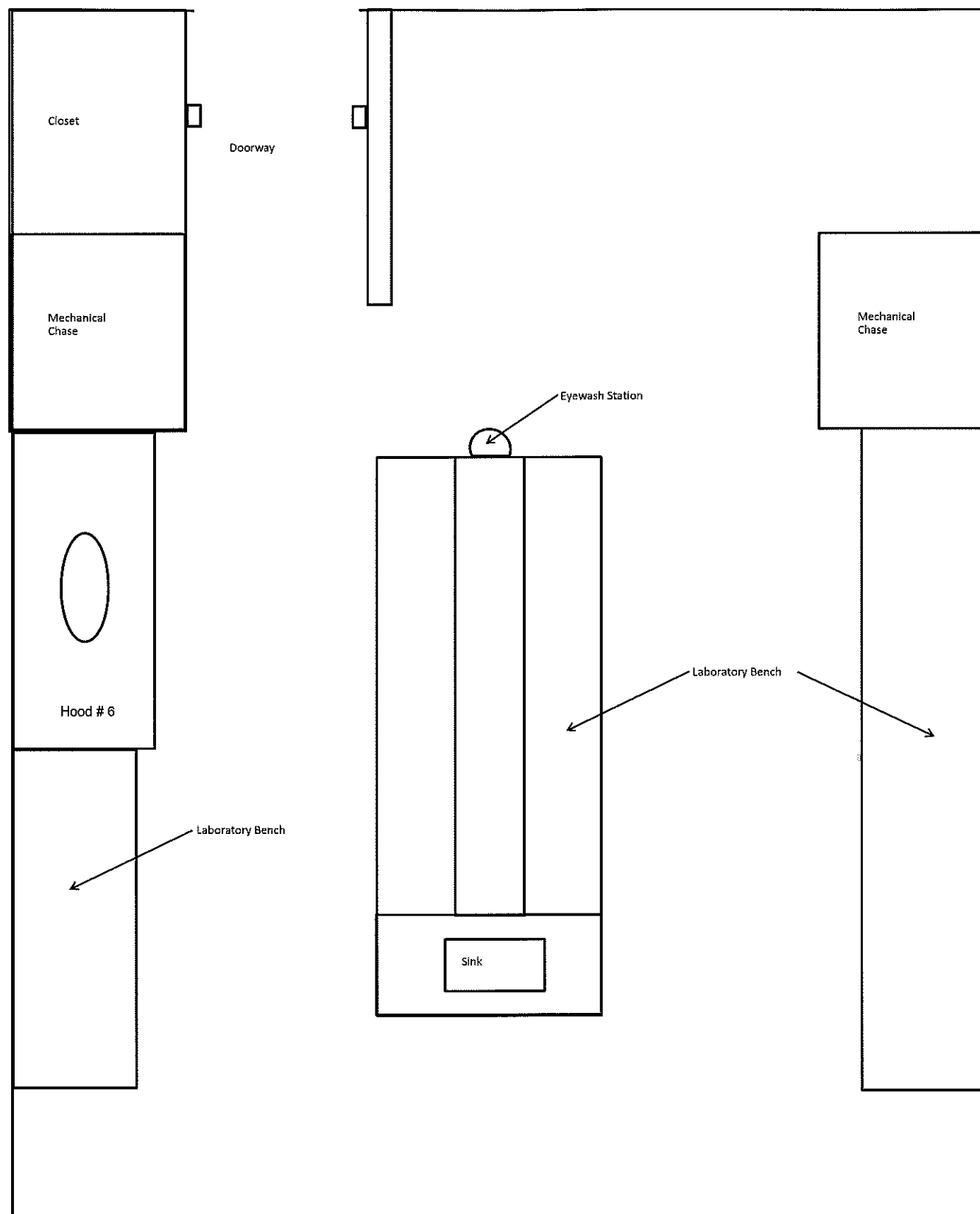

Floor Plan Room 1217

19 Pendleton Drive
Hebron, CT 06248
(860) 228-0487

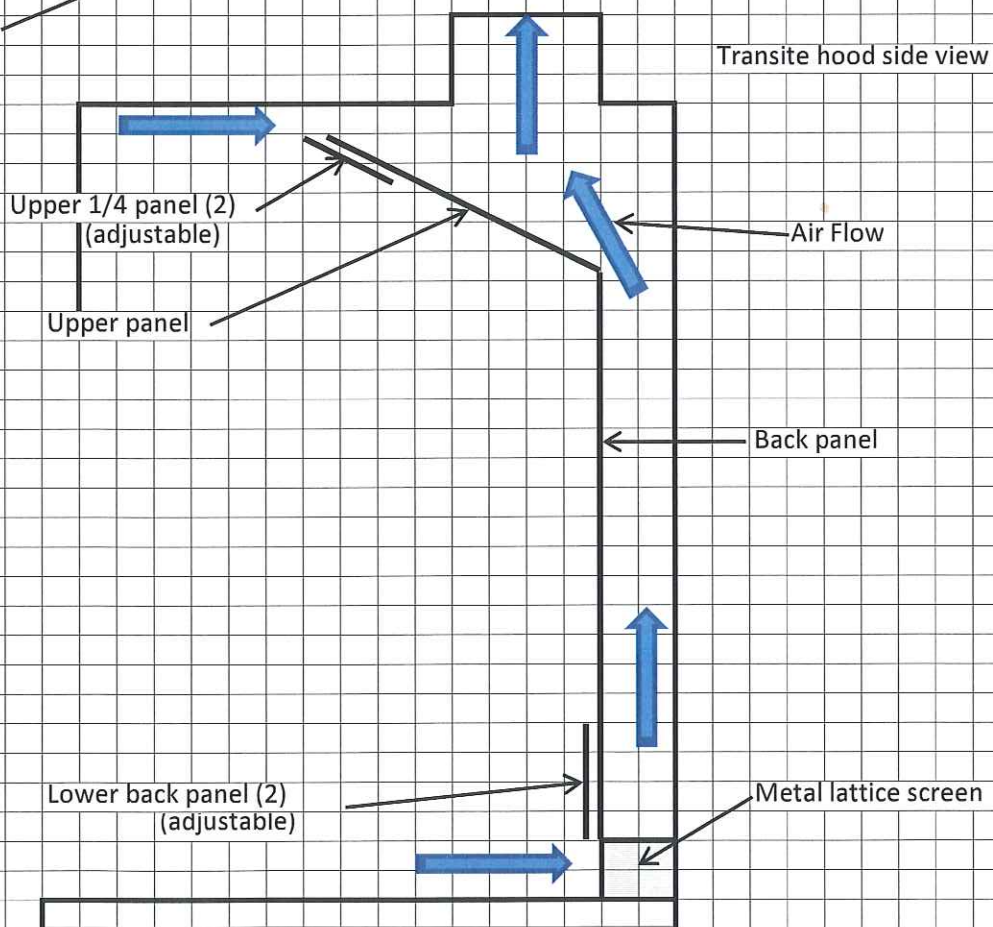
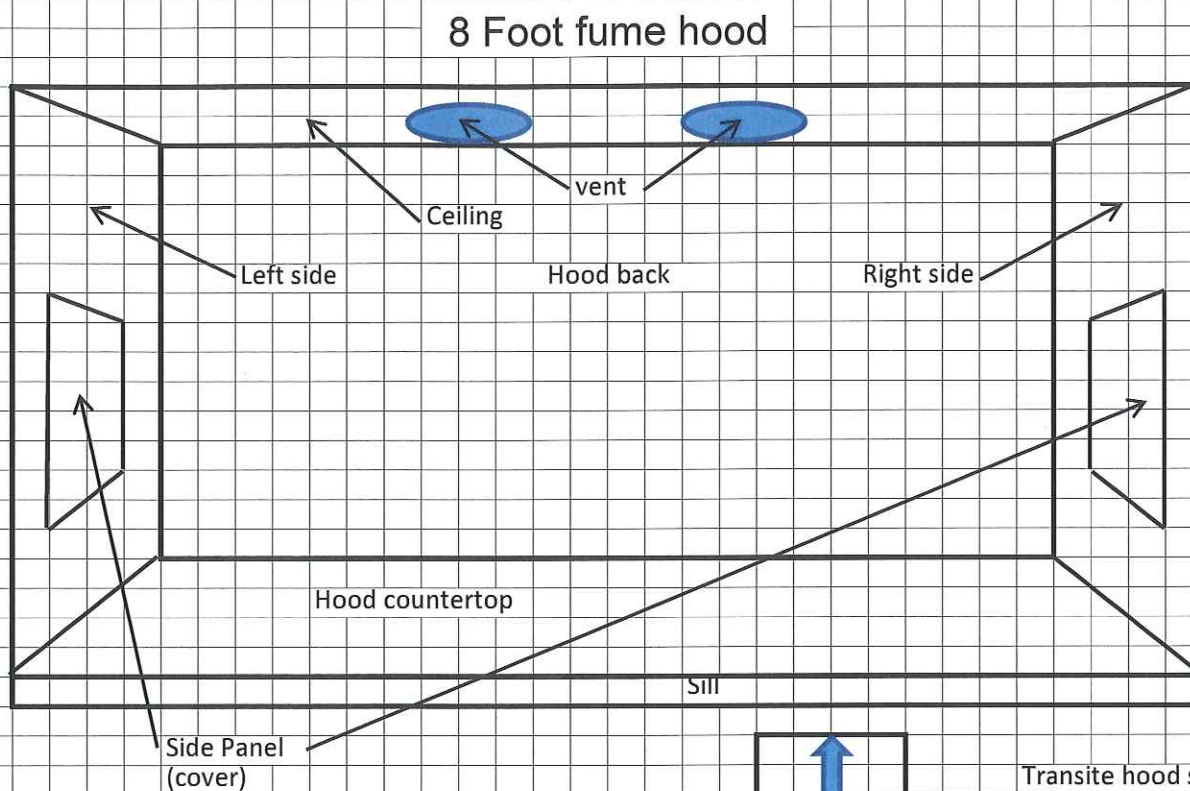

The following are removable

- 1 Upper 1/4 panel
- 2 Upper panel
- 3 Back panel
- 4 Lower Back panel
- 5 Side panel
- 6 Metal lattice screen

RSA Laboratories
A Division of Radiation Safety Associates
Radiochemistry Analysis Data Sheet

Page 1 of 1

Report No. **N/A**Customer: **Chemtura**Customer Samp No. **N/A**Location: **1217 Hood 6**RSA Lab Sample No. **N/A**Project: **Lab Decommissioning**Date Collected: **2/15/2011**Samp. Description: **Survey Wipes**Date Counted: **2/15/2011**Matrix: **Wipes****C-14 LLD dpm= 40.52**

RSA ID#	CUST. ID#	Location			C-14 CPM	dpm/100 cm sq
BG		BACKGROUND			35.40	
1		Left Side			13.40	14.40
2		Back Left Front			7.70	8.30
3		Back Right Front			0.00	0.00
4		Right Side			6.60	7.20
5		Left Countertop			21.10	22.80
6		Right Countertop			7.80	8.40
7		Sill			3.90	4.30
8		Upper back Left - Front			11.60	12.50
9		Upper back Right - Front			16.50	17.80
10		Upper back Left - Back			6.00	6.50
11		Upper back Right - Back			0.00	0.00
12		Left cover			5.60	6.10
13		Right cover			4.10	4.40
14		Hood Back Upper Left			0.00	0.00
15		Hood Back Upper Right			13.60	14.80
16		Hood Back Lower Left			0.00	0.00
17		Hood Back Lower Right			23.70	25.90
18		Lower Back Panel Left Front			0.00	0.00
19		Lower Back Panel Left Back			33.60	36.40
20		Lower Back Panel Right Front			18.90	20.50
21		Lower Back Panel Right Back			12.00	13.00
22		Upper 1/4 Panel Left Front			10.90	11.80
23		Upper 1/4 Panel Left Back			13.40	14.50
C-14		QC C-14			124319.60	134545.10
24		Upper 1/4 Panel Right Front			22.40	24.30
25		Upper 1/4 Panel Right Back			11.30	12.20
26		Back Glass Left			16.00	17.30
27		Back Glass Right			0.00	0.00
28		Screen			28.80	32.60
BL		QC Blank			0.00	0.00

Page 1 of 1

Customer: **Chemtura**

Location: 1217 Freezer FR-08

Project: **Lab Decommissioning**

Samp. Description: Survey Wipes

Matrix: **Wipes**

[illegible]

Room 1218 Scoping Survey

Contents

Page

2	Floor Plan
3	Drawing of a typical 8-foot fume hood
4	Wipe test data for Hood 8
5	List of objects surveyed
6-7	Object wipe results

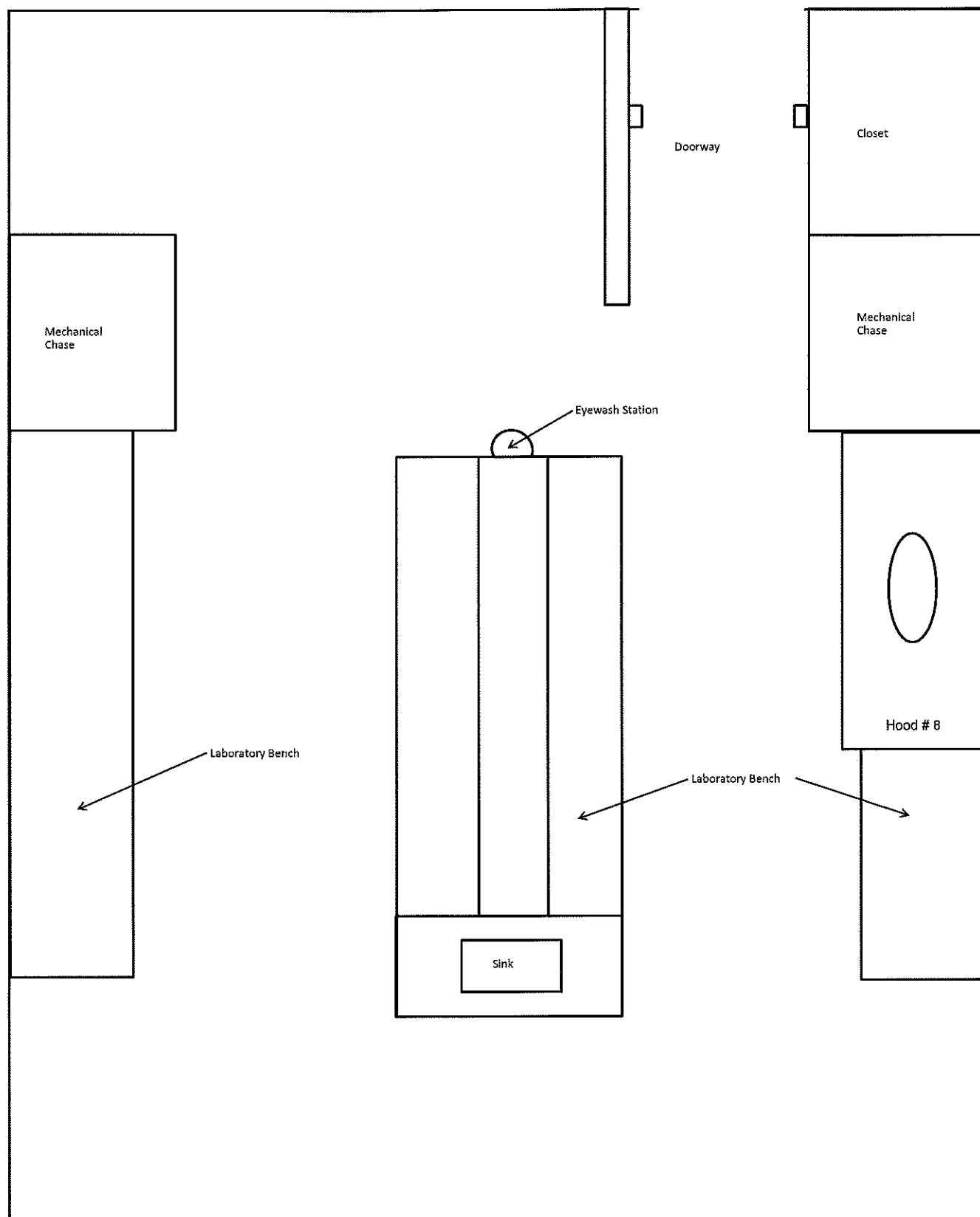

Floor Plan Room 1218

19 Pendleton Drive
Hebron, CT 06248
(860) 228-0487

8 Foot fume hood

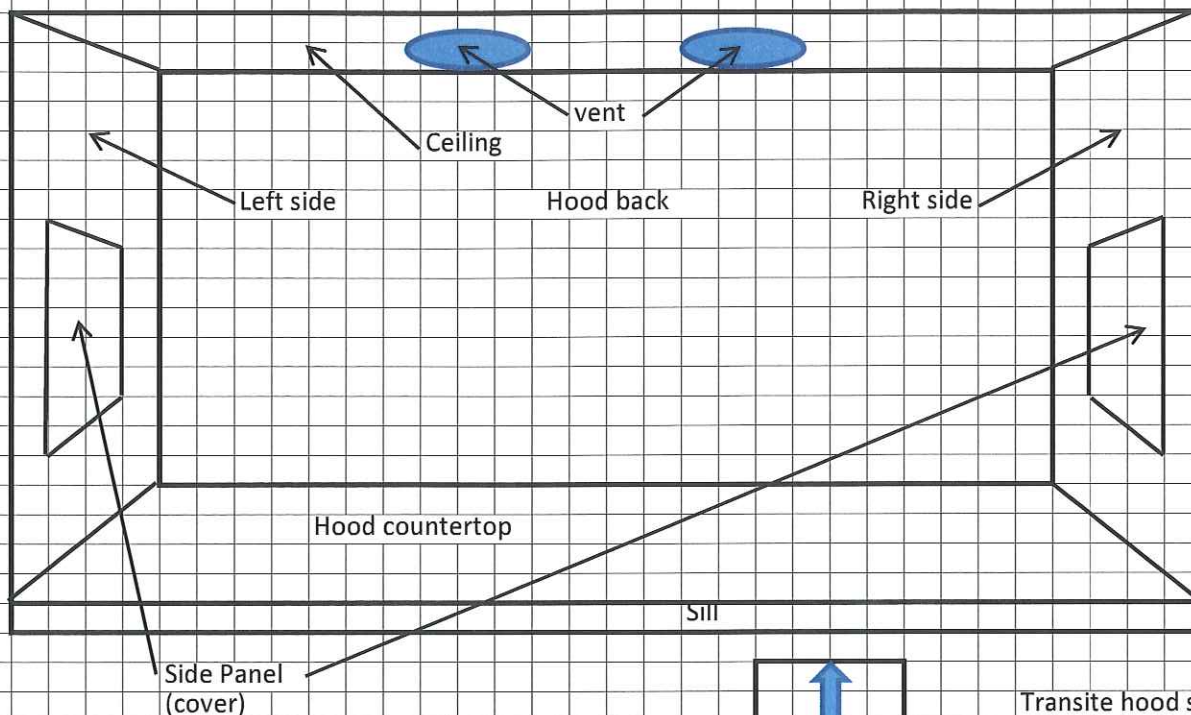

Transite hood side view

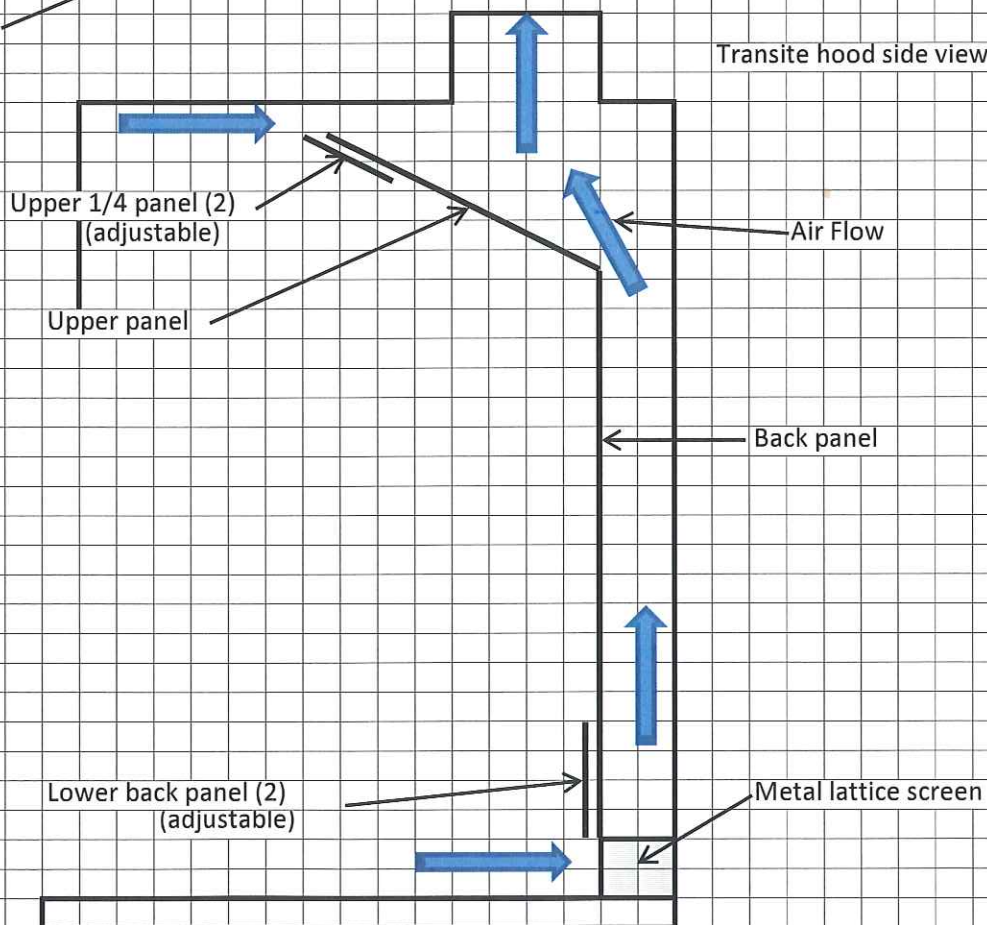

The following are removable

- 1 Upper 1/4 panel
- 2 Upper panel
- 3 Back panel
- 4 Lower Back panel
- 5 Side panel
- 6 Metal lattice screen

RSA Laboratories
A Division of Radiation Safety Associates
Radiochemistry Analysis Data Sheet

Page 1 of 1

Report No. **N/A**Customer Samp No. **N/A**RSA Lab Sample No. **N/A**Date Collected: **02/04/2011 - 02/15/2011**Date Counted: **02/04/2011 - 02/15/2011**Customer: **Chemtura**Location: **1218 Hood 8**Project: **Lab Decommissioning**Samp. Description: **Survey Wipes**Matrix: **Wipes****C-14 LLD dpm= 42.10**

RSA ID#	CUST. ID#	Location		C-14 CPM	dpm/100 cm sq
BG		BACKGROUND		38.50	
1		Lower Back Right Front		1.10	1.20
2		Lower Back Right Back		10.20	11.10
3		Lower Back Left Front		0.00	0.00
4		Lower Back Left Back		9.10	9.80
5		Upper 1/4 Right Front		8.50	9.20
6		Upper 1/4 Right Back		0.90	0.90
7		Upper 1/4 Left Front		0.00	0.00
8		Upper 1/4 Left Back		7.30	8.10
9		Left Side		12.60	13.60
10		Left Back Front		0.00	0.00
11		Right Back Back		10.00	10.90
12		Right Side		9.10	9.80
13		Left Upper Front		16.90	18.40
14		Right Upper Front		10.60	11.50
15		Left Counter		16.30	17.80
16		Right Counter		19.40	21.10
17		Sill		13.90	15.10
18		Glass Left Back		8.80	9.40
19		Glass Right Back		0.00	0.00
20		Right Upper Back		7.00	7.70
21		Left Upper Back		11.60	12.90
22		Screen		12.30	13.40
23		Right Below Back		23.40	25.40
C-14		QC C-14		122671.90	135444.30
24		Left Below Back		32.50	35.20
25		Right Above Back		5.40	5.90
26		Left Above Back		13.20	14.70
27		Right Vent		11.90	13.60
28		Left Vent		13.10	15.10
BL		QC Blank		10.80	11.70
29		Hood Back Upper Left		18.70	20.20
30		Hood Back Upper Right		18.80	20.30
31		Hood Back Lower Left		12.30	13.30
32		Hood Back Lower Right		2.50	2.70
33		Left cover		3.30	3.50
34		Right cover		9.20	9.90

Object # Description

196 Dionex UCI-100
197 Dionex P-580 Pump
198 Dionex UV Detector
199 Deskjet 720 C
200 Retriever II FRAC-16
201 Dell Computer PC-510
202 HPLC Radmonitor
203 Rotavapor R110 RV-09
204 Vacuum Pump
205 Water Bath
206 Evapotator N-EVAP-110
207 UPS
208 Centrifuge
209 FS 30 Water Bath
210 Vortex Stirrer
211 Grinder
212 Lateral File Cabinet
213 File Cabinet
214 File Cabinet
215 IBM Computer
216 Book Case
217 Phone
218 Refrigerator RF-22
219 Freezer FR-13
220 Weigh Table
317 File Cabinet
318 Rolling Computer Cart

RSA Laboratories
A Division of Radiation Safety Associates
Radiochemistry Analysis Data Sheet

Page 1 of 2

Report No. **N/A**Customer Samp No. **N/A**RSA Lab Sample No. **N/A**Date Collected: **2/2/2011**Date Counted: **2/2/2011**Customer: **Chemtura**Location: **1218 Objects**Project: **Lab Decommissioning**Samp. Description: **Survey Wipes**Matrix: **Wipes****C-14 LLD dpm= 40.98**

RSA ID#	CUST. ID#	Location	0 CPM	0 DPM	C-14 CPM	dpm/100 cm sq
BG		BACKGROUND			36.30	
1		Object 196			26.50	28.50
2		Object 197			24.50	26.30
3		Object 198			5.40	5.80
4		Object 199			19.00	20.50
5		Object 200			0.00	0.00
6		Object 201			6.20	6.60
7		Object 202			16.10	17.30
8		Object 203			16.10	17.40
9		Object 204			3.80	4.00
10		Object 205			20.30	21.90
11		Object 206			20.10	21.80
12		Object 207			22.30	23.90
13		Object 208			31.00	33.40
14		Object 209			32.00	34.40
15		Object 210			4.70	5.10
16		Object 211			37.40	40.20
17		Object 212			14.20	15.30
18		Object 213			8.10	8.80
19		Object 214			11.80	12.80
20		Object 215			24.60	26.40
21		Object 216			13.80	14.90
22		Object 217			13.90	15.00
23		Object 218 Top			17.70	19.10
C-14		QC C-14			123828.10	133839.30
24		Object 218 Right Side			12.70	13.70
25		Object 218 Left side			9.60	10.40
26		Object 218 Front			34.10	36.70
27		Object 218 Left Inside Freezer			9.20	9.90
28		Object 218 Botton freezer			5.00	5.40
29		Object 218 Right Inside Freezer			14.30	15.40
30		Object 218 Left Inside Fridge			55.60	59.80
31		Object 218 Back Fridge			61.70	66.40
32		Object 218 Right inside Fridge			8.40	9.10
33		Object 218 Bottom Fridge			85.70	92.20
34		Object 218 Inside Door Freezer			15.40	16.50

RSA Laboratories
A Division of Radiation Safety Associates
Radiochemistry Analysis Data Sheet

Page 2 of 2

RSA ID#	CUST. ID#	LOCATION			C-14 CPM	dpm/100 cm sq
35		Object 218 Inside Door Fridge			375.80	405.30
36		Object 219 Top			0.00	0.00
37		Object 219 Right Side			3.80	4.10
38		Object 219 Left Side			12.50	13.50
39		Object 219 Front			23.50	25.30
40		Object 219 Left Inside			135.00	145.50
41		Object 219 Back			7.90	8.50
42		Object 219 Right Inside			30.90	33.30
43		Object 219 Bottom			363.80	391.50
44		Object 219 Inside Door			205.30	221.30
45		Object 220			9.20	10.10
46		Object 317			10.00	10.80
BL		QC Blank			13.10	14.30
47		Object 318			19.00	20.70

Room 1219 Scoping Survey

Contents

Page

2	Floor Plan
3	List of objects surveyed
4-7	Object wipe results
8	Wipe results from removable benches

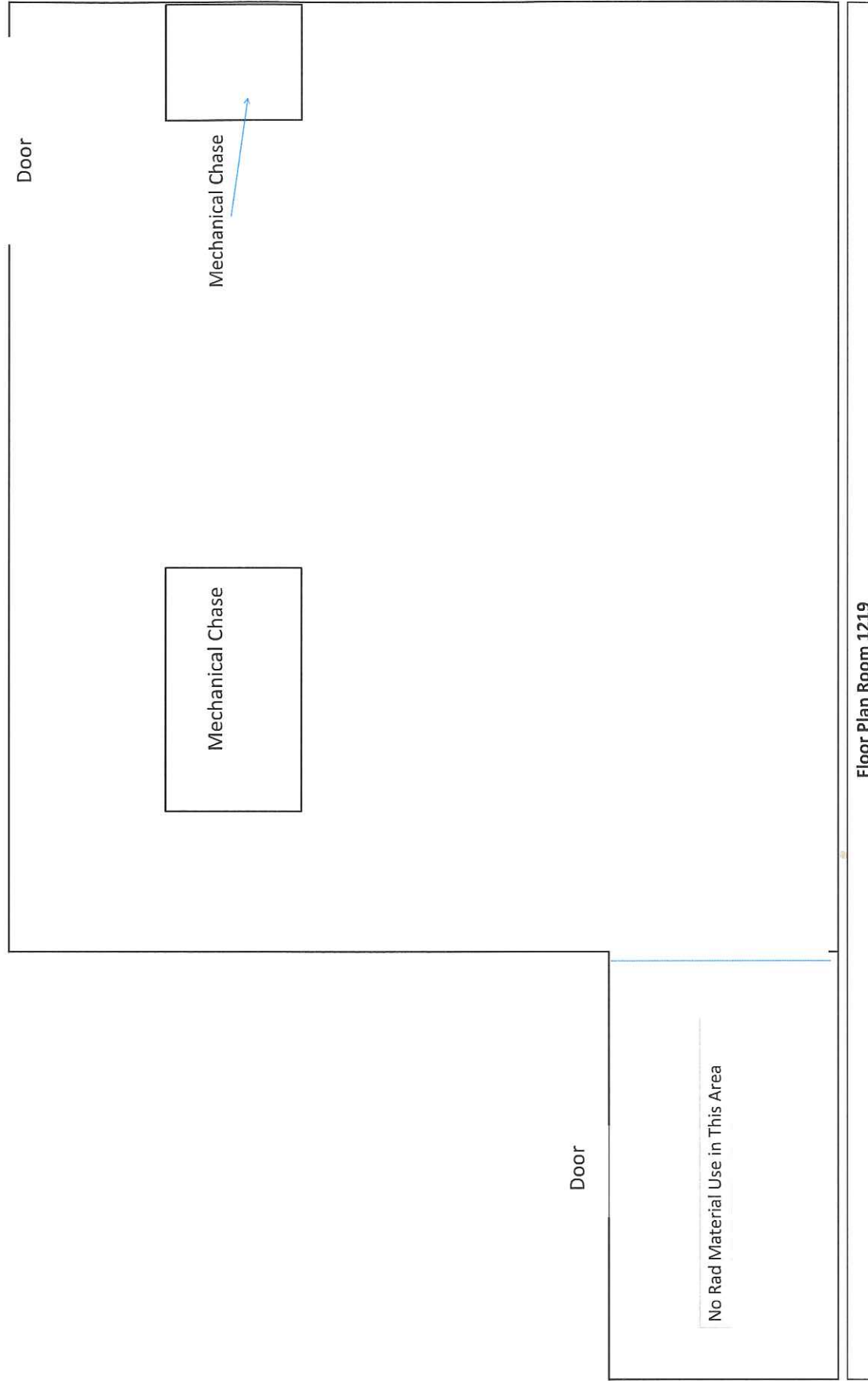

Object # Description

221 Sorval Centrifuge
222 PE Nelson 900 Interface
223 UPS
224 Model 410 Autosampler
225 Varian 9010 PM -38

226 Varian 9050 UV-26
227 Dell Monitor
228 Flammable Cabinet
229 Table
230 Computer IB< PCN-49
231 HP Printer
232 Phone
233 Computer Desk
234 Keyboards
235 Monitor & Keyboard
236 Computer CHP
237 Laserjet 4000
238 Table
239 Laserjet 1100 Printe
240 Computer PC -265
241 Monitor
242 Keyboard (Drawer)
243 P580 pump
244 ASI-100 Sample Inspector
245 Dionex PDA 100 UV Detector UV-41
246 Cary 50 Scan
247 Computer PC 264
248 Monitor
249 Keyboard Drawer
250 Deskjet 932 Printer
251 G-24 Incubator
252 H2-500 Hydrogen Generator
253 Agilent Tower 1 DI-03,AS-13 CH-06, UV-43
FL-02
254 Agilent Tower 2 LC-49, DGM-05, PM-66

Object # Description

255 HP Laserjet LC-41
256 Lenovo Computer
257 Monitor
258 Keyboard & Drawer
259 HP Tower 1 AS-10 CH-05, UV-35
260 HP Tower 2 SCM-02, DGM-03, PM-53
261 HP 5970 Detector MSD-01
262 HP 5890 GC-09
263 HP Controller CO-24
264 HP GC System GC-11
265 Allegre Centrifuge
266 HP Controller CO-32
267 HP GC System GC-10
268 Table
269 Table
270 Filing Cabinet
271 Lateral File
272 Sun Microsystems Computer
273 Sun Monitor
274 Keyboard
275 HP Laserjet 4000
276 Sun External/Storage *
277 Toshiba UPS
278 Varian Temp Controller
279 Vacuum Pump
280 HP Laserjet 2100
281 Ionization Gage
282 HP 7673 A
283 HP 7673 A
284 CFG Table
285 Freezer
286 Refrigerator RF
287 NMR Detector

RSA Laboratories
A Division of Radiation Safety Associates
Radiochemistry Analysis Data Sheet

Page 1 of 4

Report No. **N/A**Customer Samp No. **N/A**RSA Lab Sample No. **N/A**Date Collected: **02/02/2011 - 02/09/2011**Date Counted: **02/02/2011 - 02/09/2011**Customer: **Chemtura**Location: **1219 Objects**Project: **Lab Decommissioning**Samp. Description: **Survey Wipes**Matrix: **Wipes****C-14 LLD dpm= 43.57**

RSA ID#	CUST. ID#	Location		C-14 CPM	dpm/100 cm sq
BG		BACKGROUND		41.50	
1		Object 221 Top		19.20	20.70
2		Object 221 Front		9.40	10.10
3		Object 221 Controls		10.00	10.80
4		Object 222		11.00	11.90
5		Object 223		14.30	15.40
6		Object 224		14.30	15.50
7		Object 225		33.20	36.00
8		Object 226		16.20	17.60
9		Object 227		20.80	22.50
10		Object 228 Top		4.10	4.40
11		Object 228 Right Side		16.20	17.50
12		Object 228 Left Side		20.90	22.50
13		Object 228 Front		11.40	12.30
14		Object 228 Inside Left		22.90	24.60
15		Object 228 Shelf		14.40	15.50
16		Object 228 Inside Right		2.80	3.00
17		Object 228 Bottom		16.30	17.60
18		Object 228 Inside Door		9.60	10.40
19		Object 229		1.00	1.10
20		Object 230		11.90	12.80
21		Object 231		25.50	27.50
22		Object 232		13.90	15.00
23		Object 233		24.00	26.00
C-14		QC C-14		121624.80	134273.40
24		Object 234		14.30	415.60
25		Object 235		16.50	17.80
26		Object 236		12.80	13.80
27		Object 237		18.80	20.30
28		Object 238		0.00	0.00
29		Object 239		12.20	13.20
30		Object 240		23.10	25.30
31		Object 241		20.90	22.60
32		Object 242		15.50	16.80
33		Object 243		3.10	3.40
34		Object 244		0.00	0.00

RSA Laboratories
A Division of Radiation Safety Associates
Radiochemistry Analysis Data Sheet

Page 2 of 4

RSA ID#	CUST. ID#	LOCATION			C-14 CPM	dpm/100 cm sq
35		Object 245			0.00	0.00
36		Object 246			13.40	14.50
37		Object 247			22.50	24.30
38		Object 248			10.00	10.80
39		Object 249			0.00	0.00
40		Object 250			21.50	23.20
41		Object 251			12.20	13.20
42		Object 252			12.00	13.00
43		Object 253			14.80	16.00
44		Object 254			17.00	18.30
45		Object 255			9.80	10.60
46		Object 256			9.80	10.20
BL		QC Blank			7.60	8.20
47		Object 257			3.20	3.50
48		Object 258			13.50	14.60
49		Object 259			10.10	10.90
50		Object 260			11.90	12.80
51		Object 261			13.50	14.70
52		Object 262			9.80	10.60
53		Object 263			20.20	21.90
54		Object 264			11.60	12.60
55		Object 265			35.60	38.60
56		Object 266			19.70	21.30
57		Object 267			10.80	11.70
58		Object 268			13.90	15.00
59		Object 269			20.20	21.80
60		Object 270			18.30	19.80
61		Object 271			3.70	4.00
62		Object 272			10.00	10.80
63		Object 273			15.20	16.40
64		Object 274			11.50	12.40
65		Object 275			4.90	5.30
66		Object 276			16.80	18.30
67		Object 277			16.60	18.00
68		Object 278			10.00	11.00
69		Object 279			12.60	13.60
C-14		QC C-14			123882.00	133969.90
70		Object 280			19.20	20.80
71		Object 281			9.00	9.70
72		Object 282			9.70	10.50
73		Object 283			24.50	26.50

RSA Laboratories
A Division of Radiation Safety Associates
Radiochemistry Analysis Data Sheet

Page 3 of 4

RSA ID#	CUST. ID#	LOCATION			C-14 CPM	dpm/100 cm sq
74		Object 284			5.70	6.20
75		Object 287			10.00	10.90
76		Object 265 Inside			13.30	14.40
77		Object 265 Small Rotor			21.60	23.50
78		Object 265 Large Rotor			22.70	24.80
79		Object 221 Inside			22.00	23.80
C-14		QC C-14			121050.10	133816.20
80		Object 221 Rotor 1			6.80	7.30
81		Object 221 Rotor 2			0.00	0.00
82		Object 221 Large Rotor			29.90	32.80
83		Object 285 Top			14.60	15.80
84		Object 285 Left Side			17.30	18.60
85		Object 285 Right side			10.20	11.00
86		Object 285 Chamber 1 L inside			19.00	20.50
87		Object 285 Chamber 1 Back			25.10	27.00
88		Object 285 Chamber 1 R inside			31.60	34.00
89		Object 285 Chamber 1 Bottom			11.10	12.00
90		Object 285 Chamber 1 Inside door			12.20	13.20
91		Object 285 Chamber 2 L inside			9.50	10.30
92		Object 285 Chamber 2 Back			75.90	81.80
93		Object 285 Chamber 2 R inside			16.30	17.50
94		Object 285 Chamber 2 Bottom			10.20	10.90
95		Object 285 Chamber 2 Inside door			4.90	5.60
96		Object 285 Chamber 3 L inside			13.50	14.60
97		Object 285 Chamber 3 Back			9.70	10.40
98		Object 285 Chamber 3 R inside			14.10	15.20
99		Object 285 Chamber 3 Bottom			12.60	13.60
100		Object 285 Chamber 3 Inside door			19.20	20.70
101		Object 285 Chamber 4 L inside			8.50	9.20
102		Object 285 Chamber 4 Back			10.70	11.50
103		Object 285 Chamber 4 R inside			7.80	8.40
104		Object 285 Chamber 4 Bottom			0.00	0.00
105		Object 285 Chamber 4 Inside door			9.20	9.90
C-14		QC C-14			120848.30	133548.80
106		Object 285 Chamber 5 L inside			18.60	20.00
107		Object 285 Chamber 5 Back			14.70	15.80
108		Object 285 Chamber 5 R inside			13.10	14.10
109		Object 285 Chamber 5 Bottom			19.60	21.10
110		Object 285 Chamber 5 Inside door			21.40	23.10
111		Object 285 Front Door inside top			15.60	16.80
112		Object 285 Front Door inside bottom			9.60	10.40

RSA Laboratories
A Division of Radiation Safety Associates
Radiochemistry Analysis Data Sheet

Page 4 of 4

RSA ID#	CUST. ID#	LOCATION			C-14 CPM	dpm/100 cm sq
113		Object 285 Front door outside			0.00	0.00
114		Object 286 Top			0.80	0.90
115		Object 286 Right side			2.60	2.80
116		Object 286 Left side			38.10	41.10
117		Object 286 Front			14.30	15.30
118		Object 286 Left inside freezer			47.90	51.50
119		Object 286 Back freezer			14.00	15.10
120		Object 286 Right inside freezer			18.50	19.90
121		Object 286 Bottom freezer			9.90	10.60
122		Object 286 Left inside fridge			12.20	13.20
123		Object 286 Back fridge			19.80	21.40
124		Object 286 Right inside fridge			32.70	35.20
125		Object 286 Bottom fridge			19.40	20.80
126		Object 286 Inside door freezer			28.70	31.00
127		Object 286 Inside door fridge			18.10	19.50
128		Object 286 Racks			42.20	45.50
BL		QC Blank			22.10	24.10

Jay R. Dockendorff
Laboratory Director

Page 1 of 1

Customer: **Chemtura**

Location: **1219 Removable Benches**

Project: Lab Decommissioning

Samp. Description: **Survey Wipes**

Matrix: **Wipes**[illegible]