

Baltes Cardiology

Invasive & Noninvasive Cardiology
DR. WM. EDWARD BALTES DR. THOMAS P. RYAN

821 BROADWAY
FORT WAYNE, IN 46802
(260) 439-0044
(800) 541-6745
FAX (260) 422-7860

1381 N. WAYNE
ANGOLA, IN 46703
(800) 541-6745
FAX (260) 422-7860

Ms. Colleen Carol Casey
Materials Licensing Branch
U.S. NRC Region III
2443 Warrenville Road, Suite 210
Lisle, IL 60532-4352

Re: Control Number 574224 "Additional Information"
License Number 13-32694-01
Docket Number 030-37753
Baltes Cardiology
Termination Request

Ms. Casey:

In response to your letter dated 23 March 2011 and received 15 April 2011, you will find the response to your requests for additional information.

1. Dr. T. Ryan is no longer working in our practice and when he left we ceased all operations. The license clearly continued and Dr. Ryan remained, and remains, the RSO on the inactive license. We should have stated that he is no longer "affiliated" with the practice. We did not replace Dr. Ryan because we did not intend to continue with the licensed activities and intended to terminate the license. Any radiation safety issues, if they would have occurred, would have been addressed by Dr. Ryan who continues to be available for such needs as the RSO.
2. The items that you are requesting were intended to be forwarded under separate cover however apparently you did not receive those items as intended. The items are address/attached herein.
 - a) The final survey status notes that only ^{99m}Tc and ^{201}Tl radiopharmaceuticals for nuclear cardiology were used at the site. There were sealed sources which were documented in the first communication. All patient doses were unidose and the unused/used residual syringes were returned to the radiopharmacy. The facility had not performed procedures for about three (3) months at the time of the request for license termination. The DIS had been disposed according to the licensed procedures, by our technologist, prior to that date. The only remaining radionuclides were the sealed sources. The sealed sources were shipped for disposal to:

Eckert & Ziegler
Isotopes Products
1800 North Keystone Street
Burbank, CA 91504
License #1509-19 (California)

Ms. Colleen Carol Casey
Page Two

The document of receipt of these sources by the above licensee is attached
(Reference #1).

- b) The final waste disposal records are packed in boxes in anticipation of the
termination. These records remain in the possession M. Baltes as indicated in the
original request for termination.
- c) The final surveys are enclosed, (Reference #2).

If you have further questions, please contact:

Charles H. Rose, MA, MSPH, D(ABSNM)
(800) 548-4024

Sincerely,



Marsha Baltes
6627 W. Hamilton Road South
Fort Way, IN 46814

Attachments

TRXN# 6704 8346 2250

RETURN PACKING LIST REFERENCE 1. A.

All information must be provided to ensure proper handling of your return.

FROM:

N C SYSTEMS INC
5660 AIRPORT BLVD STE 101
BOULDER, CO 80301
CONTACT: JIM ROBNESS
P) 800-548-4024 (F) 303-541-0866
E-MAIL: jrobness@nuclearcardiology.com

SEND TO:

Eckert & Ziegler
Isotope Products

1800 North Keystone Street
Burbank, CA 91504

Tel: 661-309-1010
 Fax: 661-257-8303
 E-mail: nucmedsales@ezag.com

RETURN #RA-153805

STOP: This packing list must be affixed to the outside and a copy placed inside of the package. Each returned source to EZIP must be on a one-to-one exchange basis only. For additional returns, please contact EZIP customer service for additional cost considerations.

Nuclide	Activity	Reference Date	Serial No.	CAPSULE Description	Source Wipe Test ≤5nCi
1) <u>Co 57</u>	<u>10.0 mCi</u>	<u>22 APR 2008</u>	<u>12718C</u>	<u>FLOOD</u>	<input type="checkbox"/> Yes <input type="checkbox"/> No
2) _____	_____	_____	_____	_____	<input type="checkbox"/> Yes <input type="checkbox"/> No
3) _____	_____	_____	_____	_____	<input type="checkbox"/> Yes <input type="checkbox"/> No
4) _____	_____	_____	_____	_____	<input type="checkbox"/> Yes <input type="checkbox"/> No
5) _____	_____	_____	_____	_____	<input type="checkbox"/> Yes <input type="checkbox"/> No

If source is damaged, broken, or leaking, describe under "Capsule Description" section and submit a copy of last leak test. Keep a copy of this form for your records. It may be requested by your regulatory agency. I acknowledge that the above information is true to the best of my knowledge.

Contact's Signature

For EZIP Use only.

EZIP has received the radioactive sources listed above, except as noted below:

Receiver's Name

TULUS NBERU

Receipt Date

12 JAN 11

Sources not received:

☒ N/A

REFERENCE 1. B.

TRACK # 8704 8346 7739

RETURN PACKING LIST

BY 7/21/3:40PM

All information must be provided to ensure proper handling of your return.

FROM:

N C SYSTEMS INC
5680 AIRPORT BLVD STE 101
BOULDER, CO 80301
CONTACT: JIM ROGNESS
P)800-548-4024 (F) 303-541-0066
E-MAIL jrogness@nuclearcardiology.com

SEND TO:



Eckert & Ziegler
Isotope Products

1800 North Keystone Street
Burbank, CA 91504

Tel 661-309-1010
Fax 661-257-8303
E-mail: nucmedsales@ezig.com

RETURN # RA 153805

STOP: This packing list must be affixed to the outside and a copy placed inside of the package. Each returned source to EZIP must be on a one-for-one exchange basis only. For additional returns, please contact EZIP customer service for additional cost considerations.

Nuclide	Activity	Reference Date	Serial No.	Capsule Description	Source Wipe Test SSnc
1) <u>Cs-137</u>	<u>201.10 uCi</u>	<u>1 APR 2008</u>	<u>1296-4-23</u>	<u>REFERENCE</u>	<input type="checkbox"/> Yes <input type="checkbox"/> No
2) <u>Co-57</u>	<u>5.42 uCi</u>	<u>1 MAY 2008</u>	<u>1296-10-20</u>	<u>REFERENCE</u>	<input type="checkbox"/> Yes <input type="checkbox"/> No
3) <u>Cs-137</u>	<u>0.005 uCi</u>	<u>01 MAR 08</u>	<u>1263-98-96</u>	<u>GF-0008</u>	<input type="checkbox"/> Yes <input type="checkbox"/> No
4) _____	_____	_____	_____	_____	<input type="checkbox"/> Yes <input type="checkbox"/> No
5) _____	_____	_____	_____	_____	<input type="checkbox"/> Yes <input type="checkbox"/> No

If source is damaged, broken, or leaking, describe under "Capsule Description" section and submit a copy of last leak test. Keep a copy of this form for your records. It may be requested by your regulatory agency. I acknowledge that the above information is true to the best of my knowledge.

Contact's Signature: [Signature]

For EZIP Use only.

EZIP has received the radioactive sources listed above, except as noted below:

FAXED JAN 12 2011

Receiver's Name: J. Rogers LandersReceipt Date: 12 Jan 11

Sources not received: _____

N/A

REFERENCE 2. A.**DECOMMISSIONING
SURVEY**

Site: Fort Wayne Cardiovascular Imaging
625 West Berry Street
Fort Wayne, IN 46802

The facility was surveyed for any remaining radionuclides and determined that the exposure survey, Ambient Exposure, and Contamination Survey (removable contamination) were within normal limits. No residual radioactivity remains in this facility.

Charles H. Rose, MA, MSPH, D(ABSNM)

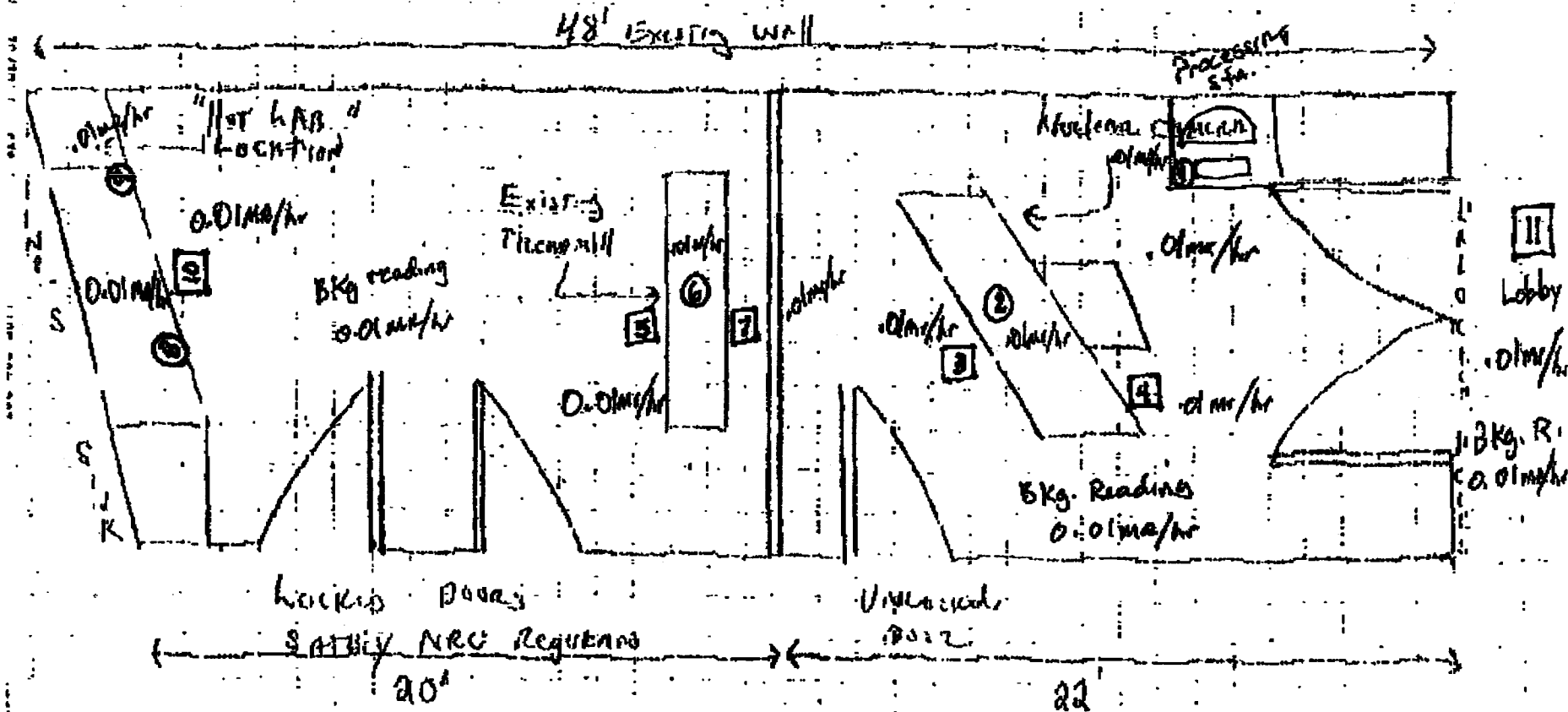

Layout for Fort Wayne Cinematograph Imaging
 625 W. Berry
 Ft. Wayne, IN 46802

Scale
 1 inch = 2 feet

REFERENCE 2.B.



REFERENCE 2. C.

AMBIENT EXPOSURE SURVEY

(Survey for Source Exposure and Contamination)

METER: Manufacturer Ludlum Measurements, Inc. Model# 14C S/N# 250023
 PROBE: Manufacturer Ludlum Measurements, Inc. Model# 44-9 S/N# PR265296
 Last Calibration Date: 7 May 10 Reference Check 157CP 4.3 mR/hr

- I. Survey Area Bkg reading 0.01 mR/hr
- a.) Hot lab
 - b.) Acquisition Room (Camera)

II. Survey

Identification of location and exposure in mR/hr

Surveyed By	Date	1	2	3	4	5	6	7	8	Operator Action*
1 JS	1/11/11	P.D	0.01 mR/hr							1
2 JS	1/11/11	CP	0.01 mR/hr							1
3 JS	1/11/11	CCFSP	0.01 mR/hr							1
4 JS	1/11/11	CCFMP	0.01 mR/hr							1
5 JS	1/11/11	TM E (B)	0.01 mR/hr							1
6 JS	1/11/11	TM B'S	0.01 mR/hr							1
7 JS	1/11/11	TM FL (B)	0.01 mR/hr							1
8 JS	1/11/11	HA C (B)	0.01 mR/hr							1
9 JS	1/11/11	H/L C (B)	0.01 mR/hr							1
10 JS	1/11/11	H/L F	0.01 mR/hr							1
11 JS	1/11/11	Lobby F	0.01 mR/hr							1
12 JS	1/11/11	Recp C	0.01 mR/hr							1

* See "Exposure Action Levels" Below

III. Exposure Action Levels (mR/hr of ambient exposure)

1. All Areas Any unexpectedly high or low levels
2. All Areas Any exposure where radionuclides should not be present
3. Unrestricted Areas .05 mR/hr or higher
4. Restricted Areas 2.0 mR/hr or higher

Nuclear Cardiology Systems, Inc.
National Laboratory
5660 Airport Blvd., Suite 101
Boulder, CO 80301

REFERENCE 2. D.

Wipe Results Report

Thursday, January 13, 2011 12:16 PM

Area: Baltes-Ft Wayne Decommission

Unrestricted Area, R50 Trigger at 100% of Federal Guidelines, Well

Location: Wipes 1,2 and 3

>LLD	>Trigger	Isotope	Trigger	LLD	Background	Count Time	Activity
No	No	• Co-57	0.0009 uCi	3.627e-06	uCi3.974e-05 uCi	60 sec.	-5.597e-06 uCi
No	No	• Ba-133	9e-05 uCi	1.494e-05	uCi0.0001904 uCi	60 sec.	0 uCi
No	No	• Cs-137	9e-05 uCi	7.78e-05	uCi 0.003816 uCi	60 sec.	-0.003743 uCi
No	No	• Tc-99m	0.0009 uCi	3.328e-06	uCi2.772e-05 uCi	60 sec.	3.223e-06 uCi
No	No	Wide Window	0.0009 uCi	9.286e-05	uCi0.009737 uCi	60 sec.	-0.009003 uCi

Location: Wipes 4,5 and 6

>LLD	>Trigger	Isotope	Trigger	LLD	Background	Count Time	Activity
No	No	• Co-57	0.0009 uCi	3.627e-06	uCi3.974e-05 uCi	60 sec.	-1.679e-06 uCi
No	No	• Ba-133	9e-05 uCi	1.494e-05	uCi0.0001904 uCi	60 sec.	-2.026e-05 uCi
No	No	• Cs-137	9e-05 uCi	7.78e-05	uCi 0.003816 uCi	60 sec.	-0.003703 uCi
Yes	No	• Tc-99m	0.0009 uCi	3.328e-06	uCi2.772e-05 uCi	60 sec.	1.354e-05 uCi
No	No	Wide Window	0.0009 uCi	9.286e-05	uCi0.009737 uCi	60 sec.	-0.008892 uCi

Location: Wipes 7,8 and 9

>LLD	>Trigger	Isotope	Trigger	LLD	Background	Count Time	Activity
No	No	• Co-57	0.0009 uCi	3.627e-06	uCi3.974e-05 uCi	60 sec.	-1.343e-05 uCi
No	No	• Ba-133	9e-05 uCi	1.494e-05	uCi0.0001904 uCi	60 sec.	4.051e-06 uCi
No	No	• Cs-137	9e-05 uCi	7.78e-05	uCi 0.003816 uCi	60 sec.	-0.00374 uCi
Yes	No	• Tc-99m	0.0009 uCi	3.328e-06	uCi2.772e-05 uCi	60 sec.	5.156e-06 uCi
No	No	Wide Window	0.0009 uCi	9.286e-05	uCi0.009737 uCi	60 sec.	-0.008974 uCi

Location: Wipes 10, 11 and 12

>LLD	>Trigger	Isotope	Trigger	LLD	Background	Count Time	Activity
No	No	• Co-57	0.0009 uCi	3.627e-06	uCi3.974e-05 uCi	60 sec.	2.239e-06 uCi
Yes	No	• Ba-133	9e-05 uCi	1.494e-05	uCi0.0001904 uCi	60 sec.	2.026e-05 uCi
No	No	• Cs-137	9e-05 uCi	7.78e-05	uCi 0.003816 uCi	60 sec.	-0.003737 uCi
No	No	• Tc-99m	0.0009 uCi	3.328e-06	uCi2.772e-05 uCi	60 sec.	1.289e-06 uCi
No	No	Wide Window	0.0009 uCi	9.286e-05	uCi0.009737 uCi	60 sec.	-0.008883 uCi

Technologist: Julian Saucedo

Comments:

Baltes Cardiology Decommission

Fort Wayne IN

Wipes taken 01/11/11

Signature:

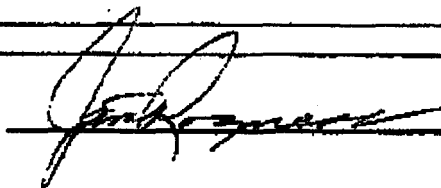

Date:

1/13/11

REFERENCE 2. E.**Nuclear Cardiology Systems, Inc.**

National Laboratory

5660 Airport Blvd., Suite 101

Boulder, CO 80301

Wipe Results Report

Thursday, January 13, 2011 12:16 PM

Area: Baltes-Ft Wayne Decommission

Unrestricted Area, RSO Trigger at 100% of Federal Guidelines, Well

Location: Wipes 1,2 and 3

>LLD	>Trigger	Isotope	Trigger	LLD	Background	Count Time	Activity
No	No	• Co-57	0.0009 uCi	3.627e-06	uCi 3.974e-05 uCi	60 sec.	-5.597e-06 uCi
No	No	• Ba-133	9e-05 uCi	1.494e-05	uCi 0.0001904 uCi	60 sec.	0 uCi
No	No	• Cs-137	9e-05 uCi	7.78e-05	uCi 0.003816 uCi	60 sec.	-0.003743 uCi
No	No	• Tc-99m	0.0009 uCi	3.328e-06	uCi 2.772e-05 uCi	60 sec.	3.223e-06 uCi
No	No	Wide Window	0.0009 uCi	9.286e-05	uCi 0.009737 uCi	60 sec.	-0.009003 uCi

Location: Wipes 4,5 and 6

>LLD	>Trigger	Isotope	Trigger	LLD	Background	Count Time	Activity
No	No	• Co-57	0.0009 uCi	3.627e-06	uCi 3.974e-05 uCi	60 sec.	-1.879e-06 uCi
No	No	• Ba-133	9e-05 uCi	1.494e-05	uCi 0.0001904 uCi	60 sec.	-2.026e-05 uCi
No	No	• Cs-137	9e-05 uCi	7.78e-05	uCi 0.003816 uCi	60 sec.	-0.003703 uCi
Yes	No	• Tc-99m	0.0009 uCi	3.328e-06	uCi 2.772e-05 uCi	60 sec.	1.354e-05 uCi
No	No	Wide Window	0.0009 uCi	9.286e-05	uCi 0.009737 uCi	60 sec.	-0.008892 uCi

Location: Wipes 7,8 and 9

>LLD	>Trigger	Isotope	Trigger	LLD	Background	Count Time	Activity
No	No	• Co-57	0.0009 uCi	3.627e-06	uCi 3.974e-05 uCi	60 sec.	-1.343e-05 uCi
No	No	• Ba-133	9e-05 uCi	1.494e-05	uCi 0.0001904 uCi	60 sec.	4.051e-05 uCi
No	No	• Cs-137	9e-05 uCi	7.78e-05	uCi 0.003816 uCi	60 sec.	-0.00374 uCi
Yes	No	• Tc-99m	0.0009 uCi	3.328e-06	uCi 2.772e-05 uCi	60 sec.	5.156e-06 uCi
No	No	Wide Window	0.0009 uCi	9.286e-05	uCi 0.009737 uCi	60 sec.	-0.008974 uCi

Location: Wipes 10, 11 and 12

>LLD	>Trigger	Isotope	Trigger	LLD	Background	Count Time	Activity
No	No	• Co-57	0.0009 uCi	3.627e-06	uCi 3.974e-05 uCi	60 sec.	2.239e-06 uCi
Yes	No	• Ba-133	9e-05 uCi	1.494e-05	uCi 0.0001904 uCi	60 sec.	2.026e-05 uCi
No	No	• Cs-137	9e-05 uCi	7.78e-05	uCi 0.003816 uCi	60 sec.	-0.003737 uCi
No	No	• Tc-99m	0.0009 uCi	3.328e-06	uCi 2.772e-05 uCi	60 sec.	1.289e-06 uCi
No	No	Wide Window	0.0009 uCi	9.286e-05	uCi 0.009737 uCi	60 sec.	-0.008883 uCi

Technologist: Julian Saucedo

Comments:

Baltes Cardiology Decommission

Fort Wayne IN

Wipes taken 01/11/11

Signature:

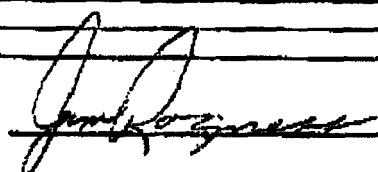

Date:

1/13/11

TO: COLLEEN CAROL CASEY
MATERIALS LICENSING BRANCH
U.S. NRC REGION III

FAX: 630-515-1078

FROM: MARSHA BALTES
BALTES CARDIOLOGY
PHONE (FAX): 260-672-8696

5-4-2011