



1159 East Michigan Avenue
Ypsilanti, MI 48198

3100 Cross Creek Pkwy., Ste. 120
Auburn Hills, MI 48326

8560 Silvery Lane
Dearborn Heights, MI 48127

4600 Investment Drive, Ste. 160
Troy, MI 48098

April 11, 2011

United States Nuclear Regulatory Commission
Region III, Materials Licensing
2443 Warrenville Road, Suite 210
Lisle, IL 60532-4352

RE: Amendment to NRC License No. 21-26532-01
Universal Imaging, Inc.

Dear Sir/Madam:

The purpose of this letter is to amend our current NRC Materials License to reflect the following changes. This is not a license termination. We plan to continue offering nuclear medicine services our Auburn Hills address of use.

Item #1

Please find the close-out survey results for the following address of use:

- 8560 Silvery Lane, Suite 100, Dearborn Heights, Michigan

The close-out survey for 8560 Silvery Lane, Suite 100, Dearborn Heights, Michigan was performed on November 19, 2010.

The last date of use of radioactive material at this site was March 20, 2008 for Tc-99m. No other radioactive materials used at this location.

All sealed sources were transported to our Auburn Hills address of use per DOT requirements. A current copy of the leak test results for the sealed sources is enclosed for your review. These sources include a Cs-137 rod for well counter testing. And a Cs-137 and a Ba-133 vials used for dose calibrator constancy and accuracy testing.

We did not dispose of radioactive materials by release to sewers or incineration. In addition, there were no spills of any long-lived radioactive material or on-site burials of radioactive materials.

RECEIVED APR 14 2011

Item #2

Please find the close-out survey results for the following mobile trailer:

- Mobile trailer SPECT 2

The close-out survey for Mobile trailer SPECT 2 was performed on November 19, 2010.

The last date of use of radioactive material at this site was June 2008 for Tc-99m. No other radioactive materials used at this location.

All sealed sources were transported to our Auburn Hills address of use per DOT requirements. A current copy of the leak test results for the sealed sources is enclosed for your review. These sources include a Cs-137 rod for well counter testing. And a Cs-137 and a Ba-133 vials used for dose calibrator constancy and accuracy testing.

We did not dispose of radioactive materials by release to sewers or incineration. In addition, there were no spills of any long-lived radioactive material or on-site burials of radioactive materials.

Item #3

Please find the close-out survey results for the following mobile trailer:

- Mobile trailer SPECT 3

The close-out survey for Mobile trailer SPECT 3 was performed on October 27, 2010.

The last date of use of radioactive material at this site was October 22, 2010 for Tc-99m and April 19, 2010 for TI-201. No other radioactive materials used at this location.

All sealed sources were transported to our Auburn Hills address of use per DOT requirements. A current copy of the leak test results for the sealed sources is enclosed for your review. These sources include a Cs-137 rod for well counter testing. And a Cs-137 and a Ba-133 vials used for dose calibrator constancy and accuracy testing.

We did not dispose of radioactive materials by release to sewers or incineration. In addition, there were no spills of any long-lived radioactive material or on-site burials of radioactive materials.

Thank you for your cooperation. If you have any questions or require additional information, please contact our physics consultant, Kevin B. Miller at 734-662-3197.

Respectfully Yours,

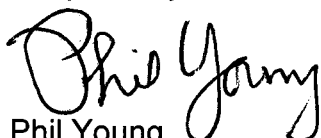
Phil Young
President

**Close-out Survey for
8560 Silvery Lane, Suite 100, Dearborn Heights, Michigan**

Date performed: November 19, 2010

Performed by: Cindy Kennedy, CNMT

Comments: The last date of use of radioactive material at this site was November 19, 2010.

Instruments:

Wipe tests analyzed with a Capintec CRC-15W S/N# 170203

Instrument: Well Counter

Radionuclide: Full Spectrum MDA for Full Spectrum: 85 dpm

Date completed: 02/18/10 Generic Conversion Factor: 2.0 cpm/dpm

Area survey performed with the following survey meter:

Manufacturer: Ludlum

Type: GM

Model Number: 14C

Serial Number: 186647

Probe Model: End Window

Annual Calibration Due: 02/24/10

Battery check acceptable: YES

Operational check acceptable: YES

Current reading: 3.0 mR/hr

History of Radionuclides Used

Unsealed: The last date of use of radioactive material at this site was March 20, 2008 for Tc-99m. No other radioactive materials used at this location.

Sealed: Sealed sources included a Cs-137 rod for well counter testing. And a Cs-137 and a Ba-133 vials used for dose calibrator constancy and accuracy testing. All sealed sources were transported to our Auburn Hills address of use per DOT requirements.

Last date of byproduct radiopharmaceutical use: March 20, 2008.

Visual Check: The area was checked to ensure that all radioactive materials had been removed. No evidence of radioactive material was noted.

Sealed Source Leak Testing: There is no history of leaks from Sealed Sources at this facility.

Radiation Level Survey: No area within the department demonstrated radiation levels in excess of the background reading of 0.02 mR/hr.

**Close-out Survey for
8560 Silvery Lane, Suite 100, Dearborn Heights, Michigan**

Removable Contamination: No area within the department demonstrated removable contamination in excess of 12 dpm's. There is no history of any spills of long-lived radioisotopes.

Conclusion: No radioactive materials remain in this department. No removable contamination is present.

Universal Imaging, Inc. Dearborn Heights

License # 21-26532-01

Date: 11/19/10	Performed Cindy
Well Counter: CRC-15W	By: Kennedy
Survey Meter: Ludlum EWGM	MDA: 85
Calibrated 02/24/10	Check Value: 3.0 mr/hr

			net dpm	mR/h
1	Dose Calibrator		0	0.02
2	Dose Prep Area		0	0.02
3	Waste Storage		0	0.02
4	Camera		22.00	0.02
5	Computer		2.00	0.02
6	Treadmill Area		0	0.02
7	Injection Area		67.00	0.02
8	Department Door		12.00	0.02
9	Stress Door		0	0.02
10	Treadmill Rm Floor		0	0.02
11	Treadmill Rm Floor		0	0.02
12	Treadmill Rm Floor		0	0.02
13	Treadmill Rm Floor		0	0.02
14	Treadmill Rm Floor		0	0.02
15	Treadmill Rm Floor		0	0.02
16	Camera Rm Floor		2.00	0.02
17	Camera Rm Floor		0	0.02
18	Camera Rm Floor		0	0.02
19	Imaging Bed		0	0.02
20	Gamma Camera		6.00	0.02
21	Camera Rm Floor		0	0.02
22	Camera Rm Floor		0	0.02
23	Camera Rm Floor		0	0.02
24	Hot Lab Cabinet		0	0.02
25	Camera Rm Floor		0	0.02
	Background		52.00	0.02

ACTION LEVELS: 2000 dpm

Efficiency (dpm/cpm)
< 0.2 mR/hr

2

Removal Contamination

Maximum removable contamination: 12.0 net dpm/100 cm²

Conclusion

As of November 19, 2010 all radioactive materials were removed from the site and no removable contamination was present.

UNIVERSAL IMAGING, INC.

8560 Silvery Lane, Suite 100, Dearborn Heights, MI.

NRC License No. 21-26532-01

Nuclear Medicine Department

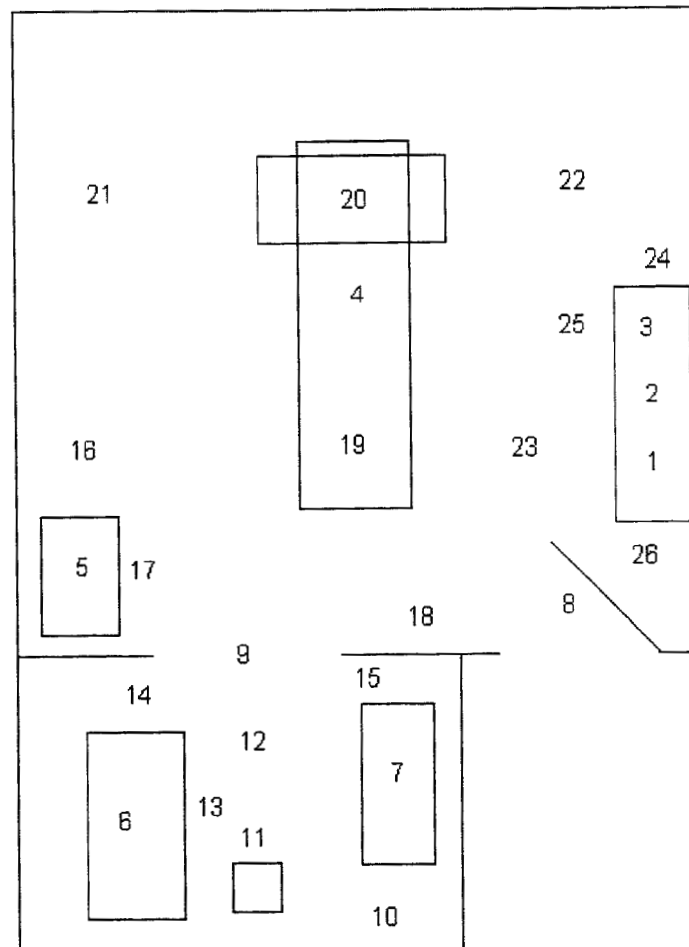

**Close-out Survey for
Mobile Trailer SPECT 2**

Date performed: November 19, 2010

Performed by: Cindy Kennedy, CNMT

Comments: The last date of use of radioactive material at this site was June of 2008.

Instruments:

Wipe tests analyzed with a Capintec CRC-15W S/N# 170203

Instrument: Well Counter

Radionuclide: Full Spectrum MDA for Full Spectrum: 85 dpm

Date completed: 02/18/10 Generic Conversion Factor: 2.0 cpm/dpm

Area survey performed with the following survey meter:

Manufacturer: Ludlum

Type: GM

Model Number: 14C

Serial Number: 186647

Probe Model: End Window

Annual Calibration Due: 02/24/10

Battery check acceptable: YES

Operational check acceptable: YES

Current reading: 3.0 mR/hr

History of Radionuclide's Used

Unsealed: The last date of use of radioactive material at this site was June of 2008 for Tc-99m. No other radioactive materials used at this location.

Sealed: Sealed sources included a Cs-137 rod for well counter testing. And a Cs-137 and a Ba-133 vials used for dose calibrator constancy and accuracy testing. All sealed sources were transported to our Auburn Hills address of use per DOT requirements.

Last date of byproduct radiopharmaceutical use: June of 2008.

Visual Check: The area was checked to ensure that all radioactive materials had been removed. No evidence of radioactive material was noted.

Sealed Source Leak Testing: There is no history of leaks from Sealed Sources at this facility.

Radiation Level Survey: No area within the department demonstrated radiation levels in excess of the background reading of 0.02 mR/hr.

Removable Contamination: No area within the Stress Lab demonstrated removable contamination in excess of 102 dpm's. There is no history of any spills of long-lived radioisotopes.

Conclusion: No radioactive materials remain in this mobile trailer. No removable contamination is present.

Universal Imaging, Inc.SPECT 2**License # 21-26532-01****11/19/2010****Performed By: Cindy Kennedy****Well Counter:CRC-15W****MDA: 85 dpm****Survey Meter: Ludlum EWGM****Check Value: 3.0 mR/hr**

Calibrated 02/24/10

			net dpm	mR/h
1	Dose Calibrator		62.00	0.02
2	Dose Prep Area		0	0.02
3	Waste Storage		0	0.02
4	Treadmill		48.00	0.02
5	Patient Bed		0	0.02
6	Desk		0	0.02
7	Computer		0	0.02
8	Camera		0	0.02
9	Door		2.00	0.02
10	Camera Rm Floor		0	0.02
11	Camera Rm Floor		0	0.02
12	Camera Rm Floor		0	0.02
13	Camera Rm Floor		0	0.02
14	Camera Rm Floor		8.00	0.02
15	Camera Rm Floor		0	0.02
16	Camera Rm Floor		0	0.02
17	Camera Rm Floor		0	0.02
18	Injection Rm Floor		0	0.02
19	Injection Rm Floor		0	0.02
20	Injection Rm Floor		102.00	0.02
21	Injection Rm Floor		0	0.02
22	Injection Chair		0	0.02
23	Treadmill Rm Floor		0	0.02
24	Treadmill Rm Floor		0	0.02
25	Treadmill Rm Floor		0	0.02
26	Treadmill Rm Floor		16.00	0.02
27	Treadmill Rm Floor		0	0.02
28	Treadmill Rm Floor		0	0.02
29	Hot Lab Counter		0	0.02
30	Hot Lab Counter		0	0.02
	Background		0	0.02

ACTION LEVELS: 2000 dpm**Efficiency (dpm/cpm)
< 0.2 mR/hr****2**

Removal Contamination

Maximum removable contamination: 102.0 net dpm/100 cm²

Conclusion: No radioactive materials remain in this mobile trailer. No removable contamination is present.

UNIVERSAL IMAGING, INC.
Mobile Trailer SPECT 2
NRC License No. 21-26532-01

Nuclear Medicine Department

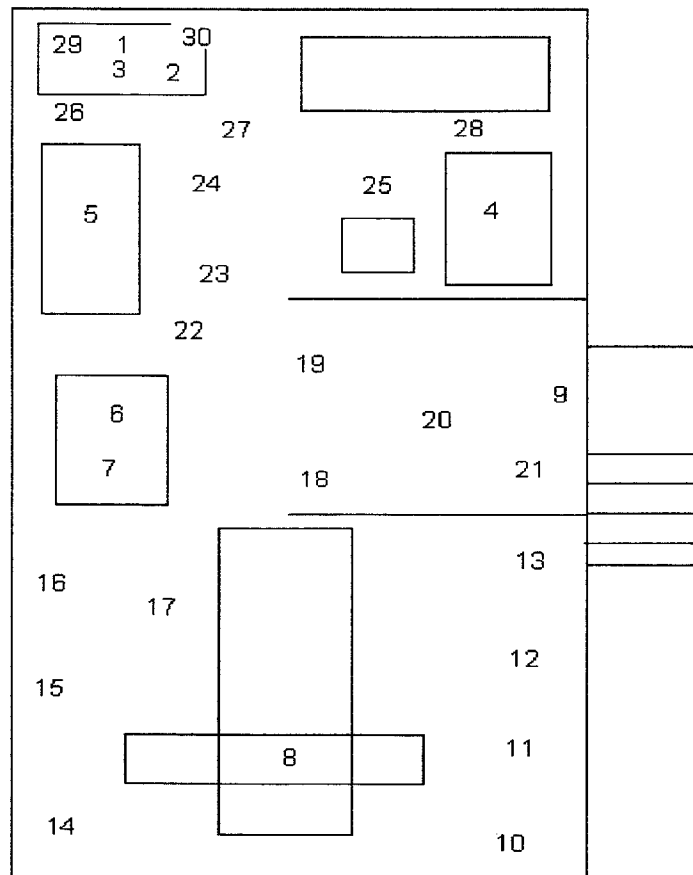

**Close-out Survey for
Mobile Trailer SPECT 3**

Date performed: October 27, 2010

Performed by: Cindy Kennedy, CNMT

Comments: The last date of use of radioactive material at this site was October 27, 2010.

Instruments:

Wipe tests analyzed with a Capintec CRC-15W S/N# 170203

Instrument: Well Counter

Radionuclide: Full Spectrum MDA for Full Spectrum: 85 dpm

Date completed: 02/18/10 Generic Conversion factor: 2.0 cpm/dpm

Area survey performed with the following survey meter:

Manufacturer: Ludlum

Type: GM

Model Number: 14C

Serial Number: 184366

Probe Model: End Window

Annual Calibration Due: 01/29/10

Battery check acceptable: YES

Operational check acceptable: YES

Current reading: 0.5.0 mR/hr

History of Radionuclide's Used

Unsealed: The last date of use of radioactive material at this site was October 22, 2010 for Tc-99m and April 19, 2010 for TI-201. No other radioactive materials used at this location.

Sealed: Sealed sources included a Cs-137 rod for well counter testing. And a Cs-137 and a Ba-133 vials used for dose calibrator constancy and accuracy testing. All sealed sources were transported to our Auburn Hills address of use per DOT requirements.

Last date of byproduct radiopharmaceutical use October 22, 2010 for Tc-99m and April 19, 2010 for TI-201.

Visual Check: The area was checked to ensure that all radioactive materials had been removed. No evidence of radioactive material was noted.

Sealed Source Leak Testing: There is no history of leaks from Sealed Sources at this facility.

Radiation Level Survey: No area within the department demonstrated radiation levels in excess of the background reading of 0.02 mR/hr.

**Close-out Survey for
Mobile Trailer SPECT 3**

Removable Contamination: No area within the Stress Lab demonstrated removable contamination in excess of 101 dpm's. There is no history of any spills of long-lived radioisotopes.

Conclusion: No radioactive materials remain in this mobile trailer. No removable contamination is present.

Universal Imaging, Inc.SPECT 3

License # 21-26532-01

11/19/2010
Well Counter:CRC-15W
Survey Meter: Ludlum EWGM
Calibrated 01/29/10

Performed By: Cindy Kennedy
MDA: 85 dpm
Check Value: 0.5 mR/hr

			net dpm	mR/h
1	Dose Calibrator		13.00	0.02
2	Dose Prep Area		0	0.02
3	Waste Storage		0	0.02
4	Treadmill		0	0.02
5	Patient Bed		101.00	0.02
6	Desk		0	0.02
7	Computer		0	0.02
8	Camera		0	0.02
9	Door		53.00	0.02
10	Camera Rm Floor		0	0.02
11	Camera Rm Floor		0	0.02
12	Camera Rm Floor		0	0.02
13	Camera Rm Floor		0	0.02
14	Camera Rm Floor		13.00	0.02
15	Camera Rm Floor		0	0.02
16	Camera Rm Floor		0	0.02
17	Camera Rm Floor		61.00	0.02
18	Injection Rm Floor		0	0.02
19	Injection Rm Floor		61.00	0.02
20	Injection Rm Floor		0	0.02
21	Injection Rm Floor		5.00	0.02
22	Injection Chair		13.00	0.02
23	Treadmill Rm Floor		0	0.02
24	Treadmill Rm Floor		0	0.02
25	Treadmill Rm Floor		77.00	0.02
26	Treadmill Rm Floor		5.00	0.02
27	Treadmill Rm Floor		61.00	0.02
28	Treadmill Rm Floor		0	0.02
29	Hot Lab Counter		0	0.02
30	Hot Lab Counter		0	0.02
	Background		0	0.02

ACTION LEVELS: 2000 dpm

**Efficiency (dpm/cpm)
< 0.2 mR/hr**

2

Removal Contamination

Maximum removable contamination: 101.0 net dpm/100 cm²

Conclusion

As of October 27, 2010 all radioactive materials were removed from the site and no removable contamination was present.

UNIVERSAL IMAGING, INC.
Mobile Trailer SPECT 3
NRC License No. 21-26532-01

Nuclear Medicine Department

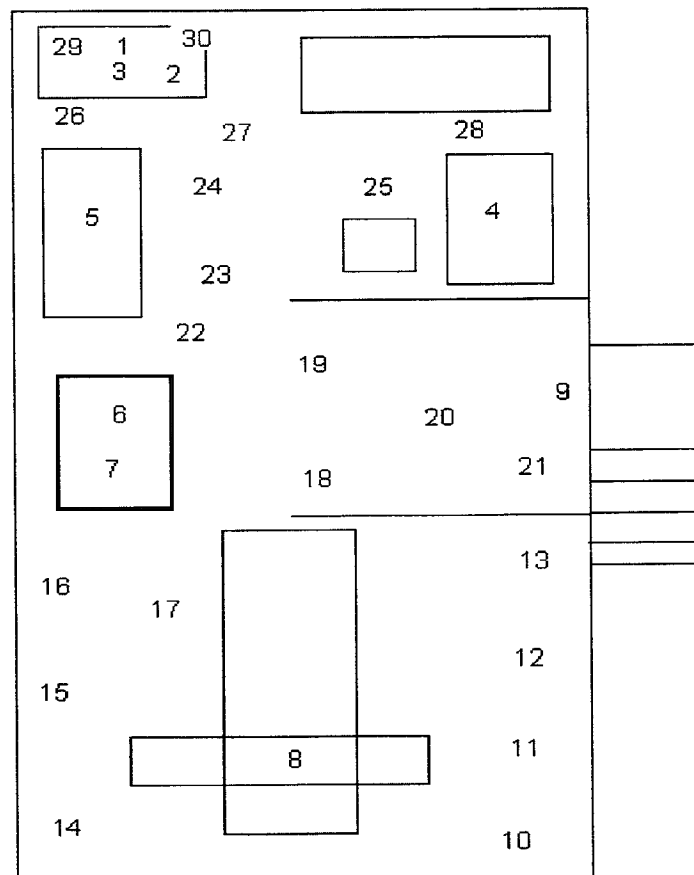

FedEx
TRK# 8565 4744 2633
0215

THU - 14 APR A1
** 2DAY **

SE BDFA

60532
IL-US ORD



#2268761 84/12 50DGJ/26A8/7EFS

41
100

FedEx US Airbill
Express

FedEx Tracking Number 8565 4744 2633

1 From This portion can be removed for Recipient's records.

Date 4-12-11 FedEx Tracking Number 856547442633

Sender's Name P Young

Phone 734 445-0111

Company UNIVERSAL IMAGING INC

XXXX

Address 1155 E MICHIGAN AVE

Dept./Floor/Suite/Room

City YPSILANTI

State MI

ZIP 48198-5807

2 Your Internal Billing Reference

3 To

Recipient's Name

Phone

Company US Nuclear Regulatory Comm.

Recipient's Address Region III etc. Nat. Lic.

Address 2443 Waverlyville Rd Ste 210

City Lisle

State IL

ZIP 60532

0333954418

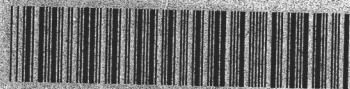

8565 4744 2633

4a Express Package

☐ FedEx Priority Overnight
Next business morning. Friday shipments will be delivered on Monday unless SATURDAY Delivery is selected.
☐ FedEx Standard Overnight
Next business afternoon. Saturday Delivery NOT available.
☐ FedEx 2Day
Second business day. Thursday shipments will be delivered on Monday unless SATURDAY Delivery is selected.
☐ FedEx Express Saver
Third business day. Saturday Delivery NOT available.
FedEx Envelope rate not available. Minimum charge: One-pound rate. * To meet locations.

4b Express Freight Service

☐ FedEx 1Day Freight
Next business day. Friday shipments will be delivered on Monday unless SATURDAY Delivery is selected.
☐ FedEx 2Day Freight
Second business day. Thursday shipments will be delivered on Monday unless SATURDAY Delivery is selected.
☐ Packages over 150 lbs.
FedEx 3Day Freight
Third business day. Saturday Delivery NOT available. ** To meet locations.

5 Packaging

☒ FedEx Envelope*
☐ FedEx Pak*
Includes FedEx Small Pak, FedEx Large Pak, and FedEx Sturdy Pak.
☐ FedEx Box
☐ FedEx Tube
☐ Other
* Declared value limit \$500.

6 Special Handling

☐ SATURDAY Delivery
Not available for FedEx Standard Overnight, FedEx First Overnight, FedEx Express Saver, or FedEx 2Day Freight.
☐ HOLD Weekday at FedEx Location
Not available for FedEx First Overnight.
☐ HOLD Saturday at FedEx Location
Available ONLY for FedEx Priority Overnight and FedEx 2Day to select locations.
Does this shipment contain dangerous goods?
One box must be checked.
☒ No
☐ Yes
As per attached Shipper's Declaration. ☐ Yes
Shipper's Declaration not required.
☐ Dry Ice
Dry Ice, 5 UN 1845
Cargo Aircraft Only
Dangerous goods (including dry ice) cannot be shipped in FedEx packaging.

7 Payment

Bill to:
☒ Sender
Account No. in Section 7 will be billed.
☐ Recipient
☐ Third Party
☐ Credit Card
☐ Cash/Check
Enter FedEx Acct. No. or Credit Card No. below.
Obtain Recipient Acct. No.
Total Packages 1
Total Weight 1
Total Charges
Credit Card Auth.

8 NEW Residential Delivery Signature Options

☐ No Signature Required
Package may be left with out obtaining a signature for delivery.
☐ Direct Signature
Anyone at recipient's address may sign for delivery. Fee applies.
☐ Indirect Signature
If no one is available at recipient's address, anyone at a neighboring address may sign for delivery. Fee applies.
519

Rev. Date 8/05 Part #158279-D1994-2005 FedEx-PRINTED IN U.S.A.-G/F

fedex.com 1800.GoFedEx 1800.4633339

RECIPIENT: PEEL HERE

