

FOUNDATION AND FLOOR PLAN

ANALYZE FOR SAFETY, ECOLOGY, AND MINIMUM ESSENTIAL DESIGN

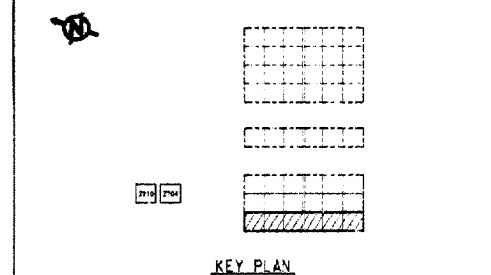

NOTES

- 1. FOR GENERAL NOTES, SEE DRAWING W780201.
- 2. FOUNDATION DESIGN IS BASED ON 6.0 KSF ALLOWABLE SOIL BEARING PRESSURE.
- 3. THE WALLS ARE DESIGNED FOR GRAVITY LOADS PLUS HYDROSTATIC PRESSURE DUE TO 5 FT HIGH LIQUID SALTSTONE.
- 4. CONCRETE SHALL BE FURNISHED BY CONTRACTOR AND SHALL BE AS FOLLOWS:
WORK SLAB: CLASS "A" (F/C = 2000 PSI)
FOUNDATION AND WALLS: CLASS "2" OR "22" (F/C = 4000 PSI)
- 5. CLEAR COVER FOR REINFORCING SHALL BE AS FOLLOWS:
FOUNDATION: 3"
WALLS: 3"
- 6. CONCRETE SHALL BE WATER CURED FOR A MINIMUM OF 7 DAYS AFTER WHICH IT SHALL BE CURED BY LIQUID MEMBRANE METHOD.
- 7. WATERSTOPS SHALL BE PROVIDED AT ALL CONSTRUCTION JOINTS.
- 8. CONCRETE SHALL HAVE ROUGH FINISH.
- 9. THE PIPES SHALL BE PLUGGED WITH CONCRETE BEFORE SALTSTONE IS POURED (BY CONTRACTOR).
- 10. CLASS "2" AND "22" CONCRETE SHALL NOT TO BE PUMPED.
- 11. WALL CONSTRUCTION SHALL NOT BEGIN UNTIL FOUNDATION CONCRETE HAS REACHED AT LEAST 75% OF THE SPECIFIED STRENGTH.
- 12. REPAIR OF CONCRETE SHALL START A MINIMUM OF 30 DAYS AFTER CONCRETE IS PLACED.

W 780625 LAST 7 REV.

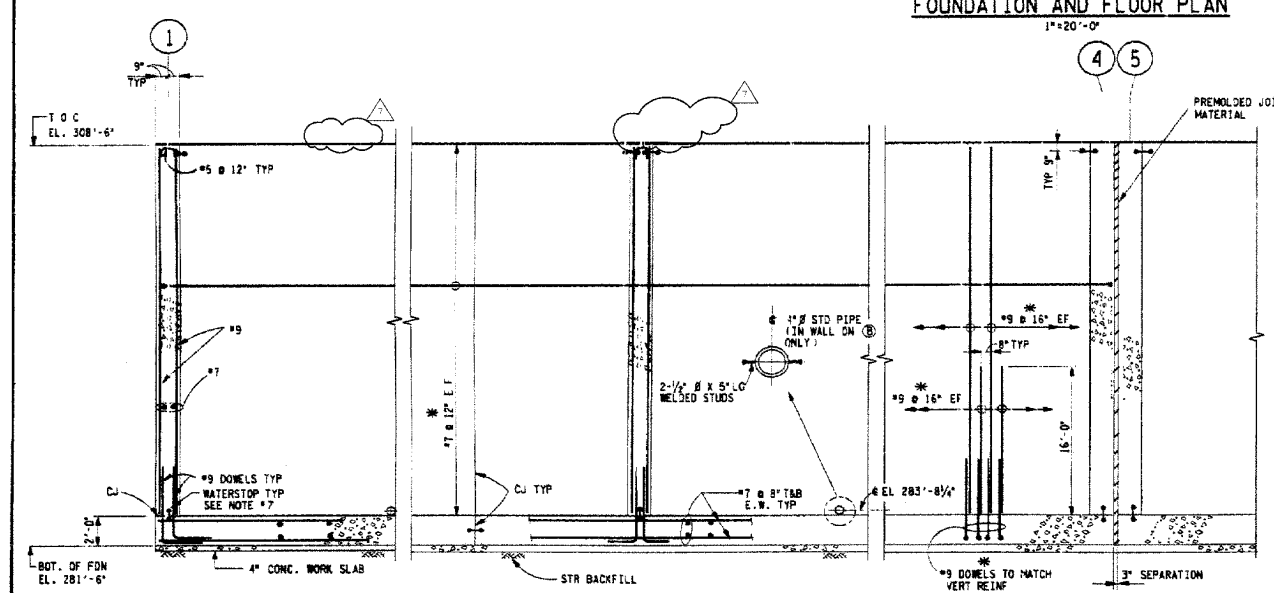

* NOTE: REINFORCING SHOWN IS TYPICAL FOR ALL WALLS.

SECTION A

WALL COATING NOTES

POLYMER PLASTICS MULTITHANE 985 POLYURETHANE COATING TO BE APPLIED OVER PROPERLY PREPARED SURFACES TO THE ENTIRE SURFACE OF ALL EXPOSED VERTICAL WALLS INCLUDING DOUBLE WALLS AT UNDERMINES. COATING SHALL BE APPLIED TO A MINIMUM OF 4" ABOVE TOP OF FOUNDATION AND TO A MINIMUM OF 4" BELOW BOTTOM OF FLOOR SLAB AND 1" AT BOTH SIDES OF ALL EXPOSED WALLS. MINIMUM THICKNESS SHALL BE 1/4".

THE FOLLOWING ITEMS SHALL BE SUBMITTED TO THE CONTRACTOR FOR APPROVAL AND APPLICATION INSTRUCTIONS FOR USE:

- 1. MATERIALS MANUFACTURER'S TECHNICAL DATA SHEET AND APPLICATION INSTRUCTIONS FOR USE.
- 2. TEST REPORTS FOR TENSILE STRENGTH, ELONGATION, AND ADHESION TO CONCRETE.
- 3. TEST REPORTS FOR WATER ABSORPTION AND PERMEABILITY.
- 4. TEST REPORTS FOR WEAR RESISTANCE.
- 5. TEST REPORTS FOR CHEMICAL RESISTANCE TO SALTSTONE.

SURFACE PREPARATION:

ALL SURFACES TO RECEIVE COATING SHALL BE PREPARED BY SAND OR WATER BLASTING TO REMOVE ALL LAFTS, DUST, AND OIL. SURFACES SHALL BE CLEAN, DRY, AND FREE OF ALL CONTAMINANTS. THE SURFACE SHALL BE ALLOWED TO DRY THOROUGHLY BEFORE APPLYING OR BLOWING OFF WITH COMPRESSED AIR.

APPLICATION:

AMBIENT CONDITIONS IN THE WORK AREA SHALL BE MAINTAINED WITHIN THE LIMITS SPECIFIED BY THE MANUFACTURER DURING APPLICATION AND CURING OF THE COATING. COATING MATERIALS SHALL BE BETWEEN 40°F AND 85°F AND MAINTAINED WITHIN THESE LIMITS UNTIL APPLIED. UNLESS OTHERWISE SPECIFIED BY THE MANUFACTURER, ALL MATERIALS SHALL BE MEASURED, COMBINED, AND MIXED IN EXACT QUANTITIES SPECIFIED BY THE MANUFACTURER. COATING SHALL BE APPLIED WITHIN 1 HOUR OF MIXING. COATING SHALL BE APPLIED IN A SINGLE COAT. COATING SHALL BE APPLIED TO A MINIMUM OF 4" ABOVE TOP OF FOUNDATION AND TO A MINIMUM OF 4" BELOW BOTTOM OF FLOOR SLAB AND 1" AT BOTH SIDES OF ALL EXPOSED WALLS. MINIMUM THICKNESS SHALL BE 1/4".

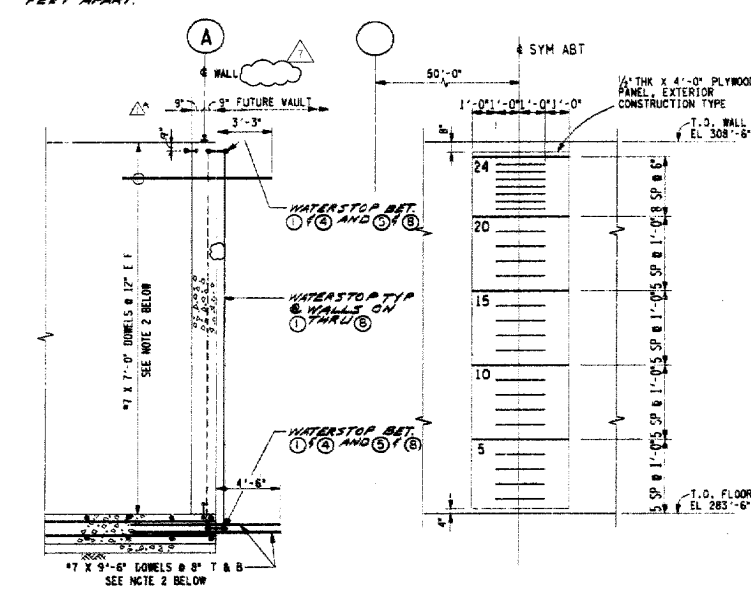

SECTION B

TYPICAL INTERIOR WALL ELEVATION SHOWING ELEVATION MARKS AT 24 PLACES

- NOTES:
1. FOR INFO NOT SHOWN, SEE SECT. A.
 2. DOWELS SHALL BE COATED WITH FUSION BONDED EPOXY CONFORMING TO ASTM A775-84. COATING SHALL BE SCOTCHKOTE 213 AS MANUFACTURED BY 3M OR APPROVED EQUAL.
- NOTES:
- ELEVATION MARKS SHALL BE PAINTED OVER PLYWOOD PANELS AS FOLLOWS: ALL PLYWOOD SURFACES AND EDGES SHALL BE PAINTED IN WHITE COLOR AND NUMBERS AND STRIPS IN BLACK COLOR. STRIPS SHALL BE 2" HIGH AND NUMBERS 8" HIGH X 1" THICK. PAINT SHALL BE DUPONT 310, EXTERIOR FLAT ACRYLIC, OR APPROVED EQUAL. DRY FILM THICKNESS FOR EACH COAT (WHITE AND BLACK) SHALL BE 2 MILS MINIMUM. PLYWOOD PANELS SHALL BE FASTENED TO CONCRETE WALL WITH 1/4" X 2" 1/4" GALV. LUG/BOLT. STEEL FASTENERS, AS MANUFACTURED BY RAMPUS CO., INC. OR EQUAL. THE SPACING OF FASTENERS SHALL NOT EXCEED 3'-0". THE PLYWOOD PANELS SHALL BE ERECTED ONLY AFTER ALL CONCRETE REPAIRS ARE COMPLETED.

THIS IS A SCANNED CADD PLOT

REVISION REQUIRES PAPER RASTER/VECTOR SOFTWARE. CONTACT PERIOD ENGINEERING AUTOMATION GROUP FOR FURTHER INFORMATION. 2D PLOT REVISION THIS PLOT IS 2004.

PROJ. NO.	REVISION	DATE	BY	CHKD	DATE
51780	FINAL CONSTRUCTION RELEASE (FCR)	10/01/04	AL		
51780	REVISED AND REISSUED FOR P.C.R.	10/01/04	AL		
51780	REVISED AND REISSUED FOR P.C.R.	10/01/04	AL		
51780	REVISED AND REISSUED FOR P.C.R.	10/01/04	AL		
51780	REVISED AND REISSUED FOR P.C.R.	10/01/04	AL		
51780	REVISED AND REISSUED FOR P.C.R.	10/01/04	AL		
51780	REVISED AND REISSUED FOR P.C.R.	10/01/04	AL		
51780	REVISED AND REISSUED FOR P.C.R.	10/01/04	AL		
51780	REVISED AND REISSUED FOR P.C.R.	10/01/04	AL		
51780	REVISED AND REISSUED FOR P.C.R.	10/01/04	AL		

PROJ. NO.	REVISION	DATE	BY	CHKD	DATE
51780	FINAL CONSTRUCTION RELEASE (FCR)	10/01/04	AL		
51780	REVISED AND REISSUED FOR P.C.R.	10/01/04	AL		
51780	REVISED AND REISSUED FOR P.C.R.	10/01/04	AL		
51780	REVISED AND REISSUED FOR P.C.R.	10/01/04	AL		
51780	REVISED AND REISSUED FOR P.C.R.	10/01/04	AL		
51780	REVISED AND REISSUED FOR P.C.R.	10/01/04	AL		
51780	REVISED AND REISSUED FOR P.C.R.	10/01/04	AL		
51780	REVISED AND REISSUED FOR P.C.R.	10/01/04	AL		
51780	REVISED AND REISSUED FOR P.C.R.	10/01/04	AL		
51780	REVISED AND REISSUED FOR P.C.R.	10/01/04	AL		

BECHTEL NATIONAL INC. SAN FRANCISCO

JOB NO. 15239

THIS DOCUMENT CONTAINS INFORMATION RELATING TO ACTIVITIES OF THE U.S. DEPARTMENT OF ENERGY. NOT TO BE REPRODUCED OR RELEASED WITHOUT PRIOR APPROVAL.

W/F BLDG. PROJ. DA TYPE W 780625 LAST 7 REV.

SAVANNAH RIVER PLANT-200Z AREA DEFENSE WASTE PROCESSING FACILITY-SALTSTONE

SALTSTONE SURFACE DISPOSAL VAULT FOUNDATION AND FLOOR PLAN, ELEVATION AND SECTIONS

CONCRETE STRUCTURAL

PROJECT: S2764

SCALE: 1/4" = 1'-0" UNO DATE: 12/01/04

DRAWN: ALLAN LAM

CHECKED: APPROVED: I.C.R.

APPROVED: FINAL NOT REQUIRED

W 780625