

RAS 14076

From: <vzabielski@morganlewis.com>
To: <mcf@nrc.gov>, <mjb5@nrc.gov>, <hearingdocket@nrc.gov>, <ngt@nrc.gov>, <mxc7@nrc.gov>, <BREDL@skybest.com>, <Atom.girl@mindspring.com>, <maryolson@main.nc.us>, <jcm5@nrc.gov>, <axj4@nrc.gov>, <lgm1@nrc.gov>, <pah@nrc.gov>
Date: Mon, Aug 13, 2007 1:33 PM
Subject: MFFF Site Tour Information

All,

The following instructions and attached maps are being provided by Shaw AREVA MOX Services LLC in support of the planned MOX facility site tour scheduled for August 21, 2007. Please contact me if you have any questions.

DOCKETED
USNRC

At 10:00 AM Tuesday, August 21, 2007 report directly to the SRS Badge office and bring two (2) forms of proper ID as required (one being a picture ID). See attached ID requirements. If you are using a birth certificate for identification it has to be the original or a certified copy with the raised seal.

August 13, 2007 (1:33pm)

OFFICE OF SECRETARY
RULEMAKINGS AND
ADJUDICATIONS STAFF

Docket No. 70-3098-MLA

Note the following information:

Random Vehicle Inspections

If you are stopped at the guard gate for a random inspection, you must:

- Step out of your car wearing your badge
- Open all doors, the trunk and compartments inside your vehicle
- Stand to the side until the security guard has completed his search and given the go ahead. Close the trunk, compartments and doors, then proceed to your destination

Items prohibited on SRS

The following items are PROHIBITED on SRS:

- Weapons, firearms and simulated firearms (example, real looking toys)
- Ammunition or incendiary devices, explosive materials such as firecrackers
- Alcoholic beverages (or empty cans or bottles of alcoholic beverages)
- Chemical irritants such as mace or pepper spray (small containers no greater than two ounces can be in your possession)
- Stun guns

Please contact me if you have any questions,

Regards,

Vince Zabielski

Vincent C. Zabielski*

Morgan, Lewis & Bockius LLP

1701 Market Street Philadelphia PA 19103-2921

Tel: 215.963.5732 | Fax: 877.432.9652

vzabielski@morganlewis.com | www.morganlewis.com

* Admitted in District of Columbia only

DISCLAIMER

This e-mail message is intended only for the personal

Template = SECY-043

SECY-02

use of the recipient(s) named above. This message may be an attorney-client communication and as such privileged and confidential. If you are not an intended recipient, you may not review, copy or distribute this message. If you have received this communication in error, please notify us immediately by e-mail and delete the original message.

CC: <DWGwyn@dcsmox.com>, <OPMendiratta@moxproject.com>, <Kathleen.Martin@hq.doe.gov>, <NSimpson@moxproject.com>, <WDDotson@moxproject.com>, <garrett.smith@nnsa.doe.gov>

Mail Envelope Properties (46C095D5.0BB : 16 : 187)

Subject: MFFF Site Tour Information
Creation Date Mon, Aug 13, 2007 1:32 PM
From: <vzabielski@morganlewis.com>

Created By: vzabielski@morganlewis.com

Recipients

nrc.gov

OWGWPO02.HQGWDO01
MCF (Mike Farrar)
HearingDocket (HearingDocket)

nrc.gov

OWGWPO01.HQGWDO01
MJB5 (Margaret Bupp)
MXC7 (Marcia Carpentier)

nrc.gov

TWGWPO02.HQGWDO01
NGT (Nicholas Trikouros)

nrc.gov

TWGWPO01.HQGWDO01
JCM5 (Jody Martin)
LGM1 (Lawrence McDade)

nrc.gov

OWGWPO04.HQGWDO01
AXJ4 (Andrea Jones (OGC))
PAH (Patricia Harich)

nnsa.doe.gov

garrett.smith CC

moxproject.com

WDDotson CC
NSimpson CC
OPMendiratta CC

hq.doe.gov

Kathleen.Martin CC

dcsmox.com
DWGwyn CC

main.nc.us
maryolson

mindspring.com
Atom.girl

skybest.com
BREDL

Post Office

OWGWPO02.HQGWDO01
OWGWPO01.HQGWDO01
TWGWPO02.HQGWDO01
TWGWPO01.HQGWDO01
OWGWPO04.HQGWDO01

Route

nrc.gov
nrc.gov
nrc.gov
nrc.gov
nrc.gov
nnsa.doe.gov
moxproject.com
hq.doe.gov
dcsmox.com
main.nc.us
mindspring.com
skybest.com

Files	Size	Date & Time
MESSAGE	2230	Monday, August 13, 2007 1:32 PM
TEXT.htm	3434	
SRS-MOX-MAC Map 04-2007.pdf		46592
Acceptable IDs.pdf	70755	
SRS Directions From Aiken.pdf		234318
Mime.822	489570	

Options

Expiration Date: None
Priority: Standard
ReplyRequested: No
Return Notification: None

Concealed Subject: No
Security: Standard

Junk Mail Handling Evaluation Results
Message is eligible for Junk Mail handling

This message was not classified as Junk Mail

Junk Mail settings when this message was delivered

Junk Mail handling disabled by User

Junk Mail handling disabled by Administrator

Junk List is not enabled

Junk Mail using personal address books is not enabled

Block List is not enabled

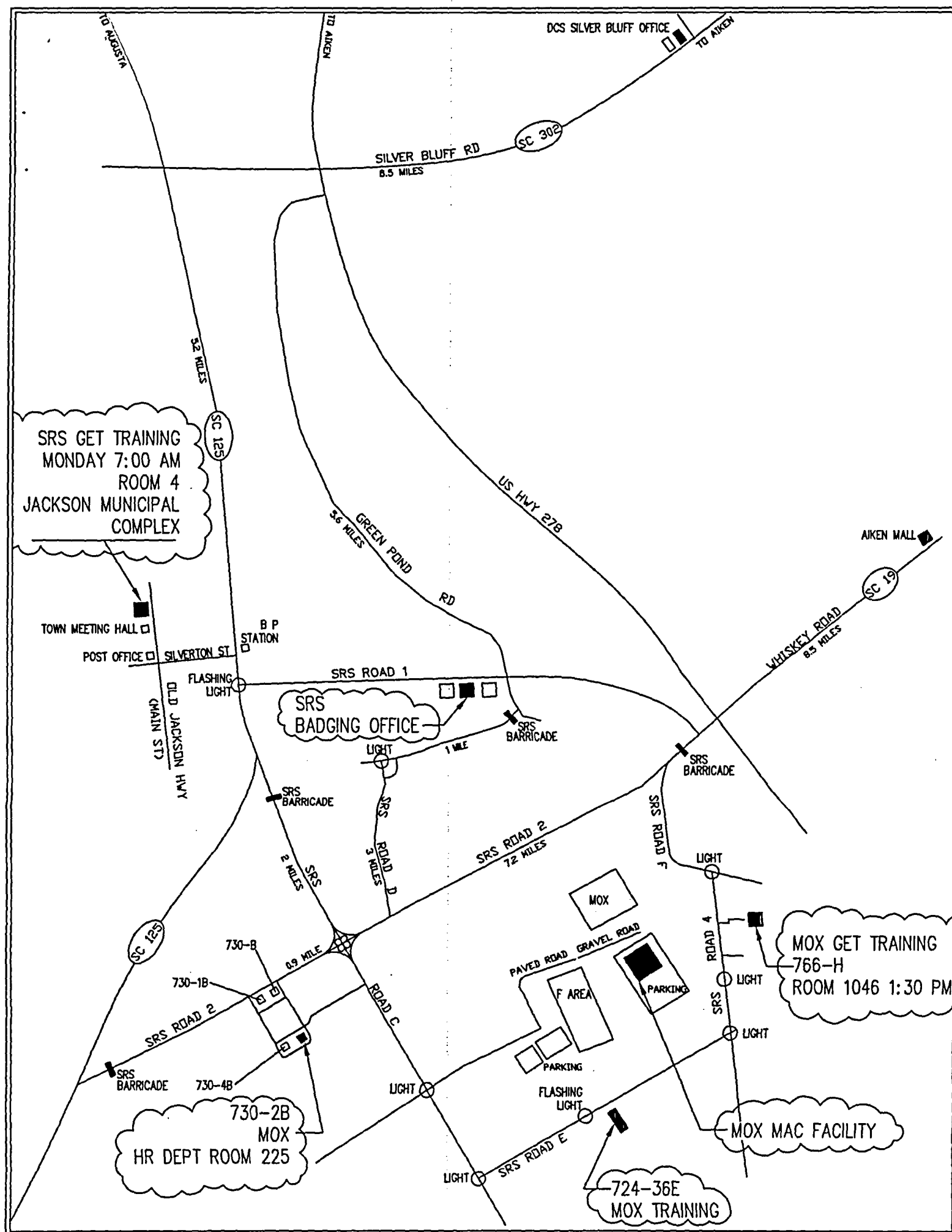

List of Acceptable IDs

Present one document from List A OR one document from List B and one from List C.

1. U.S. Passport (unexpired or expired)
2. Certificate of U.S. Citizenship (Form N-560 or N-561)
3. Certificate of Naturalization (Form N-550 or N-570)
4. Unexpired foreign passport, with I-551 stamp or attached Form I-94 indicating unexpired employment authorization
5. Permanent Resident Card or Alien Registration Receipt Card with photograph (Form I-151 or I-551)
6. Unexpired Temporary Resident Card (Form I-688)
7. Unexpired Employment Authorization Card (Form I-688A)
8. Unexpired Reentry Permit (Form I-327)
9. Unexpired Refugee Travel Document (Form I-571)
10. Unexpired Employment Authorization Document issued by DHS that contains a photograph (Form I-688B)

1. Driver's license or ID card issued by a state or outlying possession of the United States provided it contains a photograph or information such as name, date of birth, gender, height, eye color and address

2. ID card issued by federal, state or local government agencies or entities, provided it contains a photograph or information such as name, date of birth, gender, height, eye color and address

3. School ID card with a photograph

4. Voter's registration card

5. U.S. Military card or draft record

6. Military dependent's ID card

7. U.S. Coast Guard Merchant Mariner Card

8. Native American tribal document

9. Driver's license issued by a Canadian government authority

For persons under age 18 who are unable to present a document listed above:

10. School record or report card

11. Clinic, doctor or hospital record

12. Day-care or nursery school record

1. U.S. social security card issued by the Social Security Administration (other than a card stating it is not valid for employment)

2. Certification of Birth Abroad issued by the Department of State (Form FS-545 or Form DS-1350)

3. Original or certified copy of a birth certificate issued by a state, county, municipal authority or outlying possession of the United States bearing an official seal

4. Native American tribal document

5. U.S. Citizen ID Card (Form I-197)

6. ID Card for use of Resident Citizen in the United States (Form I-179)

7. Unexpired employment authorization document issued by DHS (other than those listed under List A)



SAVANNAH RIVER SITE

Where We Are: Directions from Aiken, SC

Directions:

- From Aiken to SRS/SRNL and Aiken County Technology Laboratory (ACTL) - pg. 1

- Aiken - detailed map - pg. 2

From Aiken to SRS/SRNL and Aiken County Technology Laboratory (ACTL)

- From the intersection of Richland Ave and Chesterfield St., turn south onto Chesterfield St. and continue south.
- Chesterfield St. becomes Whiskey Rd/Hwy 19
- Continue straight, Applebee's and Holiday Inn Express will be to your right in approx. 3.5 miles.
- Continuing straight for another 1.5 miles will put you at the intersection of Whiskey Rd. and Pine Log Road. You are now on the south side of Aiken, hotels and restaurants are available both north and south of this location.
- SRS/SRNL is straight ahead approx. 10 miles.
- After crossing Hwy 278, bear to your right onto Savannah River Site Road 1.
- For the ACTL, continue on SRS Road 1 for approx. 2.2 miles.
- Turn right onto Gateway Drive and travel approximately 1.4 miles
- ACTL is on right, behind the Research Center
- For SRS/SRNL, continue on SRS Road 1
- SRS/SRNL is on the left side of SRS Road 1 in approx. 2.4 miles beyond Gateway Drive. Just after the traffic signal at Green Pond Rd. (See the inset map for the Badge Office and parking).
- In most cases, you must first go to the Badge Office for access to either SRS or SRNL.

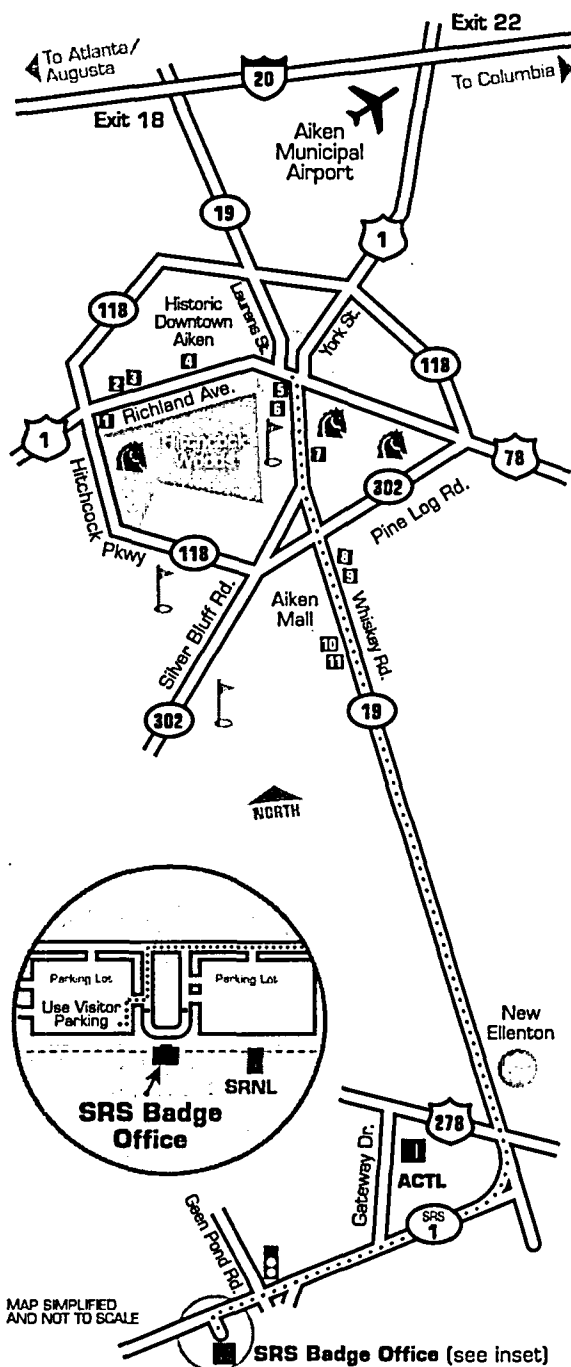



SAVANNAH RIVER SITE

Where We Are: Directions from Aiken, SC

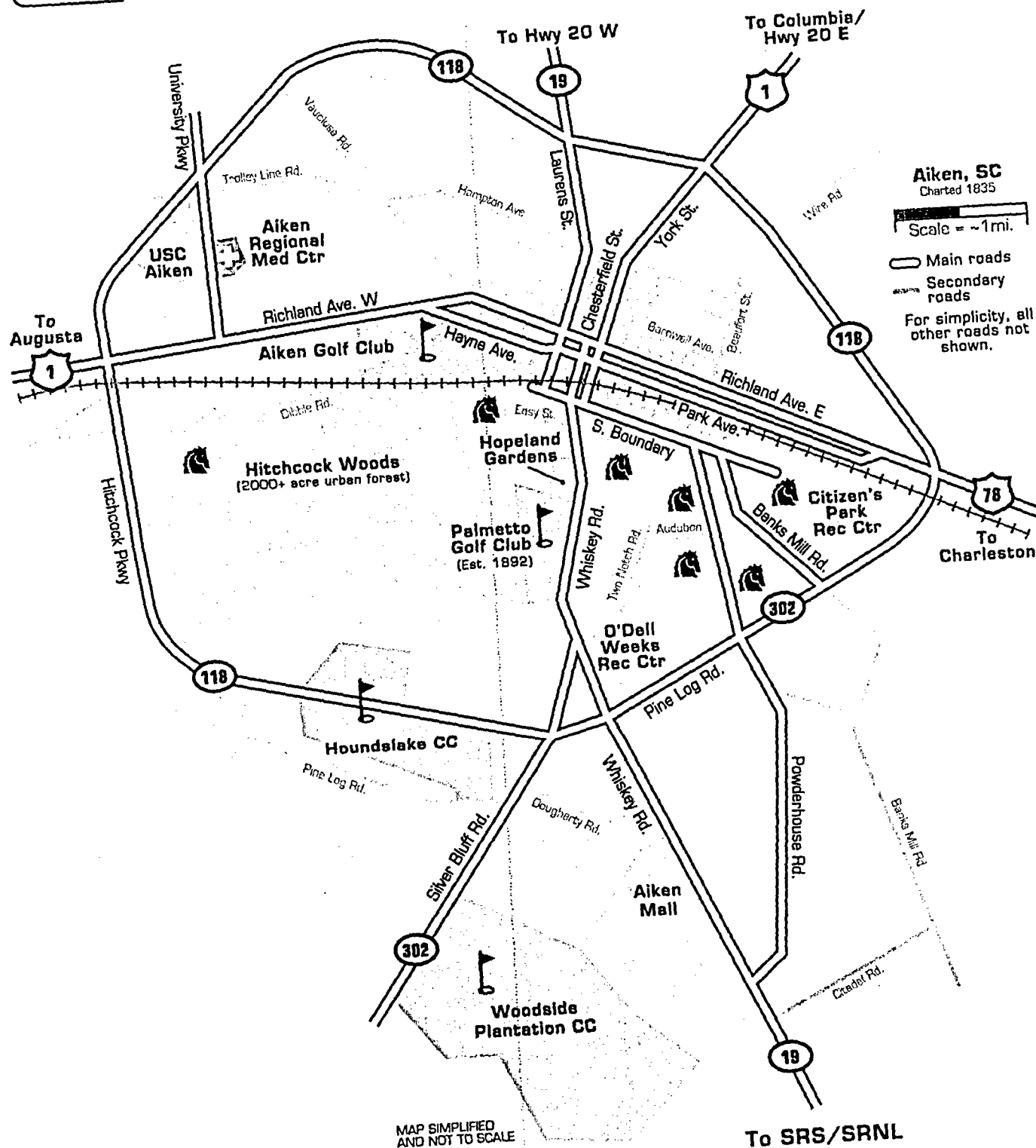

MAP SIMPLIFIED
AND NOT TO SCALE