

LEGEND:

- 1997 AERIAL TOPOGRAPHY
- DRAINAGE PATH/PONDED WATER
- UN-PAVED ROADS
- UMETCO 1000' SITE GRID
- RADON BARRIER LIMITS 1992 CONSTRUCTION
- RADON BARRIER BOUNDARY MODIFIED RECLAMATION PLAN

THE MODIFIED RECLAMATION DESIGN INCLUDED (WITH SUBSEQUENT NRC APPROVAL) EVALUATION OF THE EXISTING RECLAMATION COVER CONSTRUCTION COMPLETED IN 1992. ENDPOINTS EVALUATED INCLUDED SEISMIC DESIGN, SLOPE STABILITY, LIQUEFACTION POTENTIAL, SETTLEMENT, RADON BARRIER COVER CRACKING POTENTIAL, AND RADON ATTENUATION. REFER TO LICENSE AMENDMENT 38 AND CORRESPONDING TER DATED MAY 28, 1998 (SEE ATTACHMENT 1).

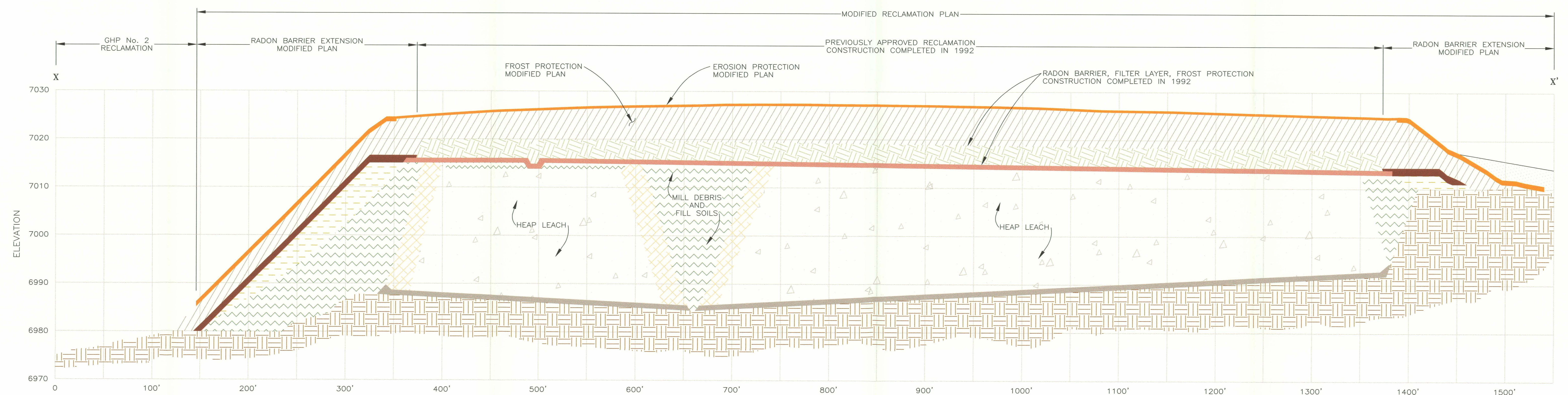

SECTION X-X'

SCALE: HORIZ. 1" = 50'

VERT. 1" = 10'

LEGEND 1992 RECLAMATION CONSTRUCTION

- EXISTING 1992 COVER
- EXISTING EMBANKMENT FILL
- EXISTING 1992 RECLAMATION FILL
- EXISTING CLAY LINER
- FOUNDATION SOIL
- HEAP LEACH MATERIAL
- EXISTING 1992 RADON BARRIER (12")

LEGEND MODIFIED RECLAMATION PLAN

- RECLAMATION FILL
- FROST PROTECTION LAYER
- TOE APRON FILL
- RADON BARRIER (18")
- RIPRAP

Umetco Minerals Corporation

2754 COMPASS DRIVE, SUITE 280, GRAND JUNCTION, CO 81506

AS BUILT

HEAP LEACH/GAP RECLAMATION
EXISTING COVER
AND
1997 - 2002 MODIFICATIONS

GAS HILLS, WYOMING

DATE: JUNE 2007

DWG: GH-HL-02-AB

SHEET 2 OF 13