

2001 COMPACTION TEST LOCATIONS
ELEVATION 6864 TO 6868

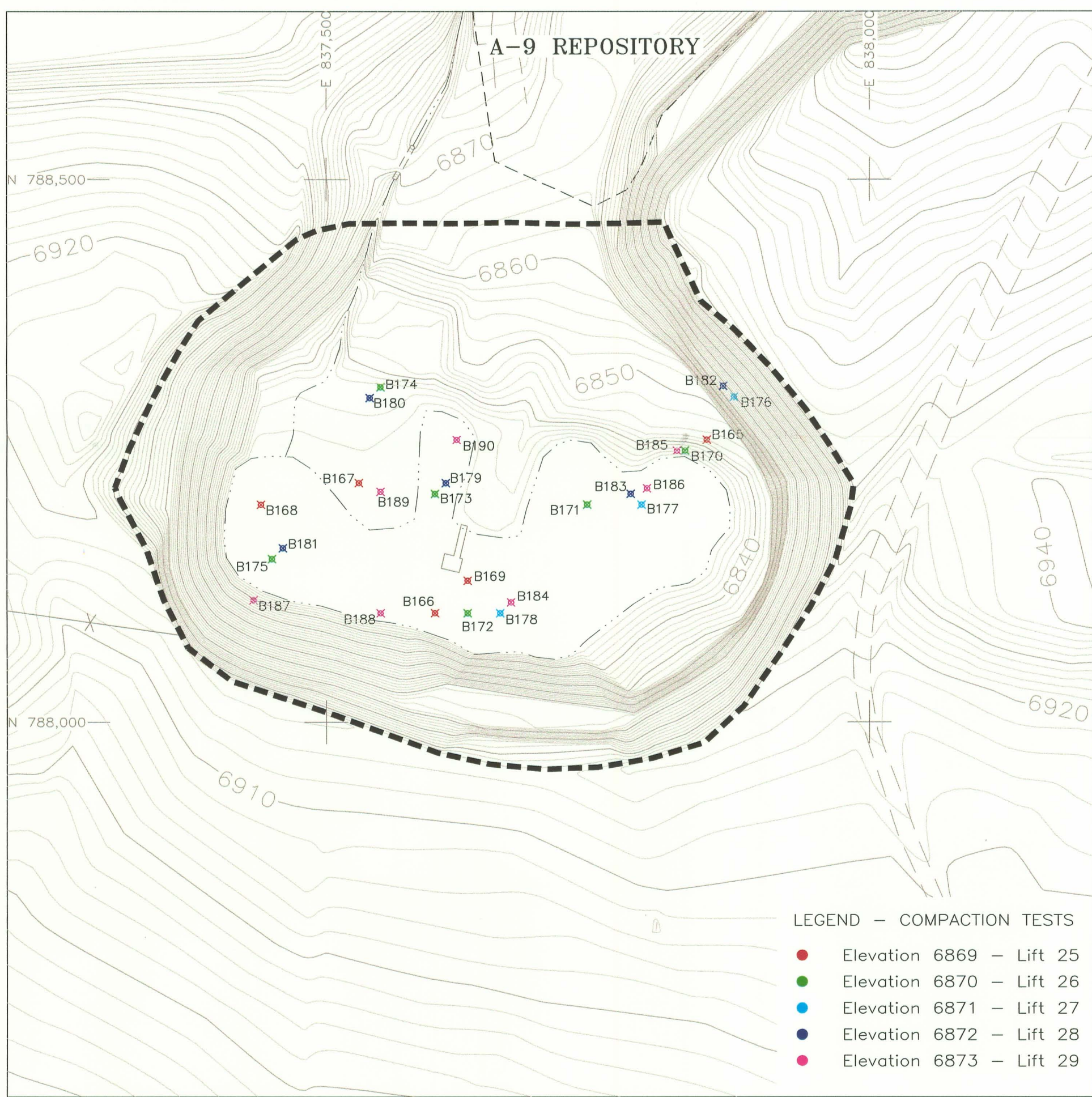

2001 COMPACTION TEST LOCATIONS
ELEVATION 6869 TO 6873

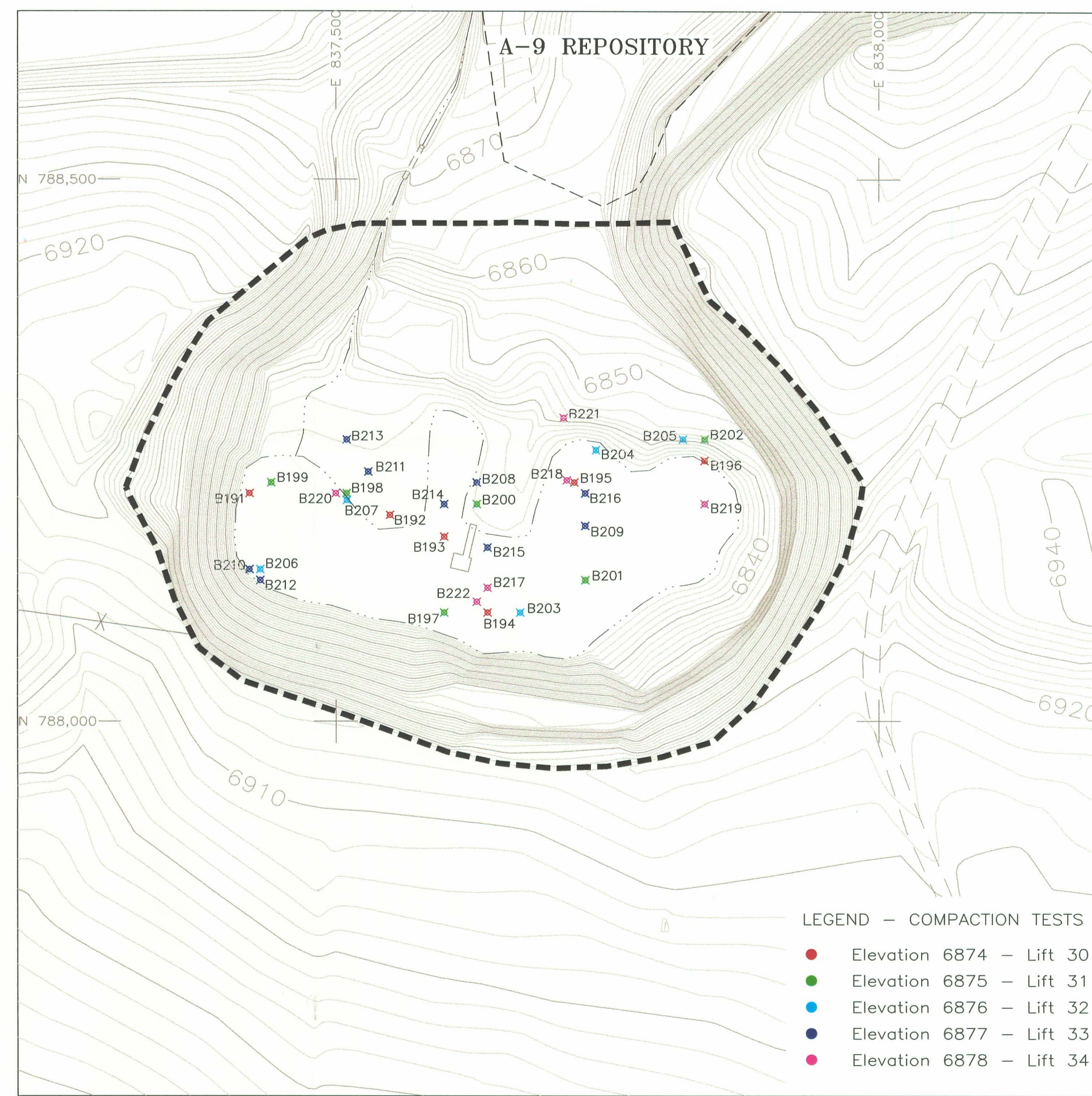

2001 COMPACTION TEST LOCATIONS
ELEVATION 6874 TO 6878

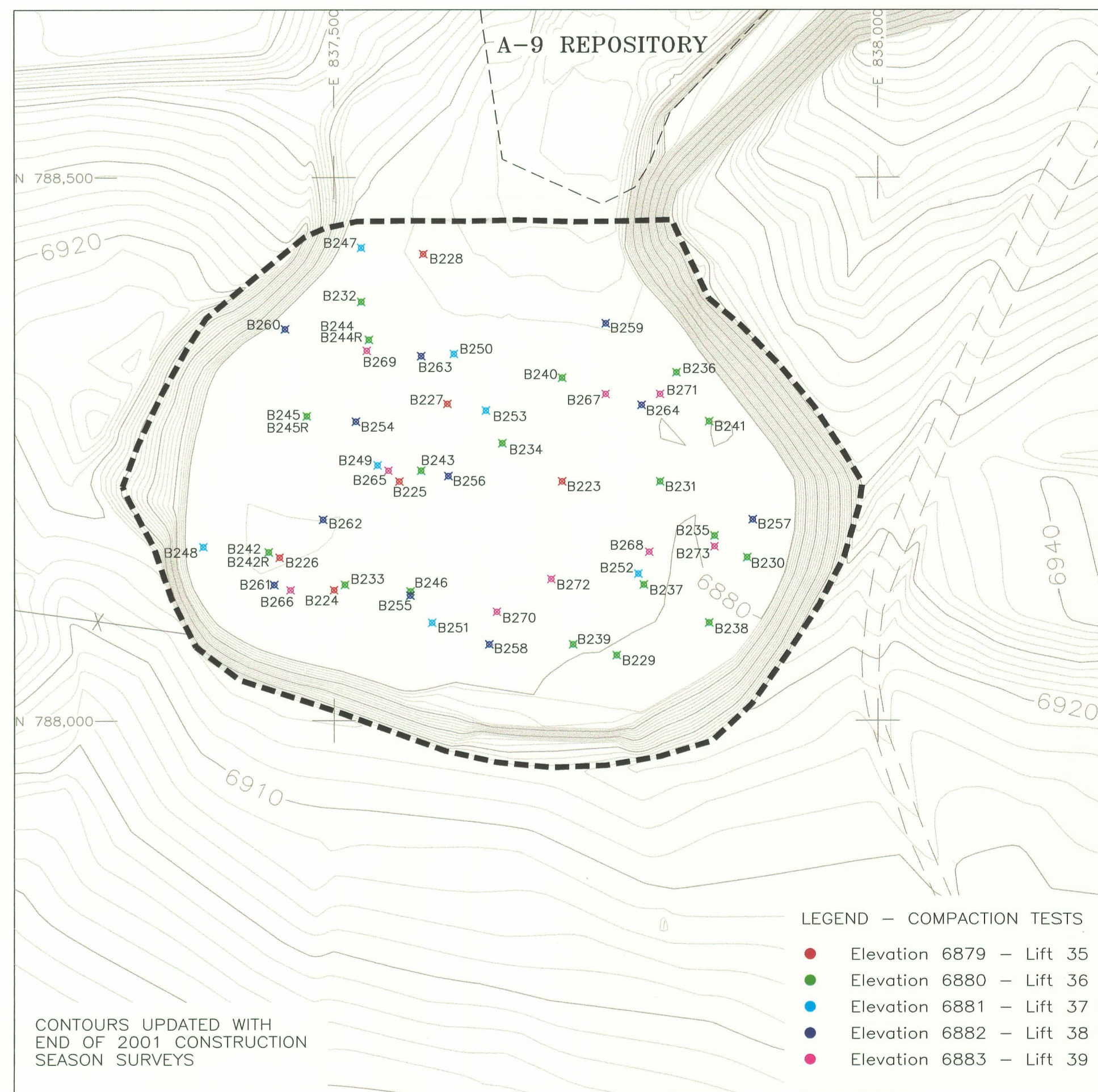

2001-2002 COMPACTION TEST LOCATIONS
ELEVATION 6879 TO 6883

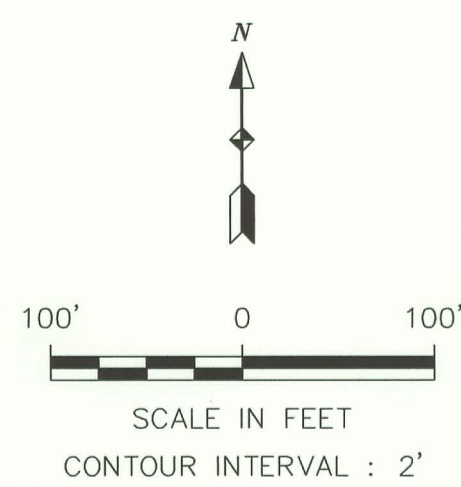

LEGEND:

- EXISTING 2000 AERIAL TOPOGRAPHY
CONTOURS UPDATED AS NOTED
- DRAINAGE PATH/PONDED WATER
- UN-PAVED ROADS
- UMETCO 1000' SITE GRID
- C-18 PIT BOUNDARY
- COMPACTION TEST LOCATIONS
AS NOTED

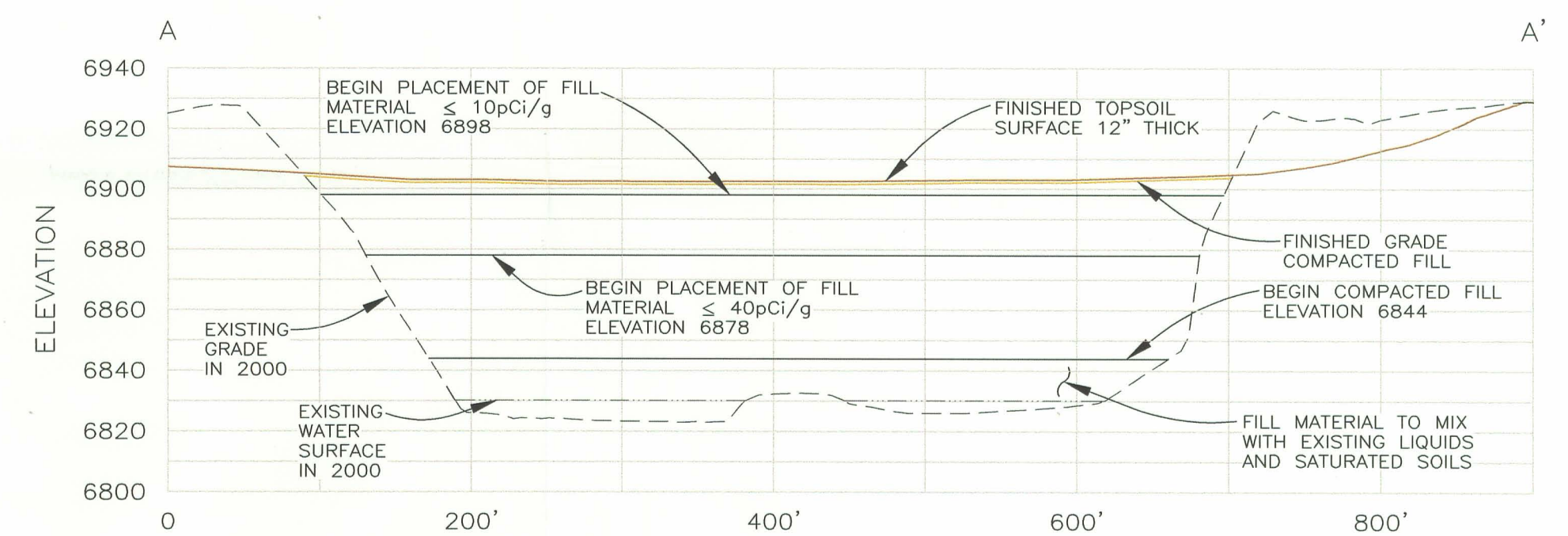

PROFILE LEGEND:

- EXISTING GRADE 2000 AERIAL TOPOGRAPHY
- EXISTING WATER LEVEL 2000 AERIAL TOPOGRAPHY
- FINISHED GRADE COMPACTED FILL — 2005
- FINISHED GRADE TOPSOIL PLACEMENT — 2006

Umetco Minerals Corporation
2754 COMPASS DRIVE, SUITE 280, GRAND JUNCTION, CO 81506

AS BUILT

**RECLAMATION OF THE C-18 PIT
COMPACTION TEST LOCATIONS
BACKFILL MATERIAL
ELEVATION 6864 TO ELEVATION 6883**

GAS HILLS, WYOMING