



Express Certified Mail – Return Receipt Requested

ED 849866013 US

Union Carbide Corporation

A Subsidiary of The Dow Chemical Company
PO Box 8361
3200/3300 Kanawha Turnpike
South Charleston, WV 25303
U.S.A

August 3, 2006

Mr. Dennis Lawyer
Nuclear Regulatory Commission - Region 1
475 Allendale Road
King of Prussia, Pennsylvania 19406-1415

**Subject: Union Carbide Corporation
South Charleston, West Virginia
Request for Facility Release**

B2.

47-00260-02

03066652

2006 AUG -4 PM 1:18

RECEIVED
REGION 1

Dear Mr. Lawyer,

Union Carbide Corporation (UCC), a wholly owned subsidiary of the Dow Chemical Company plans to change the utilization of its facility resources. Therefore, UCC requests that Building (B-747) and associated storage shed, previously used for radiation activities, be released for unrestricted use. UCC's intent is to demolish the facility as soon as practical, following your approval.

All radioactive materials have been removed from the building; and the building has been thoroughly wipe-tested and surveyed. The facility was wipe-tested and surveyed after all of the radioactive materials were removed. All wipe tests show removable contamination to be less than 50 dpm/100 cm². All survey results show that radiation levels in the building are not distinguishable from background levels. The details of the survey are shown in Attachments A and B.

Thank you for your anticipated prompt response. If you have any questions regarding this request, please contact the Radiation Safety Officer, Michael Boyd, at 304-747-7974.

Sincerely,

J. L. Blatt

Responsible Care Leader
West Virginia Operations

Attachments

139239
NMSS/RGNI MATERIALS-002

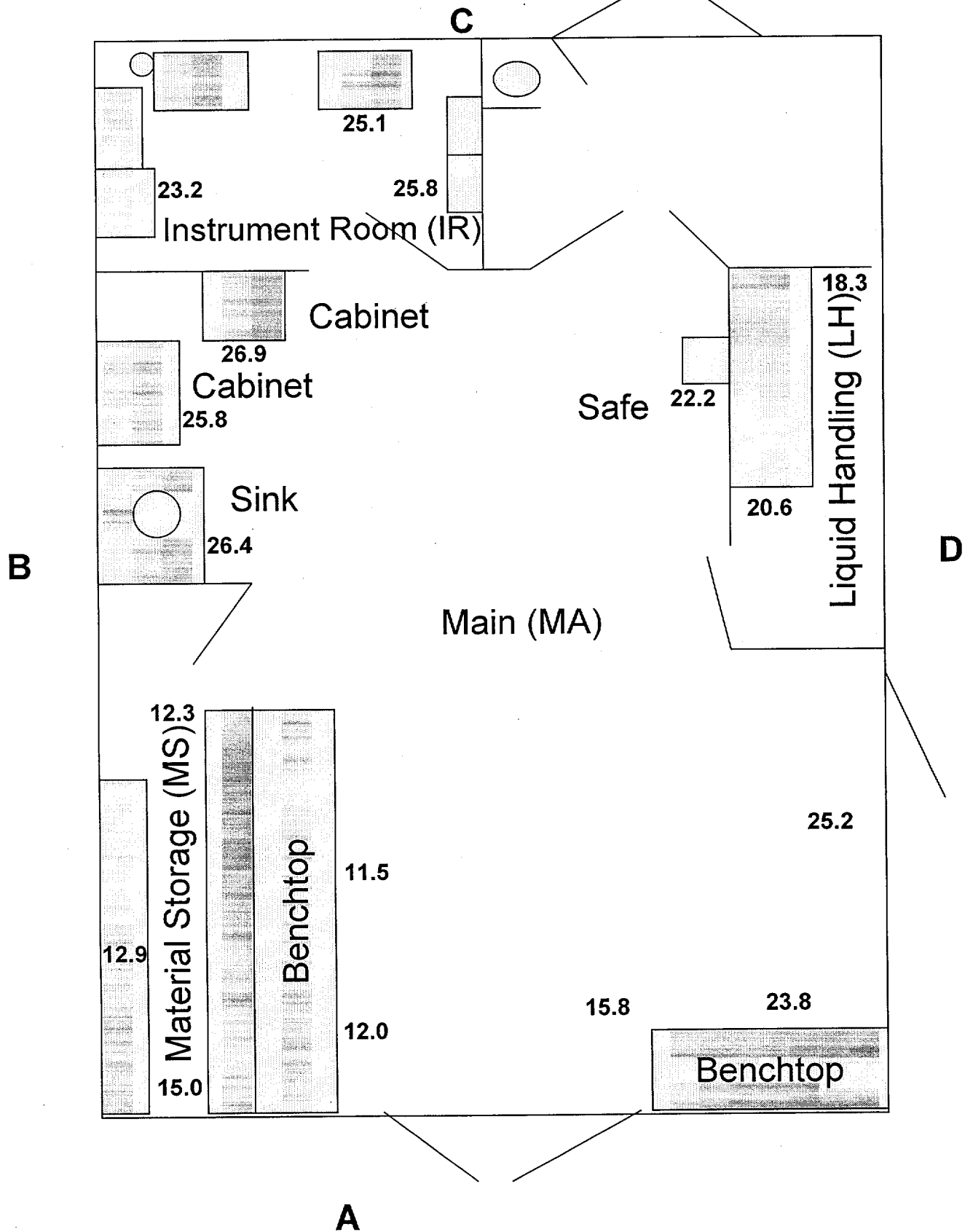

ATTACHMENT B

7/27/2006

B-747 Decommissioning Samples

Bldg	Area	Equipment	Direction	Sample #	Description
747	MA	BT	A	11	Left of Benchtop
747	MA	BT	A	12	Middle Benchtop
747	MA	DK	A	13	Interior Door Knob
747	MA	BT	A	14	Right Benchtop
747	MA	FL	A	15	Floor in Front of BT
747	MA	CA	A	16	Right Cabinet Door
747	MA	CA	A	17	Left Side, First Shelf of Cabinet
747	MA	DK	D	18	Interior Door Knob
747	MA	FL	D	19	Floor Mat (Center)
747	MA	SA	D	20	Safe - Shelf
747	MA	BT	B	21	Left of Benchtop
747	MA	BT	B	22	Middle of Benchtop
747	MA	BT	B	23	Right of Benchtop
747	MA	FL	B	24	Left Benchtop Floor Area
747	MA	FL	B	25	Middle Benchtop Floor Area
747	MA	FL	B	26	Right Benchtop Floor Area
747	MA	CA	B	27	Left Cabinet Over Benchtop
747	MA	CA	B	28	Middle Cabinet Over Benchtop
747	MA	CA	B	29	Right Cabinet Over Benchtop
747	MA	SK	B	30	Sink
747	MA	CAS2	B	31	Cabinet Next to Sink - Shelf 2
747	MA	CAS1	B	32	Cabinet Next to Sink - Shelf 1
747	MA	CAS3	C	33	Cabinet Shelf 3
747	MA	CAS5	C	34	Cabinet Shelf 5
747	IR	DT	B	35	Instrument Room Desk Top Left
747	IR	DT	B	36	Instrument Room Desk Top Right
747	IR	TT	B	37	Instrument Room Table Top Left
747	IR	TT	B	38	Instrument Room Table Top Right
747	IR	SMI	C	39	Instrument Room Skid-Mounted Instrument Top
747	IR	CDK	C	40	Instrument Room Computer Desk Keyboard
747	IR	WC1	C	41	Instrument Room Wall Cabinet 1
747	IR	WC2	C	42	Instrument Room Wall Cabinet 2
747	IR	TT-S1	B	43	Instrument Room Table Top Shelf #1
747	IR	TT-S3	B	44	Instrument Room Table Top Shelf #3
747	IR	PIC	C	1N	PIC machine north sample tube-opening
747	IR	PIC	C	1S	PIC machine south sample tube-opening
747	IR	PIC	C	3C	PIC machine push-buttons/keyboard
747	LH	BT	B	45	Left of Benchtop
747	LH	BT	B	46	Middle
747	LH	BT	B	47	Right
747	LH	FL	B	48	Left
747	LH	FL	B	49	Middle
747	LH	FL	B	50	Right
747	LH	DK	D	51	Door Knob on exterior of room
747	LH	RS	B	52	Ring Stand
747	MS	SH	D	53	Left Shelf Bottom
747	MS	SH	D	54	Middle Shelf 2nd
747	MS	SH	D	55	Right Shelf 3rd
747	MS	SH	D	56	Left Shelf 3rd
747	MS	DT	B	57	Benchtop Left
747	MS	BT	B	58	Benchtop Right
747	MS	DK	B	59	Door Knob - outside room
747	MS	DK	B	60	Door Knob - inside room
747	MS	SK	B	61	Sink
747	MS	TD	C	62	Paper towel dispenser next to sink

BenchTop	BT
Shelf	S1, S2...
Cabinet	CA
Safe	SA
Floor	FL
Door Knob	DK
Sink	SK
Desk Top	DT
Table Top	TT
Skid Mounted Instrument	SMI
Keyboard	CDK
Wall Cabinet	WC
Ring Stand	RS
PIC Machine	PIC
Paper Towel Dispenser	TD

Main Area	MA
Liquid Handling	LH
Material Storage	MS
Instrument Room	IR

Orientation
C
B D
A
roadway
Samples taken on 07/27/2006 by BP
For questions regarding samples, please contact: Michael Boyd 304-747-7974 boydmb@dow.com (or)

CUSTOMER REQUEST DOW CHEMICAL U.S.A
H & ES ANALYTICAL CHEMISTRY LABORATORY

ES-AL NUMBER: 4724

Date: 7/31/00	Plant Code:	Cost Center:	Project/Task:	Date Needed By:	<input type="checkbox"/> Return Sample <input checked="" type="checkbox"/> Discard Sample
SAMPLE OF: various wipe samples					
SAMPLE NUMBER(S): 1-53					
SAFETY HAZARDS		<input type="checkbox"/> Toxic	<input type="checkbox"/> Skin Irritant	<input type="checkbox"/> Low Flash Point	
		<input type="checkbox"/> Explosive	<input type="checkbox"/> Spontaneous Flammable	<input type="checkbox"/> Non-Hazardous	
		<input type="checkbox"/> Lachrymator		<input type="checkbox"/> Unusual Chemical Reactive	
NAME	DEPARTMENT	BUILDING	DOOR	PHONE	
Michael Boyal				304- 747-7974	
				304- (Rk) 747-5924	
RELATIVE ERROR SUFFICIENT, ETC.		APPROXIMATE LEVEL, ETC.		LOWER LIMIT, ETC.	
ANALYSIS REQUEST AND REASON FOR REQUEST. (PLANT OR PROJECT RELATED). INDICATE DOLLAR (\$) VALUE TO DOW.					
RESULTS:					
ALL WIPES BELOW DETECTION LIMIT OF 50 dpm/WIPE (2.3 x 10 ⁻⁵ µCi/wipe) INITIAL RM DATE 8/1/00					
SIGNATURE: Lindsay McElroy		PHONE: 989-638-8432		BUILDING: 1803	
DATE FINISHED: 8/1/00		HOURS: 5		RESULTS PHONED: SC Hansen	

This is to acknowledge the receipt of your letter/application dated

8/3/2006, and to inform you that the initial processing which includes an administrative review has been performed.

☒ Amendment 47-00260-02 There were no administrative omissions. Your application was assigned to a technical reviewer. Please note that the technical review may identify additional omissions or require additional information.

☐ Please provide to this office within 30 days of your receipt of this card

A copy of your action has been forwarded to our License Fee & Accounts Receivable Branch, who will contact you separately if there is a fee issue involved.

Your action has been assigned Mail Control Number 139239.
When calling to inquire about this action, please refer to this control number.
You may call us on (610) 337-5398, or 337-5260.