

From:
To:
Date:

Gregory Roach R11
"GMR@NRC.GOV" <gmr@nrc.gov>
"MLC@NRC.GOV" <mlc@nrc.gov> mahesh chawla NRC
12/1/05 3:45PM

Release

R11

4

3 occupied homes, the licensee is inquiring about testing their drinking wells.

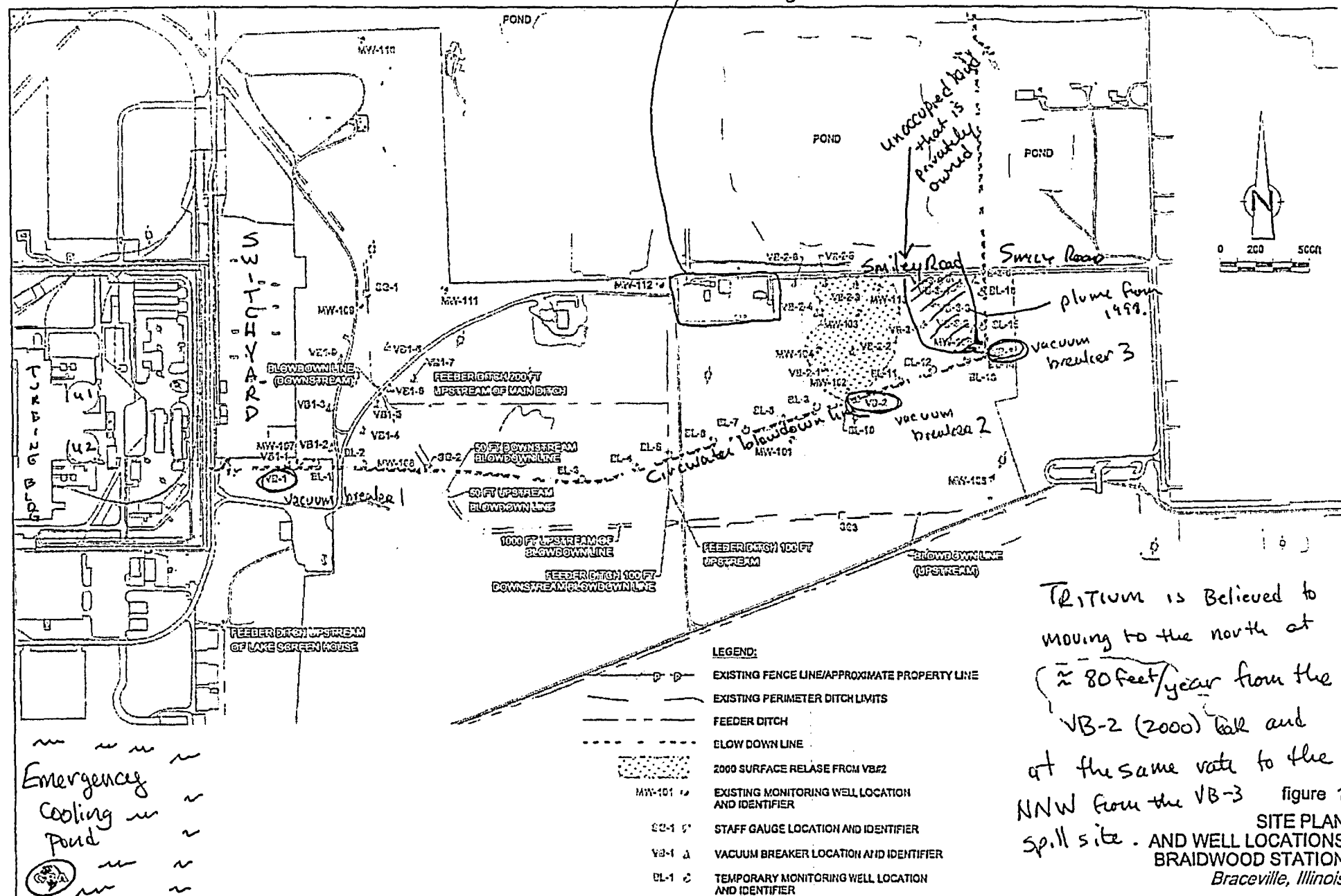

Tritium is Believed to
moving to the north at
(≈ 80 feet/year from the
VB-2 (2000) well and
at the same rate to the
NNW from the VB-3 figure 1
SITE PLAN
spill site. AND WELL LOCATIONS
BRAIDWOOD STATION
Braceville, Illinois