



Mid-Michigan Physicians, P.C.

Mid-Michigan  
Imaging Center

Division of  
Mid-Michigan  
Physicians, P.C.

1540 Lake Lansing Rd.  
Suite 107  
Lansing, MI 48912

Phone (517) 913-3800  
Fax (517) 913-3801

Directors:

James H. Deering, D.O.  
Christopher S. Sweet, M.D.

Manager:

Char Healy, B.S., ARRT

June 22, 2006

Bill Reichhold  
U.S. Nuclear Regulatory Commission  
Region III  
Materials Licensing Branch  
2443 Warrenville Road, Suite 210  
Lisle, Illinois 60532

Re: Additional Information  
Control # 315387

Dear Mr. Reichhold:

The following is in response to your faxed request for additional information dated 06/21/2006.

1. We confirm that that we had no history of leaking sources.
2. We have enclosed the following items for your review:
  - A. A diagram of our 1200 E. Michigan Ave. facility
  - B. A close-out data sheet that is keyed to the diagram noted above which notes:
    - a. Name of the person that conducted the survey and wipe test.
    - b. Date of the survey & wipe test
    - c. Notation of the instrumentation used
    - d. Calibration date for the survey meter

We look forward to our amendment.

Sincerely,

Daniel Williams, M.D., CEO

RECEIVED JUN 28 2006



Mid-Michigan Physicians, P.C.  
 Close-Out Survey Diagram  
 1200 E. Michigan Ave. Suite 460  
 Lansing Michigan 48912

NRC Materials License # 21-32527-01

Mid-Michigan  
 Imaging Center

Division of  
 Mid-Michigan  
 Physicians, P.C.

1540 Lake Lansing Rd.  
 Suite 107  
 Lansing, MI 48912

Phone (517) 913-3800  
 Fax (517) 913-3801

Directors:  
 James H. Deering, D.O.  
 Christopher S. Sweet, M.D.

Manager:  
 Char Healy, B.S., ARRT

NRC Materials License  
 21-32527-01

Mid-Michigan Physicians  
 1200 E. Michigan Ave. Suite 460  
 Lansing, Michigan 48912

Communication  
 Closet

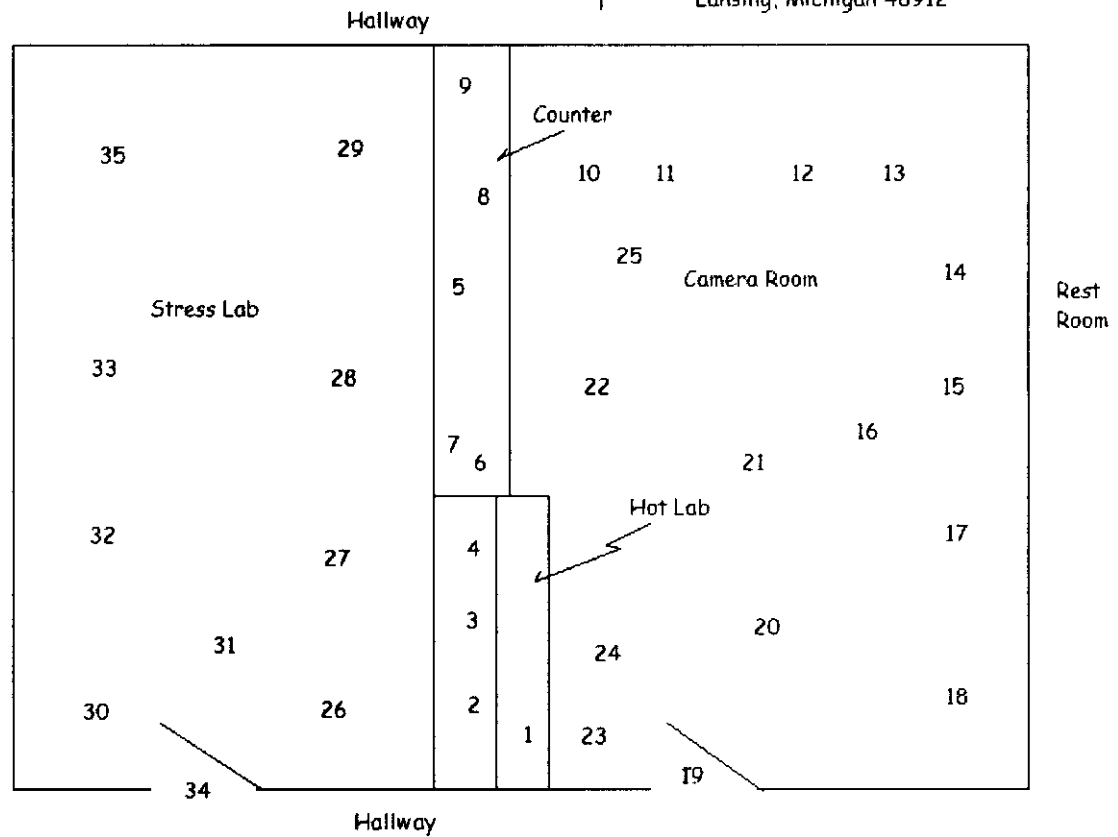

**Mid-Michigan Physicians 1200 E. Michigan Ave., Suite 460**

**License # 21-32527-01**

**Date:** 3/15/2006  
**Well Counter:** Caprac  
**Survey Meter:** Ludlum 14C SWGM  
 Calibrated 01/27/06

**Performed By:** C. Burns, CNMT  
**MDA:** 47 dpm  
**Check Value:** 1.25 mR/hr

		cpm	net dpm	mR/h
1	Hot Lab	506.00	0	0.02
2	Hot Lab	506.00	0	0.02
3	Hot Lab	506.00	0	0.02
4	Hot Lab	538.00	36.48	0.02
5	Counter	515.00	10.26	0.02
6	Counter	508.00	2.28	0.02
7	Counter	506.00	0	0.02
8	Counter	506.00	0	0.02
9	Counter	506.00	0	0.02
10	Cam Rm	506.00	0	0.02
11	Cam Rm	506.00	0	0.02
12	Cam Rm	506.00	0	0.02
13	Cam Rm	506.00	0	0.02
14	Cam Rm	506.00	0	0.02
15	Cam Rm	520.00	15.96	0.02
16	Cam Rm	516.00	11.4	0.02
17	Cam Rm	526.00	22.8	0.02
18	Cam Rm	517.00	12.54	0.02
19	Cam Rm	506.00	0	0.02
20	Cam Rm	518.00	13.68	0.02
21	Cam Rm	506.00	0	0.02
22	Cam Rm	506.00	0	0.02
23	Cam Rm	506.00	0	0.02
24	Cam Rm	506.00	0	0.02
25	Cam Rm	506.00	0	0.02
26	Stress Lab	506.00	0	0.02
27	Stress Lab	506.00	0	0.02
28	Stress Lab	506.00	0	0.02
29	Stress Lab	537.00	35.34	0.02
30	Stress Lab	506.00	0	0.02
31	Stress Lab	506.00	0	0.02
32	Stress Lab	506.00	0	0.02
33	Stress Lab	521.00	17.1	0.02
34	Stress Lab	506.00	0	0.02
35	Stress Lab	512.00	6.84	0.02
36			0	
37			0	
	Background	506		0.02

**ACTION LEVELS:** 2000 dpm  
 < 0.2 mR/hr

**Efficiency (dpm/cpm):** 1.14

**COMMENTS:** No evidence of removable contamination.

**RSO Signature:**

**FedEx**  
emp: 555044 27JUN06

**PRIORITY OVERNIGHT**

**WED**

TRK# **8497 5093 1044** FORM 0200

Deliver By:  
**28JUN06**  
A2

**60532** -IL-US

**ORD**  
**NC BDFA**

**FedEx** US Airbill  
Express

**849750931044**

**0200**

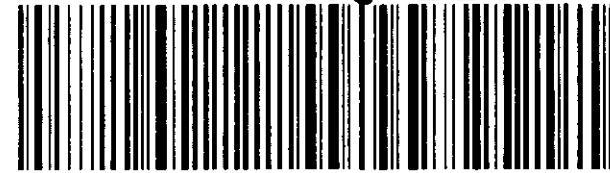

**1 From**  
Date **6/27/2006** Sender's FedEx Account Number  
Sender's Name **Char Healy** Phone **517-413-3800**  
Company **Mid Michigan Physicians PC**  
Address **1540 West Lake Lansing Road Ste 107**  
City **Lansing** State **MI** ZIP **48912**

**2 Your Internal Billing Reference**

**3 To**  
Recipient's Name **Bill Reichhold** Phone  
Company **US Nuclear Regulatory Commission Region II**  
Recipient's Address **Materials Licensing Branch**  
**2443 Warrenville Road Suite 210**  
City **Lisle** State **IL** ZIP **60532**

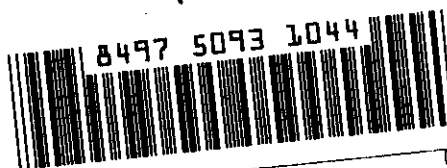

**4a Express Package**  
☒ FedEx Priority Overnight  
☐ FedEx 2Day  
☐ FedEx 3Day Freight

**4b Express Freight Service**  
**5** FedEx 1Day Freight  
**8** FedEx 2Day Freight  
**33** FedEx 3Day Freight

**6 Packaging**  
☒ FedEx Envelope  
☐ FedEx Pak  
☐ FedEx Box  
☐ FedEx Tube  
☐ Other

**6 Special Handling**  
**3** SATURDAY Delivery  
**1** HOLD Weekday at FedEx Location  
**31** HOLD Saturday at FedEx Location

**7 Payment**  
**2** Bill to:  
**3** Sender  
**4** Recipient  
**5** Third Party  
**6** Credit Card  
**7** Cash/Check

**8 Sign to Authorize Delivery Without a Signature**  
**467**

Go to **fedex.com**, or call 1.800.GoFedEx 1.800.463.3339 for U.S. domestic shipments, 1.800.247.4747 for international shipments. Call your local FedEx office if you are outside the U.S.