

# PHILIPSBURG AREA HOSPITAL



*"A Friend for Life"*

210 Loch Lomond Road

Philipsburg, PA 16866

(814) 342-7112

FAX 342-7124

*An Equal Opportunity Employer*

April 20, 2006

J-3

Licensing Assistant Section  
Nuclear Materials Safety Branch  
U S Nuclear Regulatory Commission Region 1  
475 Allendale Road  
King of Prussia, Pa. 19406-1415

030 33905

The Philipsburg Area Hospital is requesting termination of NRC Material License  
# 37-19105-02.

Enclosed are the documents:

: Receipt and transfer of all radioactive sealed sources and wipe test

: Final survey reports

  
Michael Loomis CEO

138728

NMSS/RONI MATERIALS-002

## APPENDIX H

<b>NRC FORM 314</b> <small>(7-2001)</small> <small>16 CFR 30.360(i); 40 CFR 20.170; 70 CFR 171.10; and 72 CFR 171.10</small>	<b>U.S. NUCLEAR REGULATORY COMMISSION</b>	<b>APPROVED BY OMB: NO. 3150-0028</b> <small>Estimated burden per response to comply with this mandatory collection request: 30 minutes. This submission is used by NRC as part of the basis for its determination that the facility is released for unrestricted use. Send comments regarding burden estimate to the Records Management Branch (T-6 EO), U.S. Nuclear Regulatory Commission, Washington, DC 20555-0004, or by internet e-mail to <a href="mailto:t61@nrc.gov">t61@nrc.gov</a>, and to the Desk Officer, Office of Information and Regulatory Affairs, NE08-10702, (3150-0028), Office of Management and Budget, Washington, DC 20503. If a means used to impose an information collection does not display a currently valid OMB control number, the NRC may not conduct or sponsor, and a person is not required to respond to, the information collection.</small>								
<b>CERTIFICATE OF DISPOSITION OF MATERIALS</b>		<small>EXPIRES: 07/31/2004</small>								
<b>LICENSEE NAME AND ADDRESS</b> <i>Philipsburg AREA Hospital</i> <i>210 Loch Lomond Road</i> <i>Philipsburg, Pa 16866</i>		<table border="1" style="width:100%; border-collapse: collapse;"> <tr> <td style="width:50%;"><b>LICENSE NUMBER</b></td> <td style="width:50%;"><b>DOCKET NUMBER</b></td> </tr> <tr> <td><i>37-19105-02</i></td> <td><i>030-33905</i></td> </tr> <tr> <td colspan="2"><b>LICENSE EXPIRATION DATE</b></td> </tr> <tr> <td colspan="2"><i>JAN 31, 2004</i></td> </tr> </table>	<b>LICENSE NUMBER</b>	<b>DOCKET NUMBER</b>	<i>37-19105-02</i>	<i>030-33905</i>	<b>LICENSE EXPIRATION DATE</b>		<i>JAN 31, 2004</i>	
<b>LICENSE NUMBER</b>	<b>DOCKET NUMBER</b>									
<i>37-19105-02</i>	<i>030-33905</i>									
<b>LICENSE EXPIRATION DATE</b>										
<i>JAN 31, 2004</i>										
<b>A. LICENSE STATUS (Check the appropriate box)</b> <input type="checkbox"/> This license has expired. <input checked="" type="checkbox"/> This license has not yet expired, please terminate it.										
<b>B. DISPOSAL OF RADIOACTIVE MATERIAL</b> <small>(Check the appropriate boxes and complete as necessary. If additional space is needed, provide attachments)</small> The licensee, or any individual executing this certificate on behalf of the licensee, certifies that:										
<input type="checkbox"/> 1. No radioactive materials have ever been procured or possessed by the licensee under this license.										
<input checked="" type="checkbox"/> 2. All activities authorized by this license have ceased, and all radioactive materials procured and/or possessed by the licensee under this license number cited above have been disposed of in the following manner:										
<input checked="" type="checkbox"/> a. Transfer of radioactive materials to the licensee listed below: <i>Cardinal Health</i>										
<input type="checkbox"/> b. Disposal of radioactive materials:										
<input checked="" type="checkbox"/> 1. Directly by the licensee: <i>Decay-in-storage</i>										
<input type="checkbox"/> 2. By licensed disposal site:										
<input type="checkbox"/> 3. By waste contractor:										
<input type="checkbox"/> c. All radioactive materials have been removed such that any remaining residual radioactivity is within the limits of 10 CFR Part 20, Subpart E, and is ALARA.										
<b>C. SURVEYS PERFORMED AND REPORTED</b>										
<input checked="" type="checkbox"/> 1. A radiation survey was conducted by the licensee. The survey confirms:										
<input checked="" type="checkbox"/> a. the absence of licensed radioactive materials										
<input type="checkbox"/> b. that any remaining residual radioactivity is within the limits of 10 CFR 20, Subpart E, and is ALARA.										
<input checked="" type="checkbox"/> 2. A copy of the radiation survey results:										
<input checked="" type="checkbox"/> a. is attached; or <input type="checkbox"/> b. is not attached (Provide explanation); or <input type="checkbox"/> c. was forwarded to NRC on: _____ Date _____										
<input type="checkbox"/> 3. A radiation survey is not required as only sealed sources were ever possessed under this license, and										
<input type="checkbox"/> a. The results of the latest leak test are attached; and/or <input type="checkbox"/> b. No leaking sources have ever been identified.										
<b>The person to be contacted regarding the information provided on this form:</b>										
NAME	TITLE	TELEPHONE (include Area Code)								
E-MAIL ADDRESS										
Use all future correspondence regarding this license to:										
<b>C. CERTIFYING OFFICIAL</b> <b>I CERTIFY UNDER PENALTY OF PERJURY THAT THE FOREGOING IS TRUE AND CORRECT</b>										
PRINTED NAME AND TITLE	SIGNATURE	DATE								
<i>Michael Morris CRO</i>	<i>[Signature]</i>	<i>4/3/06</i>								
<small>WARNING: FALSE STATEMENTS IN THIS CERTIFICATE MAY BE SUBJECT TO CIVIL AND/OR CRIMINAL PENALTIES. NRC REGULATIONS REQUIRE THAT SUBMISSIONS TO THE NRC BE COMPLETE AND ACCURATE IN ALL MATERIAL RESPECT. 18 U.S.C. SECTION 1001 MAKES IT A CRIMINAL OFFENSE TO MAKE A WILLFULLY FALSE STATEMENT OR REPRESENTATION TO ANY DEPARTMENT OR AGENCY OF THE UNITED STATES AS TO ANY MATTER WITHIN ITS JURISDICTION.</small>										

NRC FORM 314 (7-2001)

PRINTED ON RECYCLED PAPER

This form was designed using InForm

## APPENDIX H

NRC-

## CERTIFICATE OF DISPOSITION OF MATERIALS

PLEASE READ THESE INSTRUCTIONS BEFORE COMPLETING NRC FORM 314.

Subpart E of 10 CFR Part 20 establishes the radiological criteria for license terminations/decommissioning of facilities licensed under 10 CFR Parts 30, 40, 50, 60, 61, 70, and 72, as well as other facilities subject to the Commission's jurisdiction under the Atomic Energy Act of 1954, as amended, and the Energy Reorganization Act of 1974, as amended.

## INSTRUCTIONS

Section B, Item 2.

Licensees should describe the specific radioactive material transfer actions. If radioactive wastes were generated in terminating this license, the licensee should describe the disposal actions taken, including the disposition of low-level radioactive waste, mixed waste, greater-than-Class-C waste, and sealed sources.

Section B, Item 2.a.

The information provided concerning the transfer of radioactive material to another licensee should specify the date of the transfer, the name of the licensee recipient, an individual contact name and telephone number for the licensee recipient, and the recipient's NRC or Agreement State license number.

Section B, Item 2.b.

For disposal of radioactive materials, licensees should describe the specific disposal method or procedure (e.g., decay-in-storage). For those cases when radioactive materials are disposed of by a licensed disposal site or by a waste contractor, the licensee should specify the name, address, and telephone number of the licensed disposal site operator or waste contractor.

Section B, Item 2.c.

"Residual radioactivity," as defined in 10 CFR 20.1003, means radioactivity in 'areas' (structures, materials, soils, etc.) remaining as a result of activities (licensed and unlicensed) under the licensee's control from sources used by the licensee, excluding background radiation. ALARA is defined in 10 CFR 20.1003.

## FILE CERTIFICATES AS FOLLOWS:

## IF YOU ARE LOCATED IN:

CONNECTICUT, DELAWARE, DISTRICT OF COLUMBIA,  
MAINE, MARYLAND, MASSACHUSETTS, NEW HAMPSHIRE,  
NEW JERSEY, NEW YORK, PENNSYLVANIA, RHODE  
ISLAND, OR VERMONT, SEND CERTIFICATES TO:

LICENSING ASSISTANT SECTION  
NUCLEAR MATERIALS SAFETY BRANCH  
U.S. NUCLEAR REGULATORY COMMISSION, REGION I  
475 ALLENDALE ROAD  
KING OF PRUSSIA, PA 19406-1415

ALABAMA, FLORIDA, GEORGIA, KENTUCKY, MISSISSIPPI,  
NORTH CAROLINA, PUERTO RICO, SOUTH CAROLINA,  
TENNESSEE, VIRGINIA, VIRGIN ISLANDS, OR WEST  
VIRGINIA, SEND CERTIFICATES TO:

NUCLEAR MATERIALS SAFETY SECTION  
U. S. NUCLEAR REGULATORY COMMISSION, REGION II  
SAM NUNN ATLANTA FEDERAL CENTER  
61 FORSYTH STREET, S.W., SUITE 23785  
ATLANTA, GEORGIA 30303-8931

## IF YOU ARE LOCATED IN:

ILLINOIS, INDIANA, IOWA, MICHIGAN, MINNESOTA,  
MISSOURI, OHIO, OR WISCONSIN, SEND CERTIFICATES  
TO:

MATERIALS LICENSING SECTION  
U.S. NUCLEAR REGULATORY COMMISSION, REGION III  
801 WARRENVILLE RD.  
LISLE, IL 60532-4351

ALASKA, ARIZONA, ARKANSAS, CALIFORNIA,  
COLORADO, HAWAII, IDAHO, KANSAS, LOUISIANA,  
MONTANA, NEBRASKA, NEVADA, NEW MEXICO, NORTH  
DAKOTA, OKLAHOMA, OREGON, PACIFIC TRUST  
TERRITORIES, SOUTH DAKOTA, TEXAS, UTAH,  
WASHINGTON, OR WYOMING, SEND CERTIFICATES TO:

MATERIAL RADIATION PROTECTION SECTION  
U. S. NUCLEAR REGULATORY COMMISSION, REGION IV  
811 RYAN PLAZA DRIVE, SUITE 400  
ARLINGTON, TX 76011-8064

**CardinalHealth**

Cardinal Health Location 115  
3432 Route 764 Sugar Run Plaza  
Duncansville, PA 16835  
(814) 942 2545  
fax: (814) 942-2596  
cell: (814) 937-8194  
michael.w.miller@cardinal.com

**This document acknowledges the receipt and transfer to Cardinal Health Nuclear Pharmacy Services Location 115 at the above address of all radioactive sealed sources listed on the attached "Semi-annual Sealed Source Inventory and Wipe Test" report dated April 10, 2006 from the Philipsburg Hospital Nuclear Medicine Department located at Loch Lomond Road, Philipsburg, PA 16866.**

Michael W. Miller

April 13, 2006

1-800-446-7622

COPYRIGHT 2006 WILEY &amp; SONS

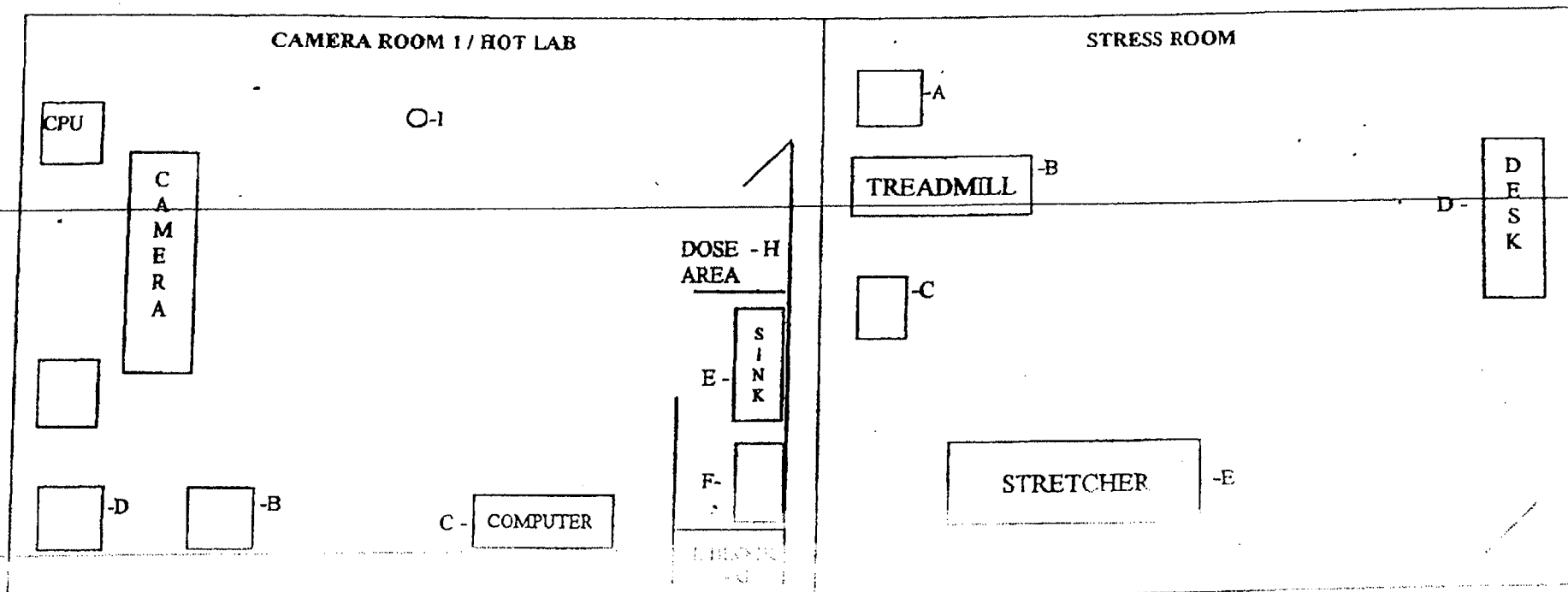

Final Dept. Survey

4-13-06

DAILY SURVEY AREAS

T.L. Weaver

DATE 4-13-06

TECH TLW

BKG .02

METER 73410

A .02 CAMERA  
 B .02 WORK STATION  
 C .02 COMPUTER  
 D .02 WELL COUNTER  
 E .02 SINK  
 F .02 DOSE CALIBRATOR  
 G .02 L BLOCK  
 H .02 INJECTION AREA  
 I .02 WASTE CAN

A .02 INJECTION AREA  
 B .02 TREADMILL  
 C .02 MONITOR  
 D .02 DESK  
 E .02 STRETCHER

Trigger levels for

Restricted 5mr/hr  
 Unrestricted .5mr/hr

874

ALL DATA RECORDED IN mr/hr

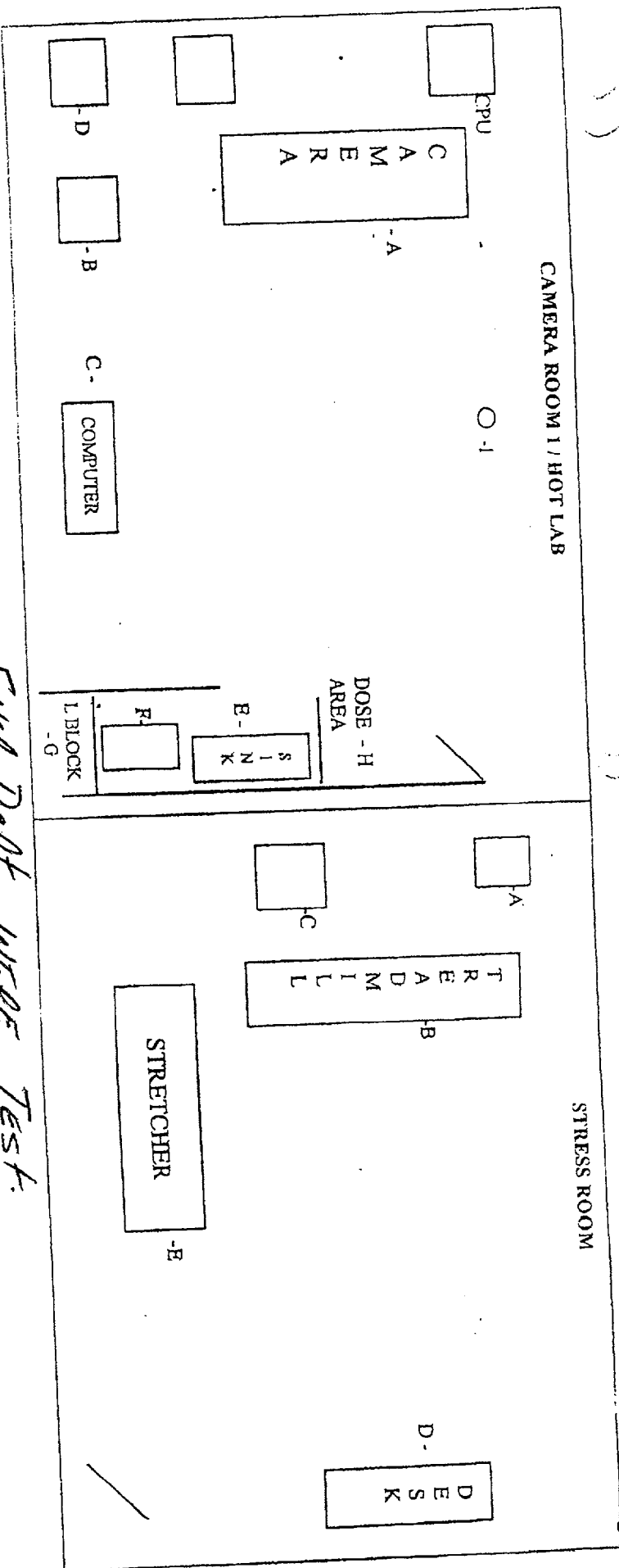

DATE 4-18-06

TECH TL

BKG 397

*Final Dept Wipe Test.*  
*4-13-06*  
*TL Weaver*

WEEKLY WIPE AREAS

Net Count	DEM	
A <u>63</u>	<u>212</u>	CAMERA
B		WORK STATION
C		COMPUTER
D		WELL COUNTER
E		SINK
F		DOSE CALIBRATOR
G		L BLOCK
H		INJECTION AREA
I		WASTE CAN
Efficiency - <u>2000 dpm</u>		

Net Count	DPM	
A <u>105</u>	<u>352</u>	INJECTION AREA
B		TREADMILL
C		MONITOR
D		TABLE
E		STRETCHER
Trigger levels for		

Restricted 2000 dpm  
 Unrestricted 2000 dpm  
 DPM-CPM/efficiency decimal form: 0.3077 0.247

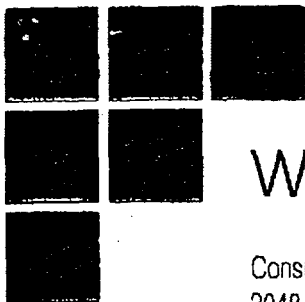

## Walter L. Robinson & Associates

Consultant Medical Radiation Health Physicists

2048 William Penn Way • Lancaster, PA 17601 • 717-291-9813 • 800-446-7622 Voice Mail

www.walterrobinson.com

Fax 717-295-7496

Dear Client,

November 30, 2003

Yes, another year has come and gone. This year we gained experience with some new high tech procedures including: Digital mammography, Bexxar, Theraspheres, PACS, C.R. and D.R. We all attended Digital Mammography seminars this year in preparation for the new wave of interest in digital mammography units. I have performed ACR/MQSA accreditation/compliance checks on two units to date, with several more ordered by clients. Jay and I have performed A.C.R. C.T. accreditation evaluations, and I have performed M.R.I. and Nuclear Medicine ACR accreditation evaluations. I will be attending R.S.N.A. this year to check out equipment as well as to attend the AAPM Rules and Regulation and AAPM Radiation Protection Committee Meetings, as I am still a member.

This year I have given a presentation entitled: Radioactive Terrorism (Dirty Bombs) to E.M.T.s in the Poconos. I will have the presentation posted on the website by the time you receive this letter.

As you may know my address, and the address of Walter L. Robinson & Associates office is now: 2048 William Penn Way, Lancaster, PA 17601. The only change from the move that affects clients is the fax number. It is (only) 717-295-7496. The old fax number 1-800-446-7622 or 717-291-9813 X-8 is no longer available. The voicemail still utilizes 717-291-9813 or 1-800-446-7622.

In an effort to reign in expenses this year we have managed to reduce our annual fee increase to about 6.5%. The on-going expenses driving this rate include salaries of 3 very good Associates, healthcare premiums, other insurances, and transportation (fuel). To achieve fiscal parity, we also are required to significantly increase the hourly rate of our Emergency Mammography Services.

The specific fee schedule for 2003 is attached.

We feel the arrangement of a consultant versus a full time physicist is still a cost effective alternative for all of our clients. We deeply appreciate your continued reliance on our services. It is our pleasure to continue to earn your respect and trust. We hope to continue to demonstrate our value to you with this new fee structure. Thank you for your consideration.

Sincerely,

Walter L. Robinson, M.S., D.A.B.S.N.M., D.A.B.M.P., D.A.B.R.(Eq)

Consultant Certified Medical Radiation Health & Diagnostic Imaging Physicist

Walter L. Robinson and Associates



NRC FORM 374

U.S. NUCLEAR REGULATORY COMMISSION

PAGE 1 OF 2 PAGES

Amendment No. 6

**MATERIALS LICENSE**

Pursuant to the Atomic Energy Act of 1954, as amended, the Energy Reorganization Act of 1974 (Public Law 93-438), and Title 10, Code of Federal Regulations, Chapter I, Parts 30, 31, 32, 33, 34, 35, 36, 39, 40, and 70, and in reliance on statements and representations heretofore made by the licensee, a license is hereby issued authorizing the licensee to receive, acquire, possess, and transfer byproduct, source, and special nuclear material designated below; to use such material for the purpose(s) and at the place(s) designated below; to deliver or transfer such material to persons authorized to receive it in accordance with the regulations of the applicable Part(s). This license shall be deemed to contain the conditions specified in Section 183 of the Atomic Energy Act of 1954, as amended, and is subject to all applicable rules, regulations, and orders of the Nuclear Regulatory Commission now or hereafter in effect and to any conditions specified below.

<p>Licensee</p> <p>1. Philipsburg Area Hospital</p> <p>2. 210 Loch Lomond Road Philipsburg, Pennsylvania 16866</p>	<p>In accordance with the letter dated January 13, 2003,</p> <p>3. License number 37-19105-02 is amended in its entirety to read as follows:</p> <p>4. Expiration date January 31, 2011</p> <p>5. Docket No. 030-33905 Reference No.</p>	
<p>6. Byproduct, source, and/or special nuclear material</p> <p>A. Any byproduct material permitted by 10 CFR 35.100</p> <p>B. Any byproduct material permitted by 10 CFR 35.200</p>	<p>7. Chemical and/or physical form</p> <p>A. Any</p> <p>B. Any</p>	<p>8. Maximum amount that licensee may possess at any one time under this license</p> <p>A. As needed</p> <p>B. As needed</p>
<p>9. Authorized use:</p> <p>A. Any uptake, dilution and excretion study permitted by 10 CFR 35.100.</p> <p>B. Any imaging and localization study permitted by 10 CFR 35.200.</p>		

**CONDITIONS**

10. Licensed material may be used or stored only at the licensee's facilities located at Loch Lomond Road, Philipsburg, Pennsylvania.
11. The Radiation Safety Officer for this license is Bernard DiGiacobbe, M.D.
12. Licensed material is only authorized for use by, or under the supervision of:
- A. Individuals permitted to work as an authorized user in accordance with 10 CFR 35.13 and 35.14.
- B. The following individuals are authorized users for medical use as indicated:

NRC FORM 374A

U.S. NUCLEAR REGULATORY COMMISSION

PAGE 2 of 2 PAGES

**MATERIALS LICENSE  
SUPPLEMENTARY SHEET**

License Number

37-19105-02

Docket or Reference Number

030-33905

Amendment No. 6

Authorized UsersMaterial and Use

Bernard DiGiacobbe, M.D.

35.100; 35.200

Kevin Paisley, M.D.

35.100; 35.200

13. In addition to the possession limits in Item 8, the licensee shall further restrict the possession of licensed material to quantities below the minimum limit specified in 10 CFR 30.35(d), 40.36(b), and 70.25(d) for establishing financial assurance for decommissioning.
14. The licensee is authorized to transport licensed material in accordance with the provisions of 10 CFR Part 71, "Packaging and Transportation of Radioactive Material."
15. Except as specifically provided otherwise in this license, the licensee shall conduct its program in accordance with the statements, representations, and procedures contained in the documents, including any enclosures, listed below. This license condition applies only to those procedures that are required to be submitted in accordance with the regulations. Additionally, this license condition does not limit the licensee's ability to make changes to the radiation protection program as provided for in 10 CFR 35.26. The U.S. Nuclear Regulatory Commission's regulations shall govern unless the statements, representations, and procedures in the licensee's application and correspondence are more restrictive than the regulations.

A. Letter dated July 6, 2000

B. Letter dated October 8, 2002

For the U.S. Nuclear Regulatory Commission

*Original signed by Michelle Beardsley*Date January 29, 2003

By

Michelle Beardsley  
Nuclear Materials Safety Branch 1  
Division of Nuclear Materials Safety  
Region I  
King of Prussia, Pennsylvania 19406

24336504

This is to acknowledge the receipt of your letter/application dated

*CTR / NAC 314*  
*4/20/2006 / 070 #13/2006* and to inform you that the initial processing which includes an administrative review has been performed.

☒ *7/24/06 37-1910502* There were no administrative omissions. Your application was assigned to a technical reviewer. Please note that the technical review may identify additional omissions or require additional information.

☐ Please provide to this office within 30 days of your receipt of this card

A copy of your action has been forwarded to our License Fee & Accounts Receivable Branch, who will contact you separately if there is a fee issue involved.

Your action has been assigned Mail Control Number 138728.  
When calling to inquire about this action, please refer to this control number.  
You may call us on (610) 337-5398, or 337-5260.