

SAINT VINCENT HEALTH SYSTEM
232 West 25 Street
Erie, Pennsylvania 16544



May 6, 2005

MS 16

K-8

US Nuclear Regulatory Commission
Region #1
Nuclear Materials Safety Branch
475 Allendale Road
King of Prussia, PA 19406

Attention: Sandra Gabriel

RE: License #37-05125-01
Mail Control #136548

03003045

Dear Ms. Gabriel:

Attached, please find the additional information you requested regarding our radioactive materials license amendment request:

1. Please remove HDR Brachytherapy from our license.
2. Attached is a copy of the "Source Return Notification" from Nucletron Corporation verifying the receipt of the depleted source of IR-192
3. Attached, please find the survey and wipe test results required for decommissioning of the decay-in-storage area and where the HDR machine was located. These results are in dpm's.
4. Additionally, I am requesting Matthew Shebel be given permission to act as a proxy on my behalf for future correspondence.

Sincerely,

SAINT VINCENT HEALTH CENTER

C. Angela Bontempo, FACHE
President and CEO

AB/jo

136548

NMSS/RGNI MATERIALS-002

License # 37-05125-01

Mail Control # 136548



Nucletron

Nucletron Corporation
Service Department
8571 Robert Fulton Drive
Columbia, MD 21046-2133
Phone 800-338-2249
Fax (410) 312-4196
<http://www.nucletron.com>

SOURCE RETURN NOTIFICATION

Company: St. Vincents Health Center

Fax No.: 814-452-5660

Email:

Attention: Nancy Simpson

From: **Cyndie Prager**

Phone #: **410-872-4485**

Date: **04-May-2005**

Subject: **Return of Depleted Ir-192 Source**

No of pages: 1

Please be advised that AEA Technology, has received your depleted Ir-192 source # 172 on 11/10/2004.

Respectfully,

Cyndie Prager
Source Logistics
Nucletron Corporation
1-800-445-9295
410-872-4485
410-312-4196 – fax
prager@nucusa.com

CONFIDENTIALITY NOTE

The information contained in this e-mail message is intended only for the personal and confidential use of the designated recipient(s) named above. If the reader of this message is not the intended recipient, you are hereby notified that you have received this document in error, and that any review, dissemination, distribution or copying of this message is strictly prohibited. If you have received this e-mail in error, please notify Nucletron Corporation immediately by telephone at (800) 338-2249.

**Nucletron.**

Transport Drum (Barrel) Wipe Test Work Sheet

Sealed Source (Cable) Leak Test Work Sheet

 LICENSE # 37-05125-01
 MAIL CONTROL # 136548

Nucletron Corporation, Service Department, 8671 Robert Fulton Drive, Columbia, MD 21046 PH: 410-872-4400 Fax: 410-312-4198

INSTRUCTIONS FOR NUCLETRON FIELD SERVICE ENGINEER

- 1 Follow the USA Nucletron Wipe Test Work Instruction, to perform the tests and analyses described below.
- 2 After the spent source is secured within the shielded inner source shipping container (pig), collect a leak test sample of the sealed source by wiping along the source cable. Using a dry wipe pad, wipe FROM the end of the cable TOWARD the source. Do not touch the wipe to any other surface.
- 3 Collect a wipe test of 300 cm² from the exterior of the outer shipping container using a dry wipe. Wipe twice (2x) around the side of the container and twice (2x) across the top using moderate pressure.
- 4 In a low radiation background area, use the "Inspector" Survey Instrument to measure the background count rate and the count rate from each wipe. Place the wipe on the tray, centered under the detector.
- 5 If the BR exceeds 80 cpm, re-measure the background count rate.
- 6 If either wipe exceeds one-half it's limits contact the RSO.
- 7 Measure and record the maximum dose rate on the surface of the outer shipping container and the maximum dose rate at one (1) meter.

Device Serial No. and type	Source Serial No. & Type	Container S/N	Radiation Inst. S/N & Cal	Background BR	LLD = (4.66)(Sqrt B)+3+B	Source Wipe SWR	Drum Wipe DWR
9128 mHDR	172 IR182	1334 Calibrated on 14-Jul-04 Calibration due 14-Jan-05	5897	28 cpm If >80 move to lower background area	55.58 counts	18 cpm	14 cpm
Maximum dose rate (surface):		Maximum dose rate (1 meter)		Current activity:			
3.0 mR/h		0.2 mR/h		2.28 Ci			

CERTIFICATE OF TRANSPORT DRUM CONTAMINATION ANALYSIS

The Transport Drum Wipe Test was assayed for beta-gamma contamination. Title 49 CFR 173.443 limits the removable contamination for 300cm surface wipes to less than 120 Bq (0.003 Ci)(6,600 dpm) for external surfaces of packages in transportation.

If DWR is less than or equal to LLD, record "<LLD". Otherwise, Sample Activity = (DWR-BR)/E, where E is the instrument efficiency found on the calibration sticker

Sample Activity <L

FSE Signature _____

CERTIFICATE OF CABLE WIPE TEST

The Leak Test Sample was assayed for beta-gamma contamination. Title 10 CFR 35.69 limits the removable contamination from a sealed source used in brachytherapy to 200 Bq (0.005 Ci)(11,100 dpm).

If SWR is less than or equal to LLD, record "<LLD". Otherwise, Sample Activity = (SWR-BR)/E, where E is the instrument efficiency found on the calibration sticker

Sample Activity <L

FSE Signature _____

 Hospital: ST VINCENTS
 Address: RAD ONC
ERIE PA
 Contact name: _____

Note to licensee: This report should be reviewed by your
Radiation Safety Officer and filed for future reference.

Saint Vincent Health Center
 License #37-05125-01
 MAZL CONTROL # 136548

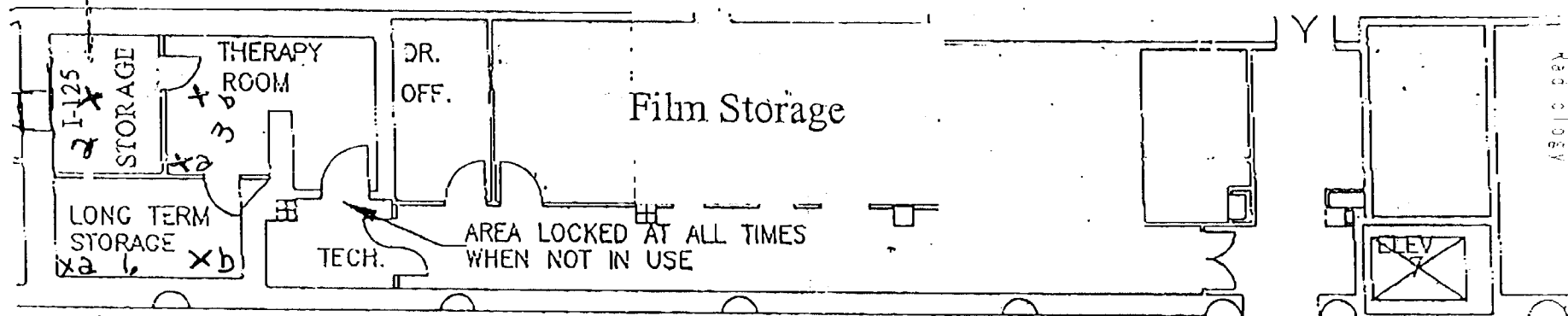

2-9-05

Bkg = 285 dpm

Wipes

1. a. 242 dpm b. 273 dpm
2. 353 dpm
3. a. 215 dpm b. 274 dpm
- 4.

Surveys

1. a. $< .02 \text{ mR/hr}$ b. $< .02 \text{ mR/hr}$
2. $< .02 \text{ mR/hr}$
3. a. $< .02 \text{ mR/hr}$ b. $< .02 \text{ mR/hr}$
- 4.