



Florida Power & Light Company, 6501 South Ocean Drive, Jensen Beach, FL 34957

December 28, 2000

L-2000-267  
10 CFR 50.90

U. S. Nuclear Regulatory Commission  
Attn: Document Control Desk  
Washington, DC 20555

RE: St. Lucie Unit 1  
Docket No. 50-335  
Proposed License Amendment  
Supplemental Information  
Personnel Airlock Open During Core Alterations

By letter L-2000-222 dated October 30, 2000, Florida Power & Light Company (FPL) requested amendment to the Facility Operating License for St. Lucie Unit 1. The proposed change would allow both containment personnel airlock (PAL) doors to be open during core alterations and movement of irradiated fuel in containment provided: (a) that at least one personnel airlock door is capable of being closed; (b) the plant is in MODE 6 with at least 23 feet of water above the fuel; and (c) a designated individual is available outside the PAL to close the door.

During a conference call on December 8, 2000, among FPL, NRC Project Management, and NRC PSA Branch reviewer, the NRC reviewer requested four items to aid him in his review and confirming calculation. The information was faxed to the NRC after the December 8, 2000 conference call.

The information requested is attached. Please contact us if there are any questions about this submittal.

Very truly yours,

Rajiv S. Kundalkar  
Vice President  
St. Lucie Plant

RSK/GRM

Attachment

cc: Regional Administrator, Region II, USNRC  
Senior Resident Inspector, USNRC, St. Lucie Plant  
Mr. William A. Passetti, Florida Department of Health and Rehabilitative Services

A001

STATE OF FLORIDA       )  
                                  )  
COUNTY OF ST. LUCIE   )       ss.

Rajiv S. Kundalkar being first duly sworn, deposes and says:

That he is Vice President, St. Lucie Plant, for the Nuclear Division of Florida Power & Light Company, the Licensee herein;

That he has executed the foregoing document; that the statements made in this document are true and correct to the best of his knowledge, information and belief, and that he is authorized to execute the document on behalf of said Licensee.

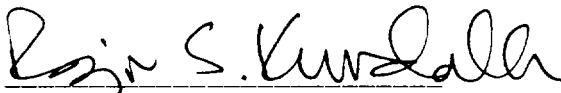
  
Rajiv S. Kundalkar

STATE OF FLORIDA  
COUNTY OF ST. LUCIE

Sworn to and subscribed before me

this 28 day of December, 2000  
by Rajiv S. Kundalkar, who is personally known to me.

  
Name of Notary Public - State of Florida

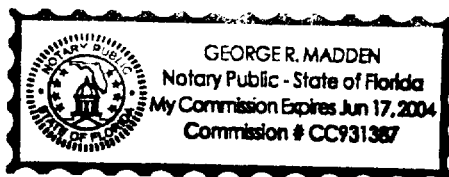

\_\_\_\_\_  
(Print, type or stamp Commissioned Name of Notary Public)

**Proposed License Amendment  
Supplemental Information  
Personnel Airlock Open During Core Alterations**

The following is prepared to provide additional information in support of a proposed license amendment to allow the containment personnel airlock (PAL) doors to remain open during core alterations. These questions were discussed during a teleconference between the NRC and FPL on December 8, 2000.

Four follow-up questions were discussed and the responses to them are as follows:

- 1) How many differential pressure (dp) gauges are there for determining differential pressure between the control room and the outside air?

FPL Response:

There are two dp gauges that are shown on the far right of the P&ID 8770-G-879. These gauges are designated as PDT 25-14A and 14B.

- 2) How are the connections made between the HVAC Duct work and components?

FPL Response:

There are both welded and bolted connections. Photos are provided as Figure 1A, 1B, and 1C to show the general arrangement of this system and its connections. These pictures show an air conditioning (A/C) unit, the pressurization filter, and charcoal filter housing. Two views of the pressurization fans and duct work. They are joined to the filter housing directly via a bolted connection.

- 3) Provide a simplified control room envelope diagram.

FPL Response:

A single line diagram showing the general arrangement of the Unit 1 control room and major HVAC components is provided as Figure 2. Additionally, Figure 3 is an excerpt from the P&ID for the system. This is plant drawing 8770-G-879, Revision 32.

- 4) Verify that no other HVAC ducts penetrate the control room envelope which could provide bypass flow.

FPL Response:

There was no other ductwork identified that is not on the P&ID or the general arrangement drawing provided in response to question 3.



**Figure 1A A/C Units & Fresh Air Filter Housing**



**Figure 1B Sideview HVE-13A and HVE-13B**



**Figure 1C Frontview HVE13A and HVE-13B**

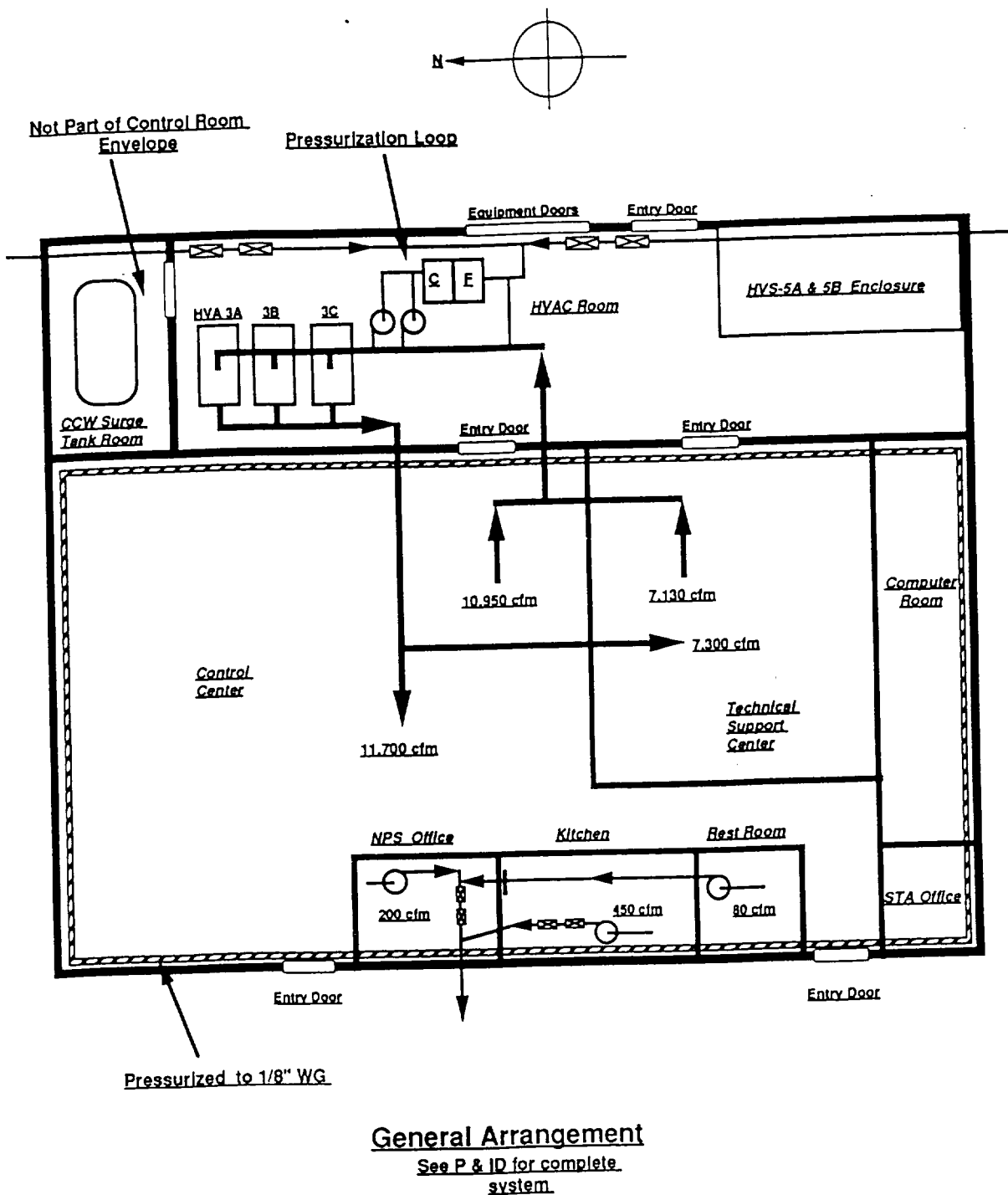

Unit 1 Control Room HVAC Layout

Figure 2

