

- NOTES:
1. FOR CIVIL ABBREVIATIONS SEE DRAWING 20005.
 2. FOR CIVIL GENERAL NOTES, LEGEND AND SYMBOLS SEE DRAWING 20006.
 3. FABRICATE MANHOLE SHAFTS WITH A MINIMUM NUMBER OF RING SECTIONS. RING SECTIONS TO BE AS LONG AS PRACTICAL.
 4. AVOID USING TOP RINGS WHENEVER POSSIBLE.
 5. EACH RING SECTION SHALL BE CLEARLY MARKED WITH THE MANHOLE NUMBER AND A NUMBER DESIGNATING INSTALLATION SEQUENCE.
 6. GROUT OR MORTAR ALL JOINTS TO FORM A WATERTIGHT MANHOLE.
 7. FIELD CUT REINFORCING AT INLET AND OUTLET PIPE OPENINGS AFTER MANHOLE IS INSTALLED, LEAVING A 1' PROTECTION INTO THE BLOCKOUT AREA.

CENTERLINE STORM DRAIN PROFILE
SCALE: HORIZONTAL 1"=50', VERTICAL 1"=10'

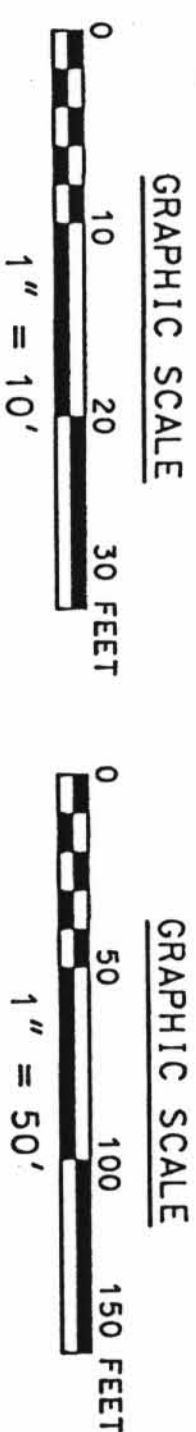
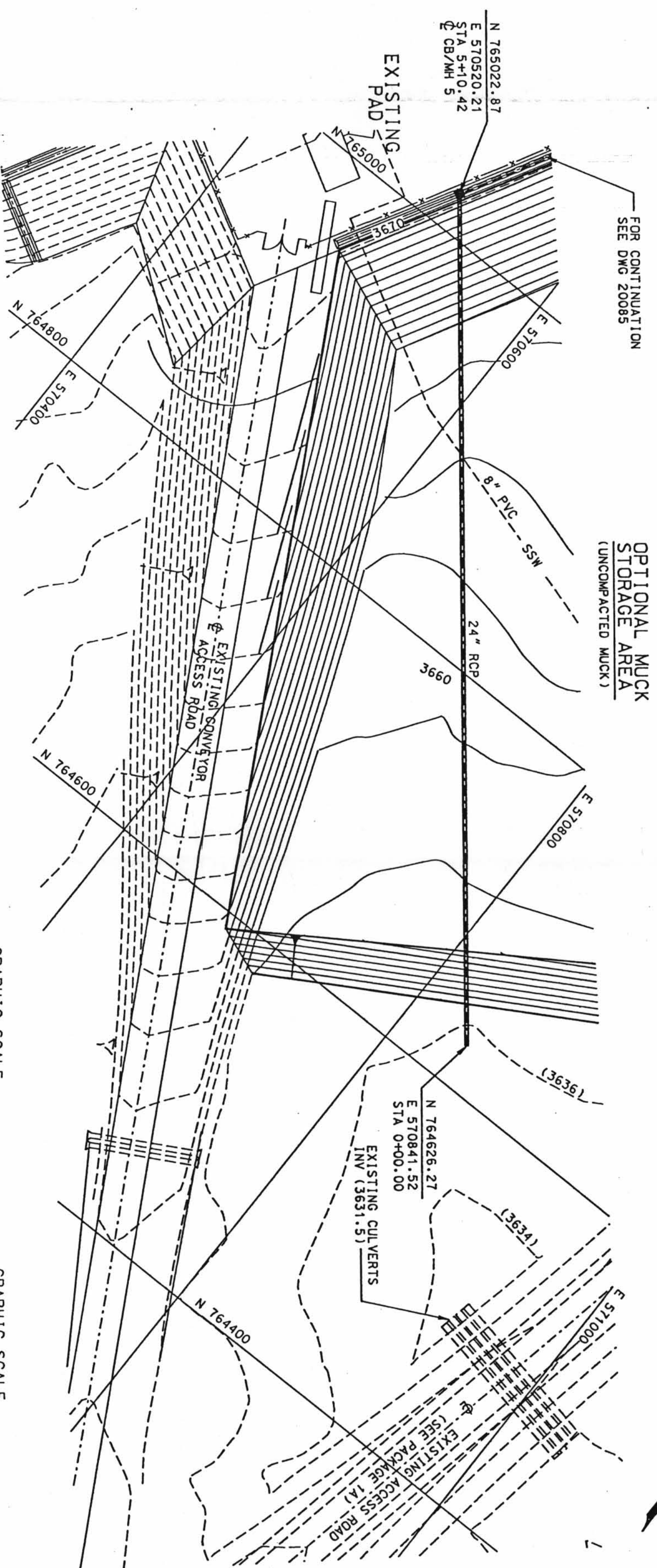

NO.	DESCRIPTION	DATE	BY	CHK	APP	REV
01	THIS DWG IS SUPERSEDED BY DWG 20085	5-15-96	HC	HC	HC	
00	ISSUED FOR CONSTRUCTION	9-26-95	DP5 HAA	ROC	VAH	FCM

DATE	BY	CHK	APP	REV
5-15-96	HC	HC	HC	
9-26-95	DP5 HAA	ROC	VAH	FCM

US DEPARTMENT OF ENERGY
MUSEC
OPTIONAL MUCK STORAGE
AREA PLAN AND PROFILE

SUPERSEDED
SEE REVISION BLOCK

ANSTEC
APERTURE
CARD

9609300050

6/3/96
EFFECTIVE DATE

DOCUMENT ABANDONED CENTER

DATE	BY	CHK	APP	REV
5-15-96	HC	HC	HC	
9-26-95	DP5 HAA	ROC	VAH	FCM

not with block dia 9/1/96

9609300050

D-14