

Delivery Order #: 091  
Purchase Order No.: DR-97-0398

APR 14 2000

Contractor: Haworth Inc.  
c/o - Price Modern of Washington (Mark Mahan)  
9700G Martin Luther King Jr. Highway  
Lanham, Maryland 20706

In accordance with Delivery Order No. DR-97-0398 dated 06/4/97 and the contractor's-proposal dated 04/06/00 (NRC4600.SIF), the contractor shall provide design, product and installation for the reconfiguration of workstations in room 7-12 of the Two White Flint North building. Delivery shall take place on June 8, 2000. The total cost for this order is as follows:

Product:	\$5,013.16
Design:	50.50
Installation:	607.50
Total:	\$5,671.16

Please contact RoseMary Mann, Contract Specialist on (301) 415-6595 If there are any questions regarding this order.

Date: \_\_\_\_\_

Robert Webber, Contracting Officer  
Contract Management Branch 1  
Division of Contracts and Property  
Management  
Office of Administration

DOCUMENT NAME: A\091

Acct R Mann J Lilley LFisher CMB1 r/f

To receive a copy of this document, indicate in the box: "C" = Copy

	ADM/DCPM/CMB1		ADM/DCPM/CMB1				
	R Mann <i>R Mann</i>		RWebber <i>RWebber</i>				
	04/13/00		04/14/00				

OFFICIAL RECORD COPY

Template=ADMO01

ADMO2

#	Mfg	Qty	Part #	Description / Options	Unit	Extended
1	HGW	1	EFN-466-B	STRAIGHT FABRIC PANEL NO-POWER 48" X 66"	828.00	828.00
					Customer	%71.72000
					234.16	234.16
			(B)	POWER BASE		
			.OF-	BASKETWEAVE	GRADE B	
			.OJX	STERLING		
			.OF-	BASKETWEAVE	GRADE B	
			.OJX	STERLING		
			.TR-	SURFACE 3		
			.00E	SMOKE		
			.TR-	SURFACE 4		
			.00E	SMOKE		
2	HGW	2	EFN-266-B	STRAIGHT FABRIC PANEL NO-POWER 24" X 66"	595.00	1190.00
					Customer	%71.72000
					168.27	338.54
			(B)	POWER BASE		
			.OF-	BASKETWEAVE	GRADE B	
			.OJX	STERLING		
			.OF-	BASKETWEAVE	GRADE B	
			.OJX	STERLING		
			.TR-	SURFACE 3		
			.00E	SMOKE		
			.TR-	SURFACE 4		
			.00E	SMOKE		
3	HGW	1	EFP-566-B	STRAIGHT FABRIC PANEL POWER 60" X 66"	1092.00	1092.00
					Customer	%71.72000
					308.82	308.82
			(B)	POWER BASE		
			.OF-	BASKETWEAVE	GRADE B	
			.OJX	STERLING		
			.OF-	BASKETWEAVE	GRADE B	
			.OJX	STERLING		
			.TR-	SURFACE 3		
			.00E	SMOKE		
			.TR-	SURFACE 4		
			.00E	SMOKE		

NRC4800.SIF

LIST\$ CUSTOMER% CUSTOMER\$

4-6-2000

NRC, TWFN, T-712, File Room 2 Add'l. Stations

12:17:00

#	Mfg	Qty	Part #	Description / Options	Unit	Extended
4	HGW	8	EFP-388-B	STRAIGHT FABRIC PANEL POWER 36" X 66"	866.00	5196.00
					Customer	%71.72000
					244.90	1469.40
			(B)	POWER BASE		
			.0F-	BASKETWEAVE	GRADE B	
			.0JX	STERLING		
			.0F-	BASKETWEAVE	GRADE B	
			.0JX	STERLING		
			.TR-	SURFACE 3		
			.00E	SMOKE		
			.TR-	SURFACE 4		
			.00E	SMOKE		
5	HGW	1	EFP-288-B	STRAIGHT FABRIC PANEL POWER 24" X 66"	723.00	723.00
					Customer	%71.72000
					204.48	204.48
			(B)	POWER BASE		
			.0F-	BASKETWEAVE	GRADE B	
			.0JX	STERLING		
			.0F-	BASKETWEAVE	GRADE B	
			.0JX	STERLING		
			.TR-	SURFACE 3		
			.00E	SMOKE		
			.TR-	SURFACE 4		
			.00E	SMOKE		
6	HGW	1	EFN-1888-B	STRAIGHT FABRIC PANEL NO-POWER 18" X 66"	588.00	588.00
					Customer	%71.72000
					180.06	180.06
			(B)	POWER BASE		
			.0F-	BASKETWEAVE	GRADE B	
			.0JX	STERLING		
			.0F-	BASKETWEAVE	GRADE B	
			.0JX	STERLING		
			.TR-	SURFACE 3		
			.00E	SMOKE		
			.TR-	SURFACE 4		
			.00E	SMOKE		
7	HGW	3	FPFC-66-B	90 DEG. FABRIC FINISH POST 66"	74.00	222.00
					Customer	%71.72000
					20.93	62.79
			(B)	POWER BASE		
			.0F-	BASKETWEAVE	GRADE B	
			.0JX	STERLING		
			.TR-	SURFACE 2		
			.00E	SMOKE		
			.TR-	SURFACE 3		
			.00E	SMOKE		

NRC4800.SIF

LIST\$ CUSTOMER% CUSTOMER\$

4-6-2000

NRC, TWFN, T-712, File Room 2 Add'l. Stations

12:17:00

#	Mfg	Qty	Part #	Description / Options	Unit	Extended
8	HGW	1	FPFS-66-B	180 DEG FABRIC FINISH POST 66"	66.00	66.00
					Customer	%71.72000
					18.66	18.66
			(B)	POWER BASE		
			.0F-	BASKETWEAVE		
			.0JX	STERLING		
			.TR-	SURFACE 2		
			.00E	SMOKE		
			.TR-	SURFACE 3		
			.00E	SMOKE		
9	HGW	1	HWSP-2429-L	WORK SURFACE SUPPORT PANEL 24"	274.00	274.00
					Customer	%71.72000
					77.49	77.49
			(L)	LEFT HAND		
			.HP-	LAMINATE		
			.03E	SMOKE		
10	HGW	1	BFM-1-B	BASE FEED MODULE, HARDWARE	145.00	145.00
					Customer	%71.72000
					41.01	41.01
			(B)	POWER BASE		
11	HGW	1	PRD-3-B	DUPLEX RECEPTACLES (BOX OF 6)	104.00	104.00
					Customer	%71.72000
					29.41	29.41
			(B)	POWER BASE		
			.TR-	SURFACE 1		
			.00E	SMOKE		
12	HGW	1	WC-6	WIRE CHANNEL 72"	16.00	16.00
					Customer	%71.72000
					4.52	4.52
			.TR-	SURFACE 1		
			.00E	SMOKE		

#	Mfg	Qty	Part #	Description / Options	Unit	Extended
13	HGW	2	WRCS-324	90 DEG. CORNER WORK SURFACE W/O KEYBOARD PAD 36" X 24"	401.00 Customer 113.40	802.00 %71.72000 226.80
			( .0H- 03E .TR- 00E .TR- 00E	STANDARD VERSION LAMINATE SMOKE SURFACE 2 SMOKE SURFACE 3 SMOKE		
14	HGW	2	WS-324	REGULAR WORK SURFACE 36" X 24"	275.00 Customer 77.77	550.00 %71.72000 155.54
			( .0H- 03E .TR- 00E .TR- 00E	W/O GROMMET LAMINATE SMOKE SURFACE 2 SMOKE SURFACE 3 SMOKE		
15	HGW	1	WS-224	REGULAR WORK SURFACE 24" X 24"	243.00 Customer 88.72	243.00 %71.72000 68.72
			( .0H- 03E .TR- 00E .TR- 00E	W/O GROMMET LAMINATE SMOKE SURFACE 2 SMOKE SURFACE 3 SMOKE		
16	HGW	1	WS-524	REGULAR WORK SURFACE 60" X 24"	357.00 Customer 100.96	357.00 %71.72000 100.96
			( .0H- 03E .TR- 00E .TR- 00E	W/O GROMMET LAMINATE SMOKE SURFACE 2 SMOKE SURFACE 3 SMOKE		

NRC4600.SIF

LIST\$ CUSTOMER% CUSTOMER\$

4-6-2000

NRC, TWEN, T-712, File Room 2 Addtl. Stations

12:17:00

#	Mfg	Qty	Part #	Description / Options	Unit	Extended
17	HGW	2	AKPT-3P	AKP - TILTING KEYBOARD PAD W/PALM REST	430.00	860.00
					Customer	%71.72000
					21.60	243.20
			.TR-00K	SURFACE 1 CHARCOAL		
18	HGW	2	PDF-24-JLN	STATIONARY PEDESTAL DRAWER 24"	678.00	1358.00
					Customer	%71.72000
					191.74	383.48
			(JLN) .TR-00E	12/12 W/LOCK SURFACE 1 SMOKE		
19	HGW	1	SR-2	REGULAR SHELF 24"	136.00	136.00
					Customer	%71.72000
					38.46	38.46
			.OV-03E .TR-00E .TR-00E	VIDENE SMOKE SURFACE 2 SMOKE SURFACE 3 SMOKE		
20	HGW	2	SR-3	REGULAR SHELF 36"	144.00	288.00
					Customer	%71.72000
					40.72	81.44
			.OV-03E .TR-00E .TR-00E	VIDENE SMOKE SURFACE 2 SMOKE SURFACE 3 SMOKE		
21	HGW	1	SR-5	REGULAR SHELF 60"	167.00	167.00
					Customer	%71.72000
					47.23	47.23
			.OV-03E .TR-00E .TR-00E	VIDENE SMOKE SURFACE 2 SMOKE SURFACE 3 SMOKE		

NRC4600.SIF

NRC, TWFN, T-712, File Room 2 Add'l. Stations

LIST\$ CUSTOMER% CUSTOMER\$

4-6-2000

12:17:00

#	Mfg	Qty	Part #	Description / Options	Unit	Extended
22	HGW	1	FDRV-2	REG. FLIPPER DOOR - VIDENE 24"	252.00	252.00
					Customer	%71.72000
					71.27	71.27
			( ,HC- 03E ,TR- 00E ,TR- 00E	WITH LOCK HIGH PRESSURE LAMINATE SMOKE SURFACE 2 SMOKE SURFACE 3 SMOKE		
23	HGW	2	FDRV-3	REG. FLIPPER DOOR - VIDENE 36"	280.00	560.00
					Customer	%71.72000
					79.18	158.36
			( ,HC- 03E ,TR- 00E ,TR- 00E	WITH LOCK HIGH PRESSURE LAMINATE SMOKE SURFACE 2 SMOKE SURFACE 3 SMOKE		
24	HGW	1	FDRV-5	REG. FLIPPER DOOR - VIDENE 60"	368.00	368.00
					Customer	%71.72000
					104.07	104.07
			( ,HC- 03E ,TR- 00E ,TR- 00E	WITH LOCK HIGH PRESSURE LAMINATE SMOKE SURFACE 2 SMOKE SURFACE 3 SMOKE		
25	HGP	1	HTL-0024	TASK LIGHT 24"	170.00	170.00
					Customer	%71.72000
					48.08	48.08
			( ,TR- 00E	STANDARD VERSION SURFACE 1 SMOKE		
26	HGW	2	HTL-0036-T	TASK LIGHT 36"	187.00	374.00
					Customer	%71.72000
					52.88	105.76
			(T) ,TR- 00E	T-8 OCTIC SURFACE 1 SMOKE		

NRC4600.SIF

LISTS CUSTOMER% CUSTOMERS

NRC, TWFN, T-712, File Room 2 Add'l. Stations

4-6-2000

12:17:01

#	Mfg	Qty	Part #	Description / Options	Unit	Extended
27	HGW	1	HTL-0060-T	TASK LIGHT 60"	212.00	212.00
					Customer	%71.72000
					59.95	59.95
			(T) TR- 00E	T-8 OCTIC SURFACE 1 SMOKE		
28	HGW	1	HTB-2416	TACKBOARD 24" X 16"	138.00	138.00
					Customer	%71.72000
					39.03	39.03
			FE- OCW	ESSENTIEL AQUA	GRADE A	
29	HGW	2	HTB-3616	TACKBOARD 36" X 16"	145.00	290.00
					Customer	%71.72000
					41.01	82.02
			FE- OCW	ESSENTIEL AQUA	GRADE A	
30	HGW	1	HTB-6016	TACKBOARD 60" X 16"	182.00	182.00
					Customer	%71.72000
					51.47	51.47
			FE- OCW	ESSENTIEL AQUA	GRADE A	

## Totals

List 17727.00

Customer 5013.16

Customer% 71.72020



A  $90^{\circ} \times 61^{\circ}$   
B  $24^{\circ} \times 67^{\circ}$   
C  $60^{\circ} \times 67^{\circ}$   
D  $36^{\circ} \times 67^{\circ}$   
E  $36^{\circ} \times 67^{\circ}$   
F  $36^{\circ} \times 67^{\circ}$

3/15/00 Agree with Liepant.

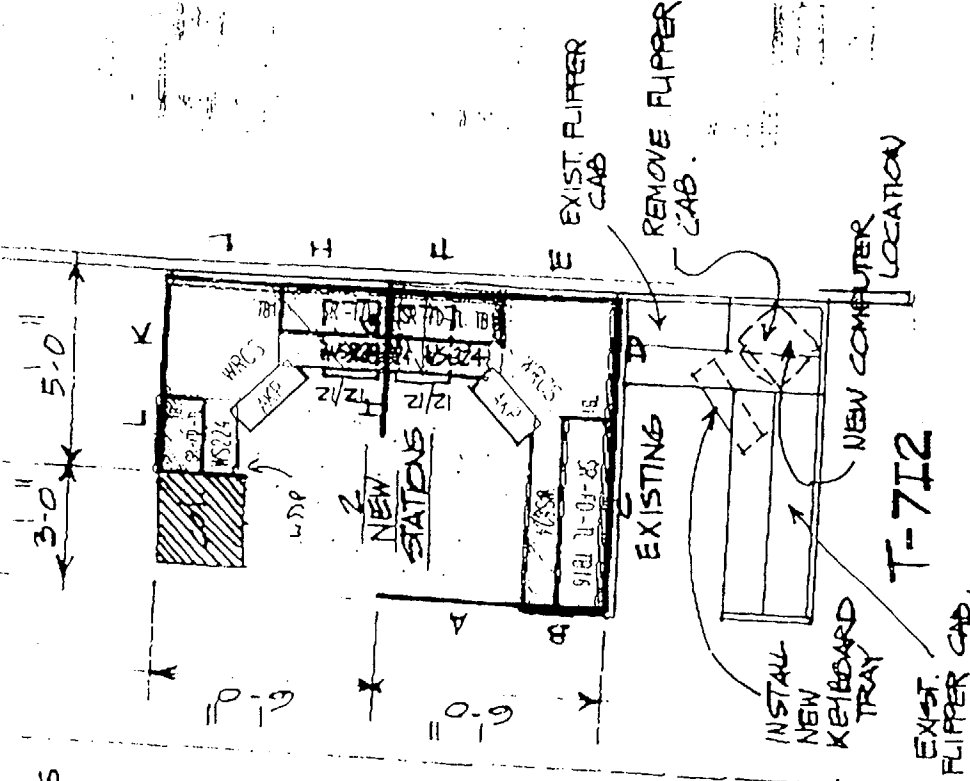

2- NEW WORKSTATION LAYOUT  
FOR CENTRIEVER FILE RM T-712

PREP BY: VLB/ADM/DFS/FACB 3/2/00